

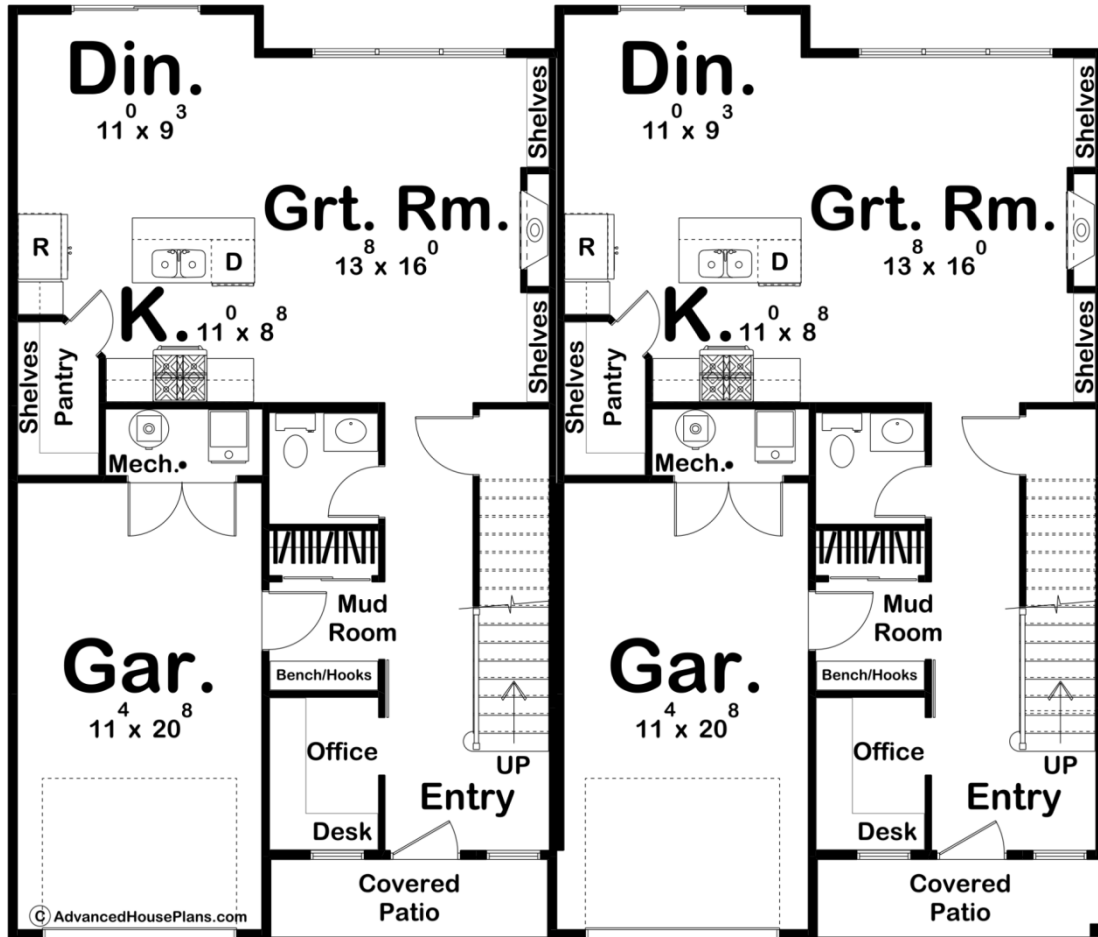

**30314 - Wood Valley Data Sheet**

1711 SQ FT	3 BEDS	3 BATHS	1 BAYS	50' 8" WIDE	43' 0" DEEP
---------------	-----------	------------	-----------	----------------	----------------

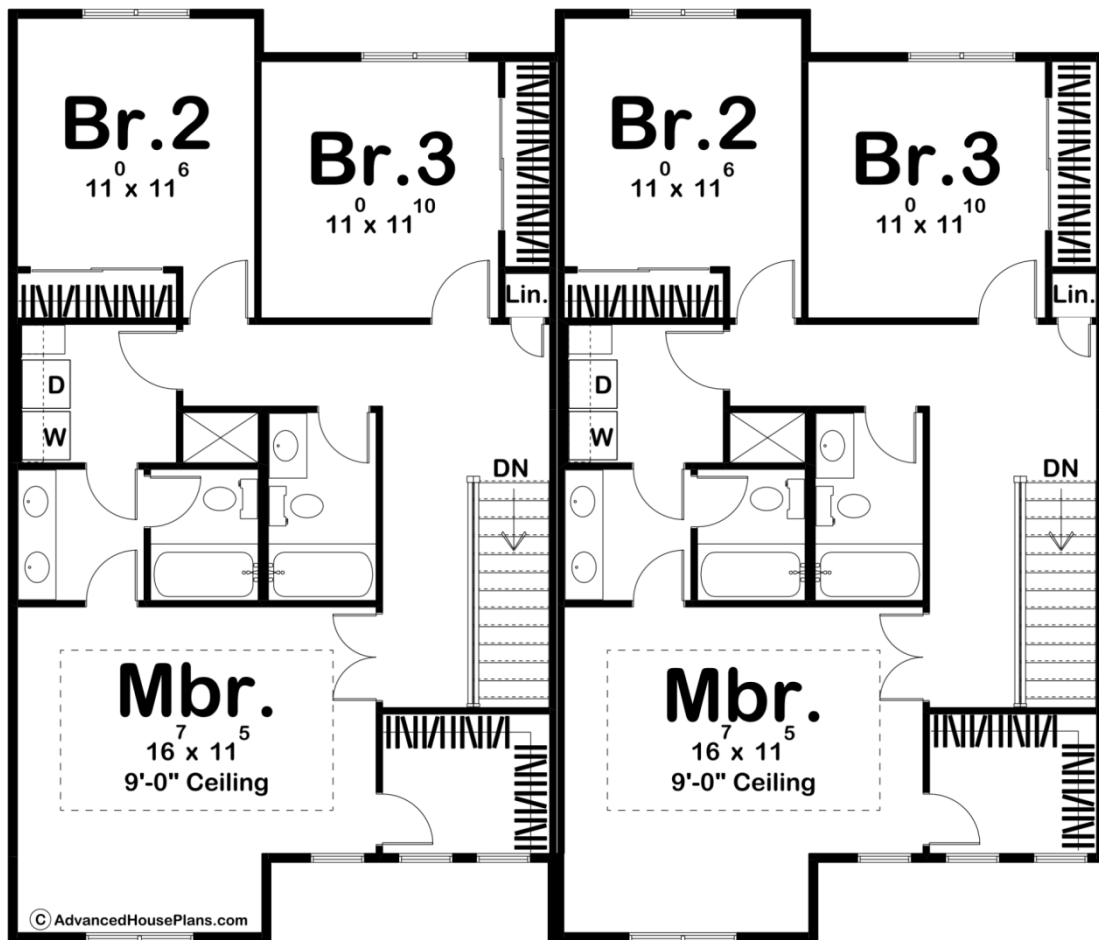



## Construction Specs

### Layout

Bedrooms	3
Bathrooms	3
Garage Bays	1

### Square Footage

Main Level	744 Sq. Ft.
Second Level	967 Sq. Ft.
Covered Area	49 Sq. Ft.
Garage	247 Sq. Ft.
Total Finished Area	1711 Sq. Ft.

### Exterior Dimensions

Width	50' 8"
Depth	43' 0"

### Default Construction Stats

*Stats are unique to the individual plan.*

Foundation Type	Slab
Exterior Wall Construction	2x4
Roof Pitches	Primary 6/12, Secondary 10/12
Main Wall Height	9'
Second Wall Height	8'

## Plan Description

Our Wood Valley plans is a duplex of our Fleetwood plan. It is a gorgeous modern farmhouse plan with 1711 square feet, 3 bedrooms, and 3 bathrooms. The exterior of this home with board and batten siding, wood accents, metal roofing, and dark windows gives this plan a traditional modern farmhouse feel with uniqueness still throughout. Walking in through the front door just under the covered patio walks you straight into a gorgeous entryway, met with a lovely staircase on the right or office space with a built-in desk on the left. A mudroom with access to the 1-car garage can also be found here, also including a built-in bench with hooks for coats and bags. Continuing throughout the house is when you will find a powder bath, just before stepping into a spacious open concept room, containing the great room with built-in shelving and a fireplace, a dining room, and a kitchen with a walk-in pantry and large kitchen island. Heading upstairs is where all of the bedrooms can be found. The master is complete with a 9' ceiling, walk-in closet, private Hollywood bath with a double vanity, and access to the laundry room. Bedrooms 2 and 3 can also be found here, which share a hallway bath.