

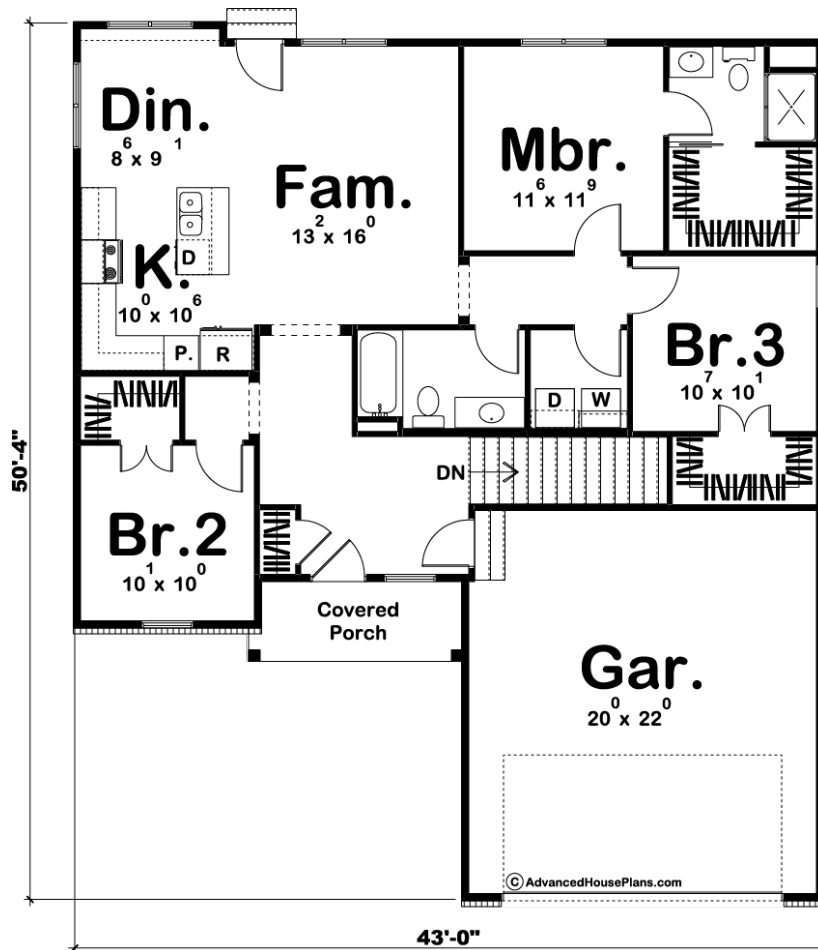

29259 - Willett Data Sheet

1290 SQ FT	3 BEDS	2 BATHS	2 BAYS	43' 0" WIDE	50' 4" DEEP
---------------	-----------	------------	-----------	----------------	----------------



Construction Specs

Layout

Bedrooms

Bathrooms	2
Garage Bays	2

Square Footage

Main Level	1290 Sq. Ft.
Garage	459 Sq. Ft.
Total Finished Area	1290 Sq. Ft.

Exterior Dimensions

Width	43' 0"
Depth	50' 4"
Ridge Height <i>Calculated from main floor line</i>	22'

Default Construction Stats

Stats are unique to the individual plan.

Foundation Type	Basement
Exterior Wall Construction	2x4
Roof Pitches	10/12 S-S 7/12 F-B
Foundation Wall Height	9'
Main Wall Height	9'

Plan Description

A shed dormer above a quaint covered front porch, giving this 1290 sq. ft., 1-story house plan an undeniable sense of country charm. Once inside, welcoming views of an oversized entry not typically found in this size of a home. The kitchen boasts ample counter space, island work area with a breakfast bar and a walk-up pantry. The master suite is privately situated from the hustle and bustle of the home. Its private bath area includes a walk-in closet. Bedrooms 2 and 3 also feature walk-in closets. Check out our other small house plans! As always any Advanced House Plans home plan can be customized to fit your needs with our alteration department. Whether you need to add another garage stall, change the front elevation, stretch the home larger or just make the home plan more affordable for your budget we can do that and more for you at Ahp.