

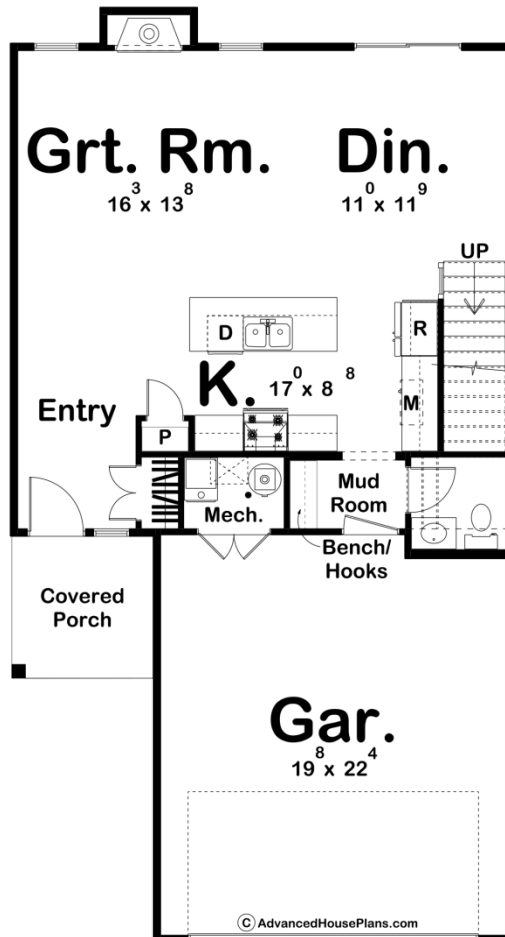

30243 - Whitehurst Data Sheet

1587 SQ FT	3 BEDS	3 BATHS	2 BAYS	28' 0" WIDE	52' 0" DEEP
---------------	-----------	------------	-----------	----------------	----------------

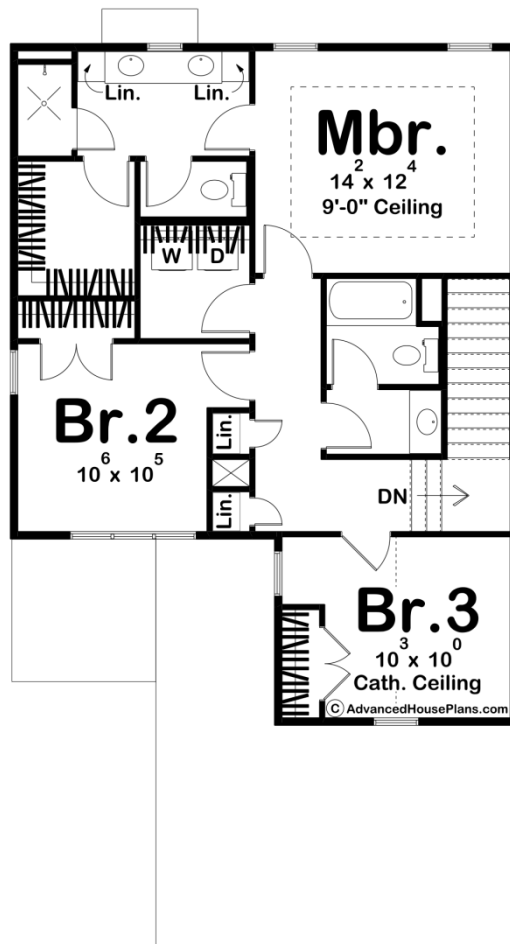



Construction Specs

Layout

Bedrooms	3
Bathrooms	3
Garage Bays	2

Square Footage

Main Level	749 Sq. Ft.
Second Level	838 Sq. Ft.
Covered Area	64 Sq. Ft.
Garage	445 Sq. Ft.
Total Finished Area	1587 Sq. Ft.

Exterior Dimensions

Width	28' 0"
Depth	52' 0"

Default Construction Stats

Stats are unique to the individual plan.

Foundation Type	Slab
Exterior Wall Construction	2x4
Roof Pitches	Primary 12/12, Secondary 4/12
Main Wall Height	9'
Second Wall Height	8'

Plan Description

The Whitehurst plan is a gorgeous modern farmhouse style plan that is complete with 1587 square feet, 3 bedrooms, and 3 bathrooms. The board and batten siding of this home with the wood accents makes it a unique yet trendy modern farmhouse with all the proper touches. The covered porch heading into the entryway is a beautiful stoop to head into an even more beautiful interior. The great room, dining, and kitchen are all found here with an open concept, built-in fireplace, island, and plenty of counter space. The mudroom and powder bath near the entrance of the two-car garage can also be found here. Head upstairs to find the bedrooms, the master complete with a double vanity, separate shower and toilet areas and a large walk-in closet, the laundry room, and bedrooms two and three which share a Hollywood bathroom. Love this plan, check out our Ridgehaven plan, #30238.