

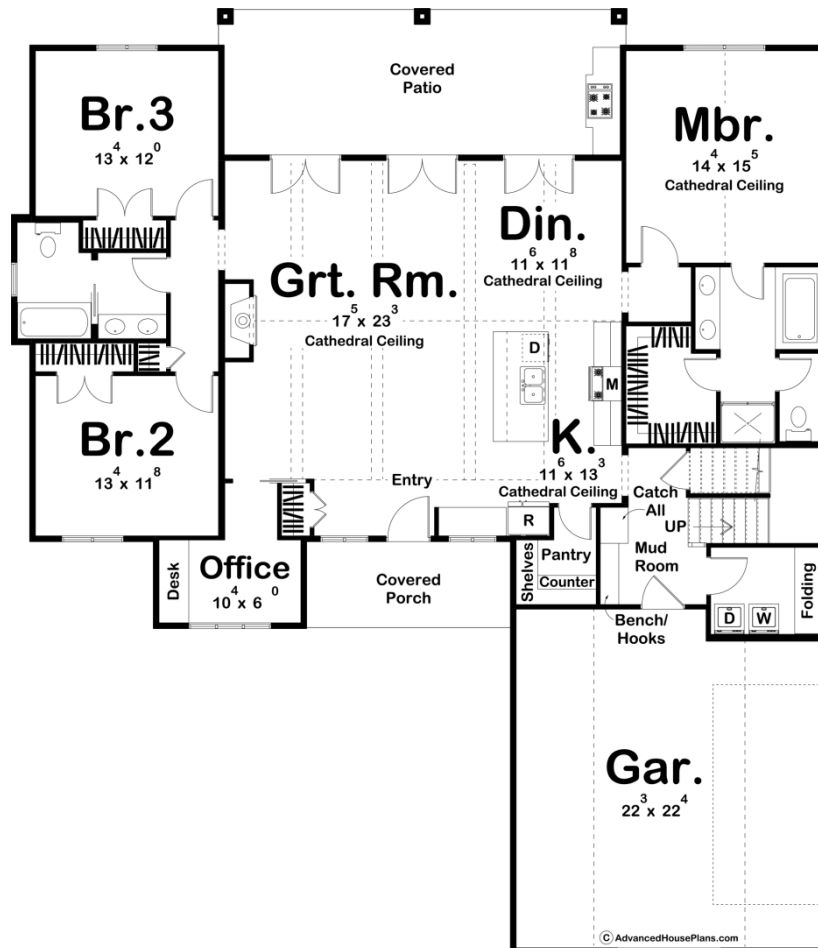

**29878 - Weidenfeld Data Sheet**

2075 SQ FT	3 BEDS	2 BATHS	2 BAYS	60' 0" WIDE	69' 0" DEEP
---------------	-----------	------------	-----------	----------------	----------------

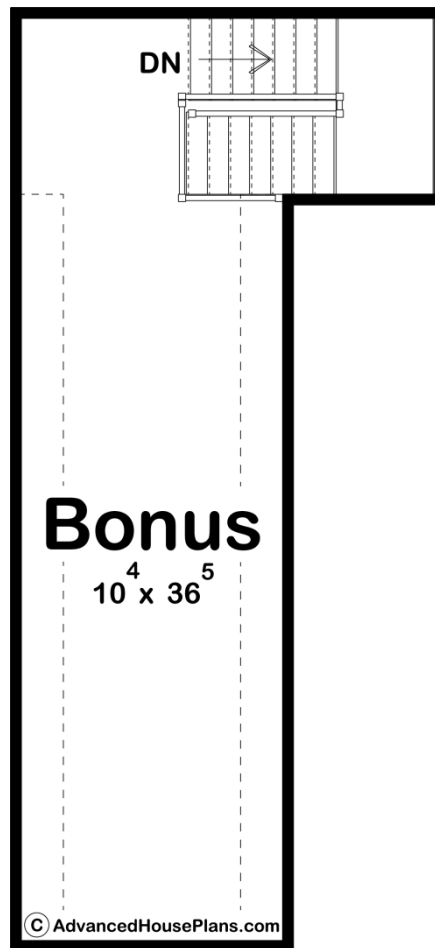



## Construction Specs

### Layout

Bedrooms	3
Bathrooms	2
Garage Bays	2

### Square Footage

Main Level	2075 Sq. Ft.
Garage	560 Sq. Ft.
Total Finished Area	2075 Sq. Ft.

### Exterior Dimensions

Width	60' 0"
Depth	69' 0"

### Default Construction Stats

*Stats are unique to the individual plan.*

Foundation Type	Slab
Exterior Wall Construction	2x4

Roof Pitches	10/12 Primary, 12/12 4/12 Secondary
Main Wall Height	9'
Second Wall Height	8'

## Plan Description

The Weidenfeld plan merges the classic farmhouse style with modern elements to create the Modern Farmhouse style. On the inside, you'll walk into the great room that is warmed by a fireplace. The great room, kitchen, and dining room lie under a soaring cathedral ceiling with exposed beams. The great room opens up to the covered patio through 3 sets of french doors. The home's kitchen includes a large island and a walk-in pantry. The master includes a soaking tub, his/her vanities, an enclosed toilet area, and a walk-in closet. On the opposite side of the home, 2 bedrooms share a centrally located hall bathroom. A bonus area above the garage adds 384 sq ft.