

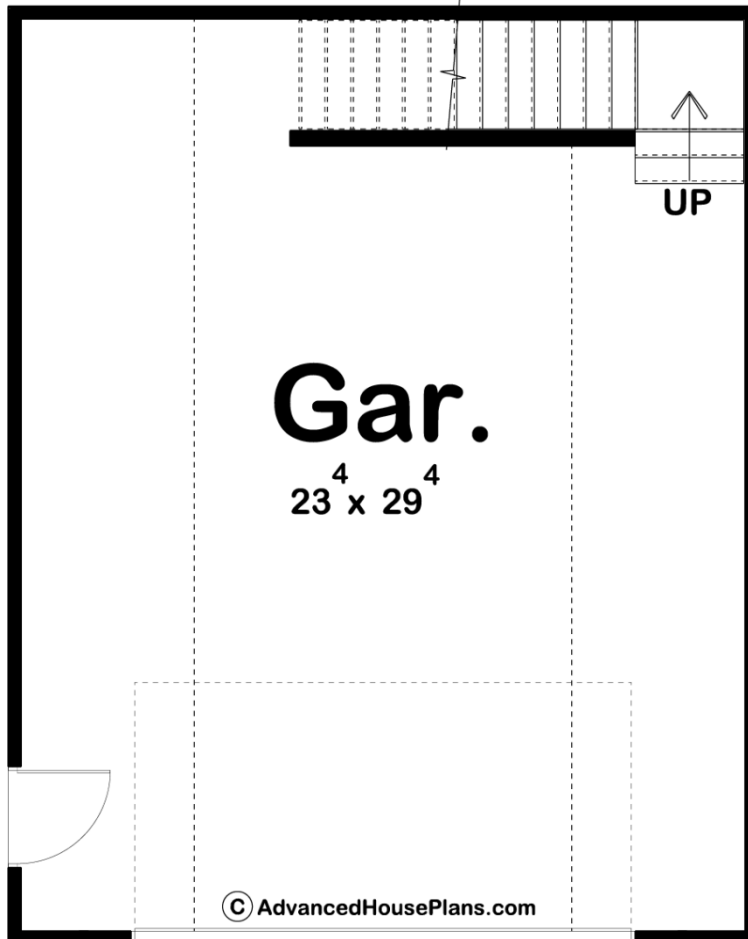

30027 - Vivian Data Sheet

| | | | | | |
|------------|-----------|------------|-----------|----------------|----------------|
| 0 SQ FT | 0 BEDS | 0 BATHS | 2 BAYS | 24' 0" WIDE | 30' 0" DEEP |
|------------|-----------|------------|-----------|----------------|----------------|

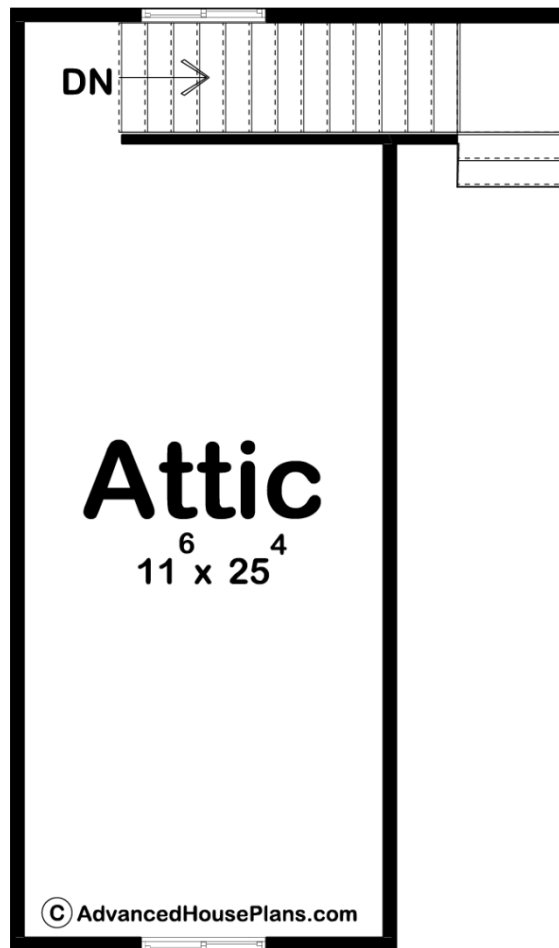



Construction Specs

Layout

Garage Bays 2

Square Footage

Garage 720 Sq. Ft.

Exterior Dimensions

Width 24' 0"

Depth 30' 0"

Default Construction Stats

Stats are unique to the individual plan.

Foundation Type Slab

Exterior Wall Construction 2x4

Roof Pitches 10/12 Primary

Main Wall Height 10'

Second Wall Height 7'

Plan Description

▪

This is a traditional style garage plan built on a slab foundation. The floor plan has ample room for 2 cars or would work as a stand-alone workshop. A person door is located on the side for easy access. The Vivian also includes an attic space above with windows in each gable to allow for natural light and fresh air. This is the ultimate garage/workshop/storage building.