

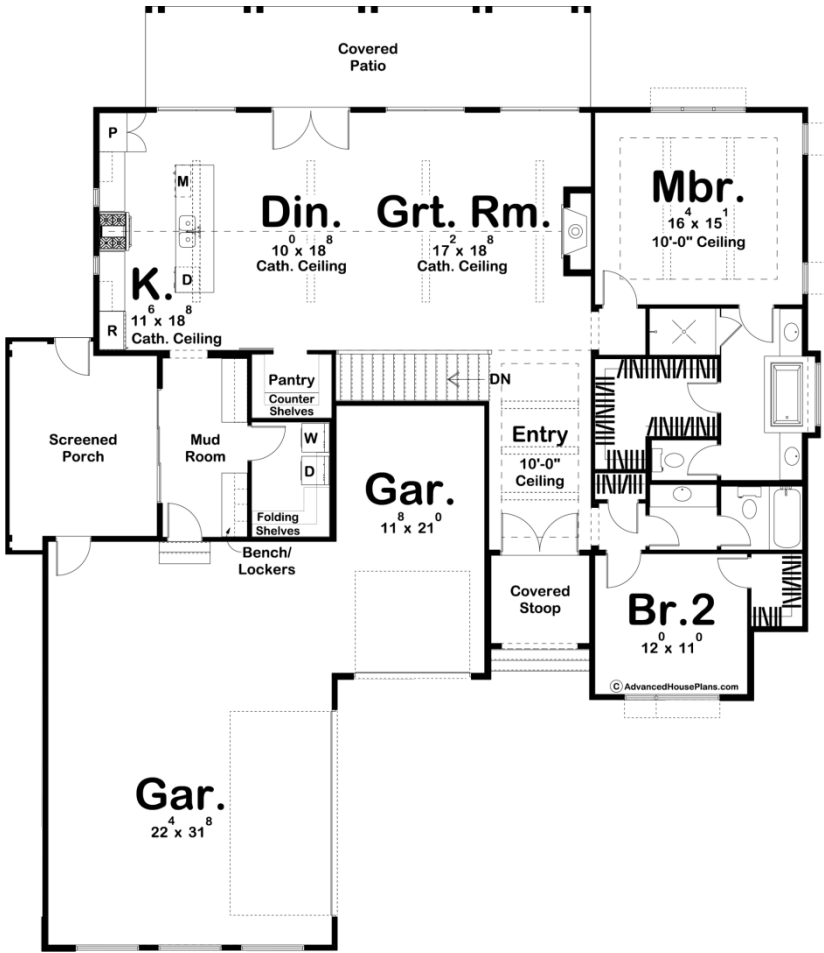

30130 - Ventura Data Sheet

1902 SQ FT	2 BEDS	2 BATHS	3 BAYS	64' 0" WIDE	74' 0" DEEP
---------------	-----------	------------	-----------	----------------	----------------



Construction Specs

Layout

Bedrooms

Bathrooms	2
Garage Bays	3
Square Footage	
Main Level	1902 Sq. Ft.
Covered Area	546 Sq. Ft.
Garage	992 Sq. Ft.
Total Finished Area	1902 Sq. Ft.
Exterior Dimensions	
Width	64' 0"
Depth	74' 0"
Ridge Height <i>Calculated from main floor line</i>	27'
Default Construction Stats <i>Stats are unique to the individual plan.</i>	
Foundation Type	Basement
Exterior Wall Construction	2x4
Roof Pitches	8/12 Primary, 4/12 Secondary
Foundation Wall Height	9'
Main Wall Height	9'

Plan Description

This beautifully configured Modern House plan offers amenities that are usually found in much larger home designs. On the outside, dark gray siding with wood accents and a covered porch put on a striking display of curb appeal. Just inside, you'll be amazed at the open floor plan including a magnificent great room, which is warmed by a fireplace and flows into a dining room and large kitchen. The kitchen boasts plenty of counter space in addition to the spacious island. Just beyond the dining area, a covered patio extends entertaining options. The master suite enjoys a luxurious bath, complete with compartmented toilet, walk-in shower, dual vanities, and a large walk-in closet. On the other side of this house plan, the large 3 car garage accesses the home through a convenient mud room complete with a bench, lockers, and a catch-all.