

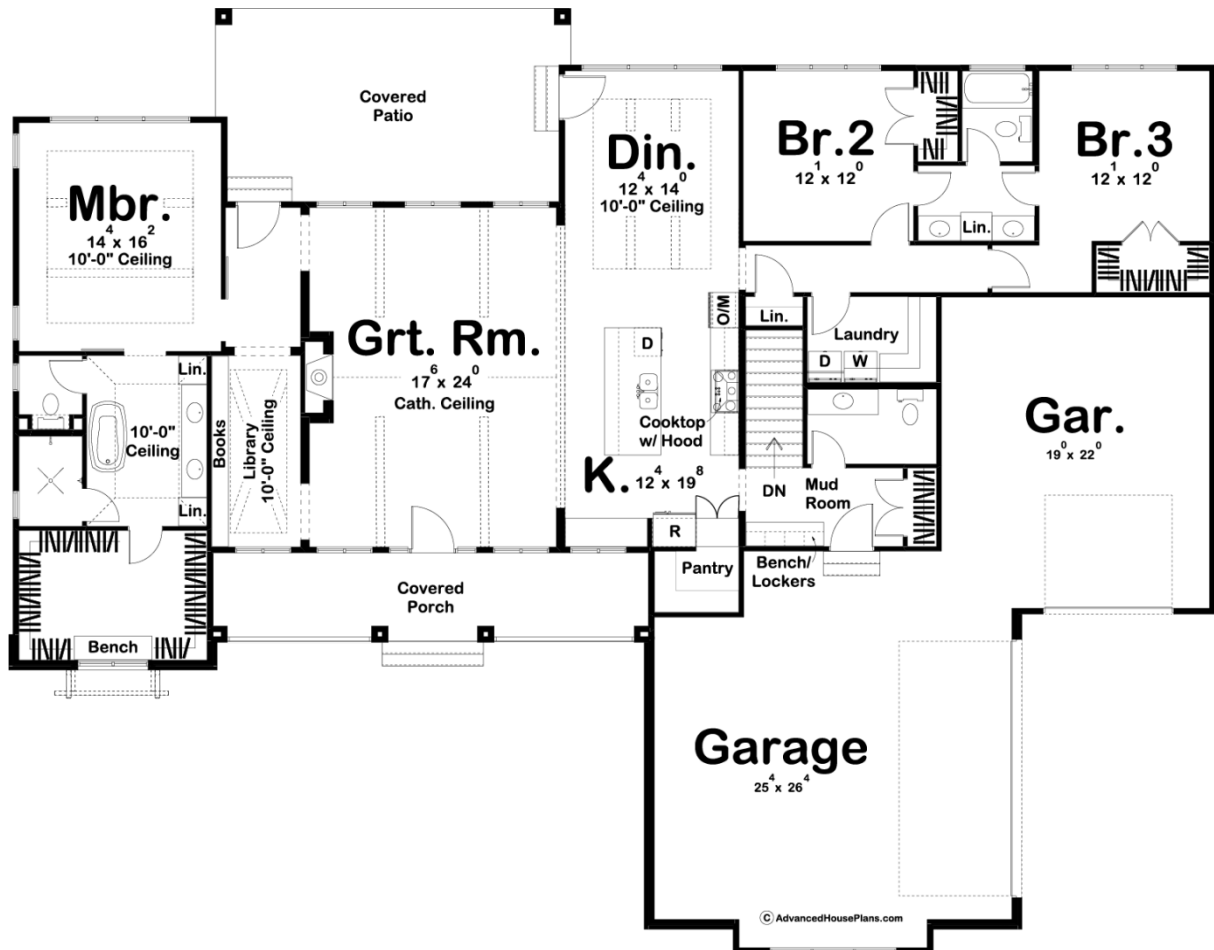

**29723 - Vandyke Data Sheet**

2400 SQ FT	3 BEDS	3 BATHS	3 BAYS	85' 0" WIDE	67' 0" DEEP
---------------	-----------	------------	-----------	----------------	----------------



**Construction Specs**

Layout

Bedrooms

Bathrooms	3
-----------	---

Garage Bays	3
-------------	---

### Square Footage

Main Level	2400 Sq. Ft.
------------	--------------

Garage	1121 Sq. Ft.
--------	--------------

Total Finished Area	2400 Sq. Ft.
---------------------	--------------

### Exterior Dimensions

Width	85' 0"
-------	--------

Depth	67' 0"
-------	--------

### Default Construction Stats

*Stats are unique to the individual plan.*

Foundation Type	Basement
-----------------	----------

Exterior Wall Construction	2x4
----------------------------	-----

Roof Pitches	12/12 Primary, 4/12 Secondary
--------------	-------------------------------

Foundation Wall Height	9'
------------------------	----

Main Wall Height	9'
------------------	----

## Plan Description

This Modern Farmhouse ranch mixes textures including board and batten siding, white brick, and metal roofing. Inside, immediate impressions are made by a soaring wood-beamed cathedral ceiling in the great room. The great room is warmed by a beautiful fireplace. Just off the great room, you will find an amazing library with exposed wood beams. The kitchen, with an expansive work island and a walk-in pantry, is open to the dining area that includes wood beams. Away from the living areas, the main floor's master suite features a large walk-in closet with a built-in bench, and his and her vanities in the bath. On the other side of the home, bedrooms 2 and 3 share a Jack-n-Jill bath and each has its own walk-in closet. The generously proportioned 3-car garage includes ample space. It accesses the home through a mudroom, complete with bench, lockers and a coat closet.