

ADVANCED
HOUSE PLANS

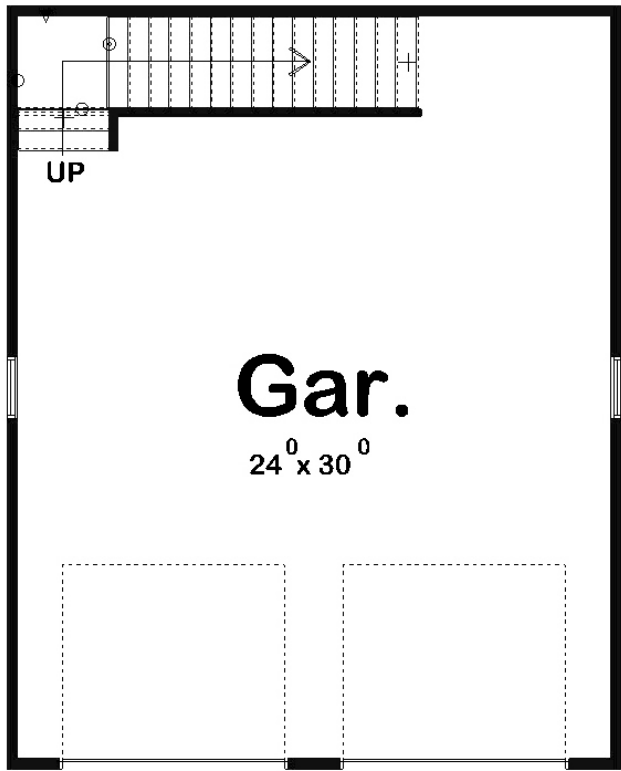

29013 - Thayer Data Sheet

0 SQ FT	0 BEDS	0 BATHS	2 BAYS	24' 8" WIDE	25' 8" DEEP
------------	-----------	------------	-----------	----------------	----------------



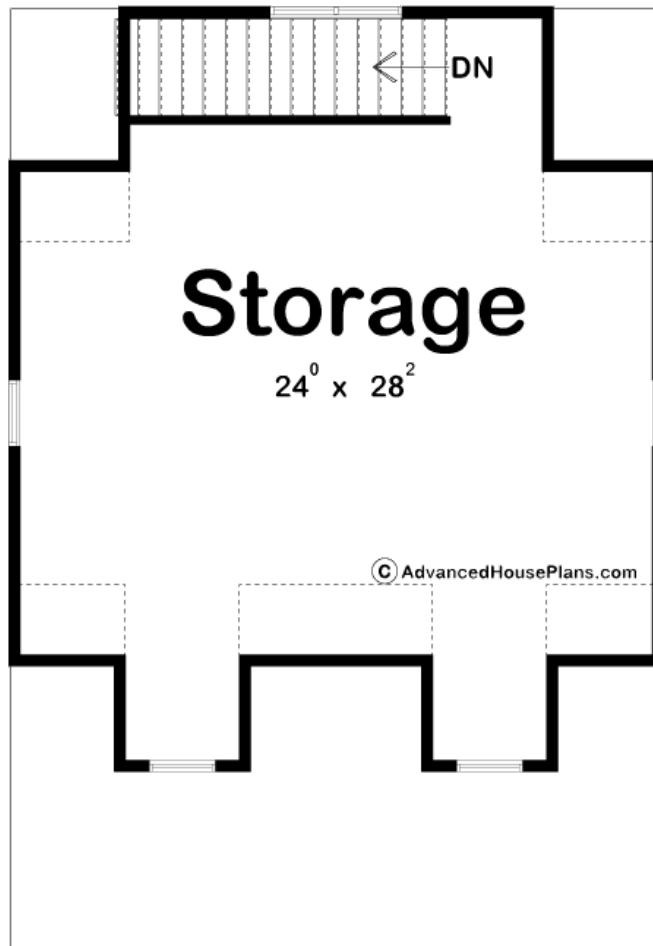

Construction Specs

Layout

Garage Bays 2

Square Footage

Garage 756 Sq. Ft.

Exterior Dimensions

Width 24' 8"

Depth 25' 8"

Ridge Height 28'
Calculated from main floor line

Default Construction Stats

Stats are unique to the individual plan.

Foundation Type Slab

Exterior Wall Construction 2x4

Roof Pitches 12/12 Primary

Main Wall Height 9'

Plan Description

Thayer is a 2 story traditional garage built on slab foundation. There is a side entrance a lots of storage space in the loft above, accessible by stairs. The garage doors are 9'x8'.