

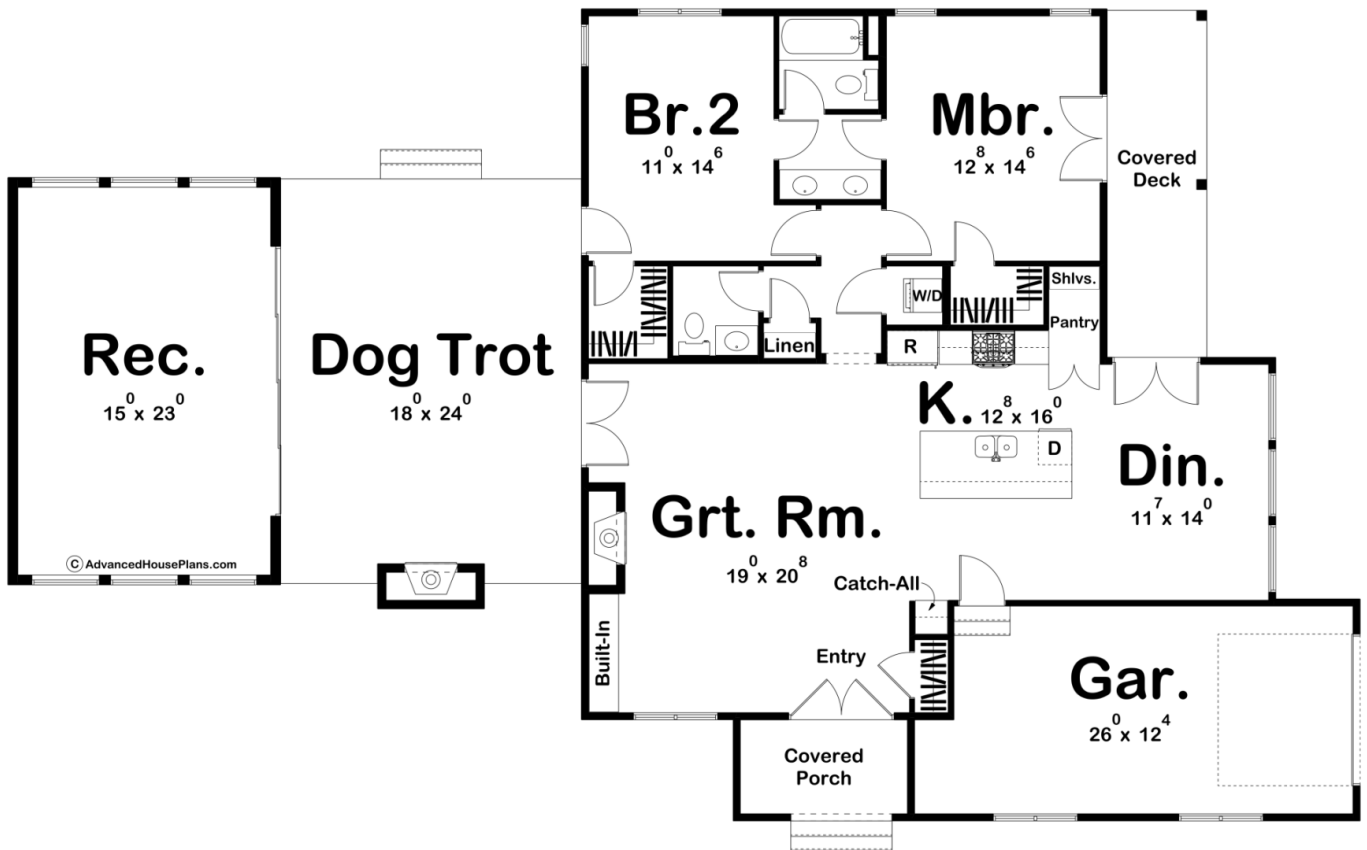

30185 - Stoney Hill Data Sheet

1773 SQ FT	2 BEDS	2 BATHS	1 BAYS	80' 0" WIDE	48' 0" DEEP
---------------	-----------	------------	-----------	----------------	----------------



Construction Specs

Layout

Bedrooms

Bathrooms	2
Garage Bays	1

Square Footage

Main Level	1773 Sq. Ft.
Covered Area	618 Sq. Ft.
Garage	323 Sq. Ft.
Total Finished Area	1773 Sq. Ft.

Exterior Dimensions

Width	80' 0"
Depth	48' 0"
Ridge Height <i>Calculated from main floor line</i>	26' 0"

Default Construction Stats

Stats are unique to the individual plan.

Foundation Type	Crawlspace
Exterior Wall Construction	2x4
Roof Pitches	10/12 Primary, 6/12 Secondary
Main Wall Height	9'

Plan Description

The Stoney Hill plan is a beautiful lake house that has some unique features. The outdoor entertainment options are enhanced by a large "Dogtrot" area. A dogtrot acts a covered breezeway between 2 parts of the home. In this home it separates the main living area from the rec room and features a wonderful stone outdoor fireplace. The exterior of the home features a blend of siding types. A gray shake siding combines with a red lap siding to give the home excellent curb appeal. Inside the main living area of the home, the great room, kitchen, and dining are arranged in an open floor plan. The great room is warmed by a fireplace that features built-in bookshelves. The kitchen includes a large island with a snack bar and a walk-in pantry. Both bedrooms share access to a Jack and Jill bathroom and have their own walk-in closets. The master bedroom accesses the covered deck through a set of French doors.