

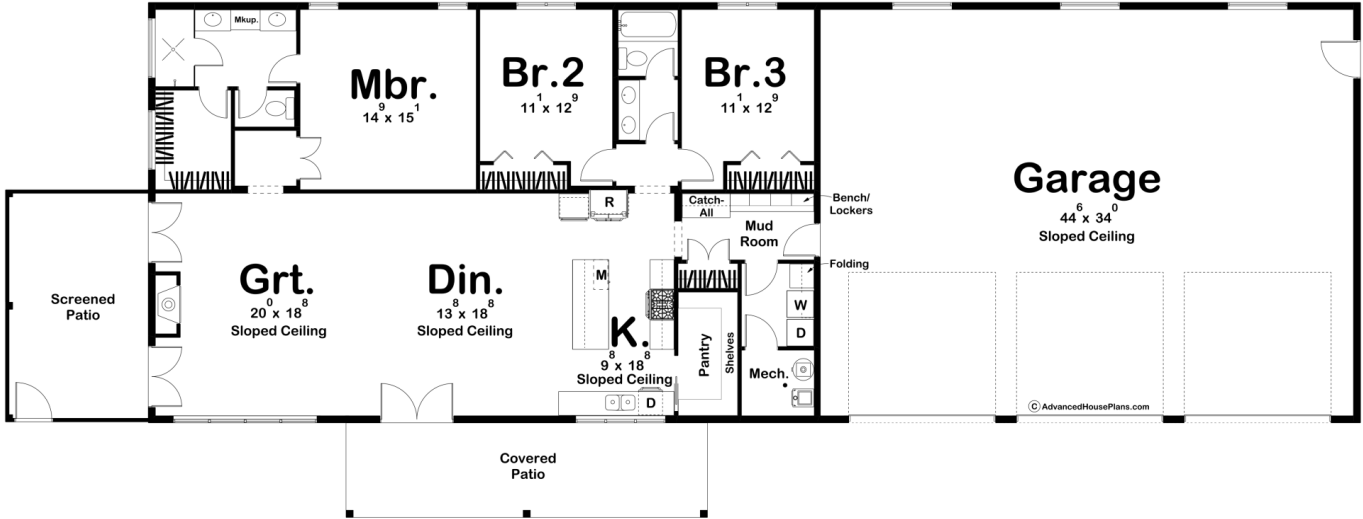

30300 - Shreveport Data Sheet

| | | | | | |
|---------------|-----------|------------|-----------|-----------------|----------------|
| 1927 SQ FT | 3 BEDS | 2 BATHS | 3 BAYS | 113' 0" WIDE | 43' 0" DEEP |
|---------------|-----------|------------|-----------|-----------------|----------------|



Construction Specs

| |
|--------|
| Layout |
|--------|

Bedrooms

| | |
|--|------------------------------|
| Bathrooms | 2 |
| Garage Bays | 3 |
| Square Footage | |
| Main Level | 1927 Sq. Ft. |
| Covered Area | 474 Sq. Ft. |
| Garage | 1575 Sq. Ft. |
| Total Finished Area | 1927 Sq. Ft. |
| Exterior Dimensions | |
| Width | 113' 0" |
| Depth | 43' 0" |
| Default Construction Stats <i>Stats are unique to the individual plan.</i> | |
| Foundation Type | Slab |
| Exterior Wall Construction | 2x6 |
| Roof Pitches | Primary 2/12, Secondary 4/12 |
| Main Wall Height | 12' |

Plan Description

This modern barndominium has a touch that makes the home not only feel luxurious, but also comfortable. As soon as you step in through the large three car garage, you're greeted by a beautiful mudroom and a great open space for gathering with the family. The kitchen features a walk-in pantry and a wide space with a view straight to the great room, leaving no guest unnoticed. There are three bedrooms in the Shreveport plan. Two share a hall bath, and the other with a large double vanity, walk-in shower, and walk-in closet. Step outside onto the screened patio for more entertaining and relaxing space. This barndominium is unlike any other.