

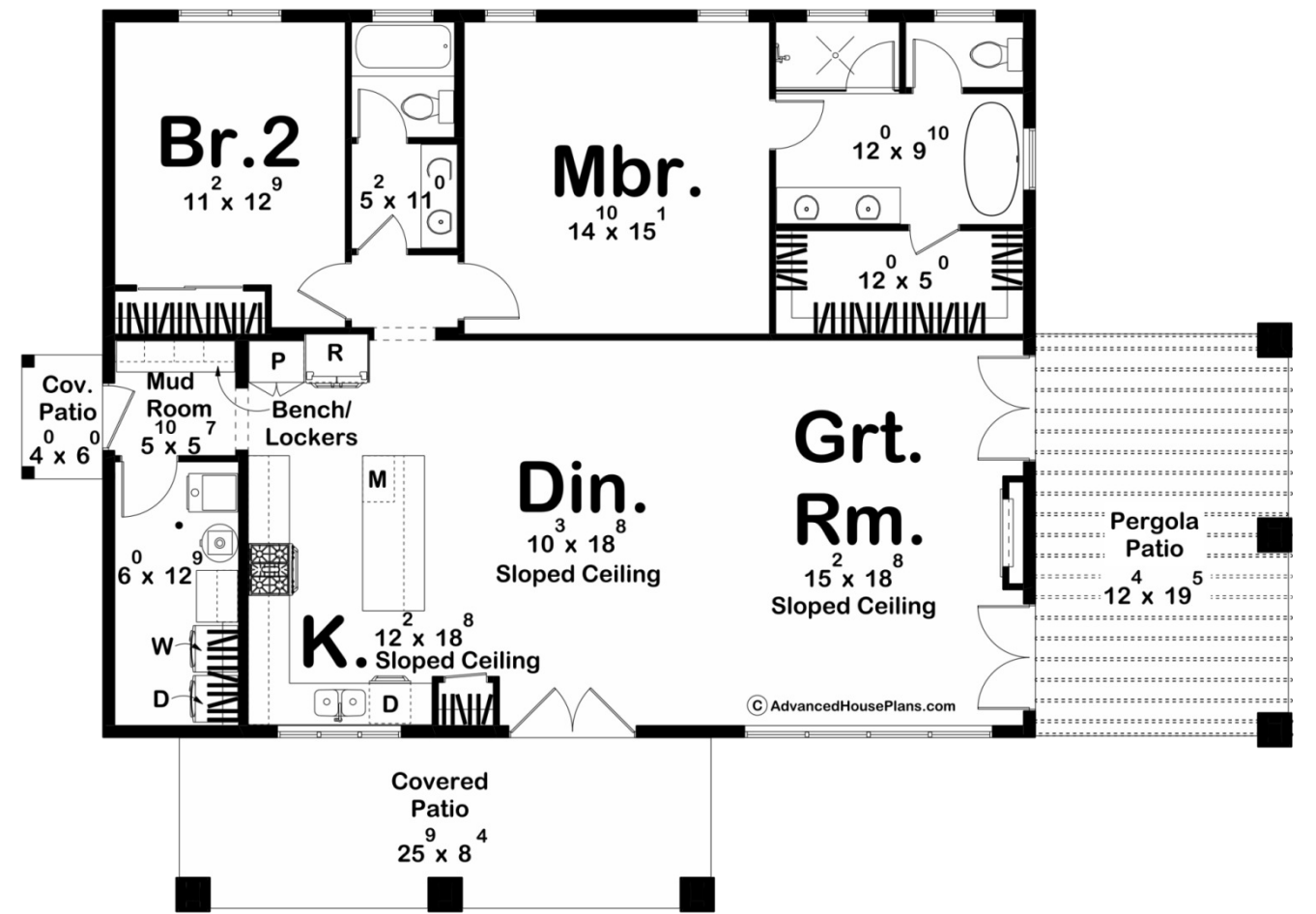

30329 - Rock Creek Data Sheet

1575 SQ FT	2 BEDS	2 BATHS	0 BAYS	61' 4" WIDE	43' 4" DEEP
---------------	-----------	------------	-----------	----------------	----------------



Construction Specs

Layout

Square Footage

Main Level	1575 Sq. Ft.
Covered Area	238 Sq. Ft.
Total Finished Area	1575 Sq. Ft.

Exterior Dimensions

Width	61' 4"
Depth	43' 4"

Default Construction Stats

Stats are unique to the individual plan.

Foundation Type	Slab
Exterior Wall Construction	2x6
Roof Pitches	Primary 3/12
Main Wall Height	9'

Plan Description

The Rock Creek Barndominium is a versatile and stylish dwelling that combines the rustic charm of a barn with the comforts of a contemporary home. The exterior features a traditional board and batten facade, with clean lines and large windows, providing an abundance of natural light and a connection to the surrounding landscape. The covered patio and pergola add an inviting outdoor space, seamlessly blending the indoor and outdoor living areas. As you approach the Rock Creek, you are greeted by a welcoming covered patio leading to a spacious foyer. The front door opens into the heart of the home, revealing an open-concept living area that combines the kitchen, dining, and living spaces. The interior boasts high ceilings and a large fireplace, adding warmth and a focal point to the space. Floor-to-ceiling windows and double french doors open up to the patio, providing stunning views of the outdoors and allowing for seamless indoor-outdoor living. The patio, an extension of the living space, is furnished with comfortable outdoor seating and overlooks a well-manicured garden. The attached pergola provides additional shade and a perfect spot for outdoor dining or relaxation. The design of the outdoor space complements the modern aesthetic of the Barndominium while offering a peaceful retreat for enjoying nature. Overall, this modern Barndominium seamlessly blends contemporary design with rustic charm, creating a unique and inviting home that embraces both style and functionality.