

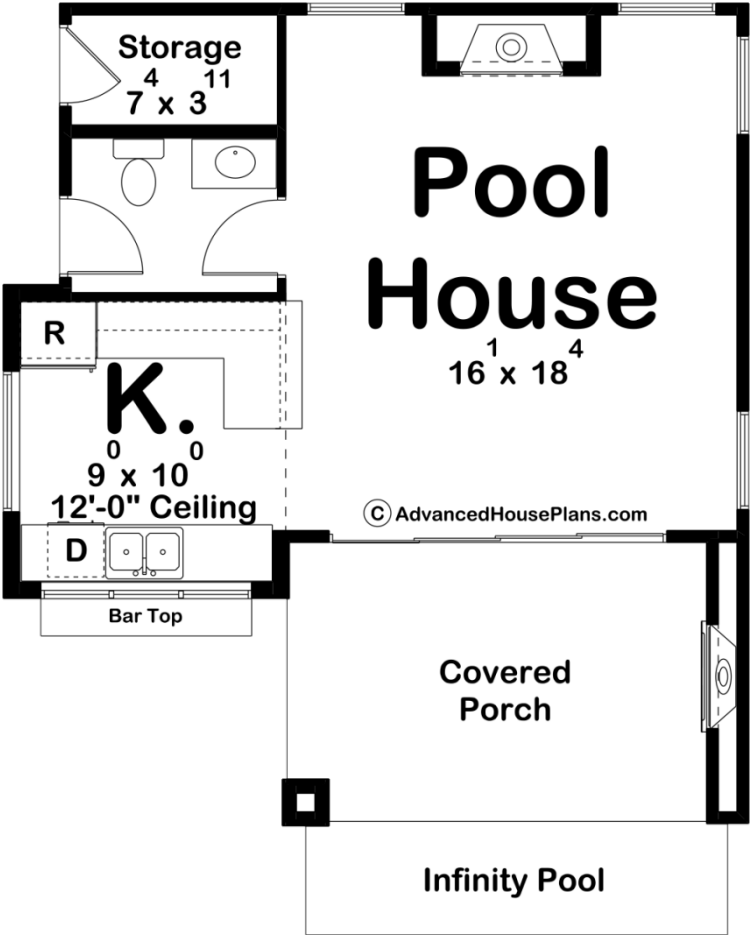

30235 - Roan Ridge Data Sheet

472 SQ FT	0 BEDS	1 BATHS	0 BAYS	26' 4" WIDE	29' 0" DEEP
--------------	-----------	------------	-----------	----------------	----------------



Construction Specs

Layout

Bathrooms

Square Footage

Main Level	472 Sq. Ft.
Covered Area	151 Sq. Ft.
Total Finished Area	472 Sq. Ft.

Exterior Dimensions

Width	26' 4"
Depth	29' 0"

Default Construction Stats

Stats are unique to the individual plan.

Foundation Type	Slab
Exterior Wall Construction	2x4
Roof Pitches	Flat
Main Wall Height	9'

Plan Description

This modern style pool house has everything you could dream of for a backyard escape. With the gorgeous exterior featuring a covered porch and infinity pool, it truly looks like the perfect backyard oasis. A snack bar just next to the patio is a perfect way to entertain guests and invite them in while still getting dry. Head inside to see the rest of the quaint kitchen and pool house area, perfect for relaxing, getting a break from the sun, or enjoying a snack. A bathroom with an interior and exterior door and storage space just on the other side makes the Roan Ridge plan an easy space to keep clean and is practical for any pool owner!