

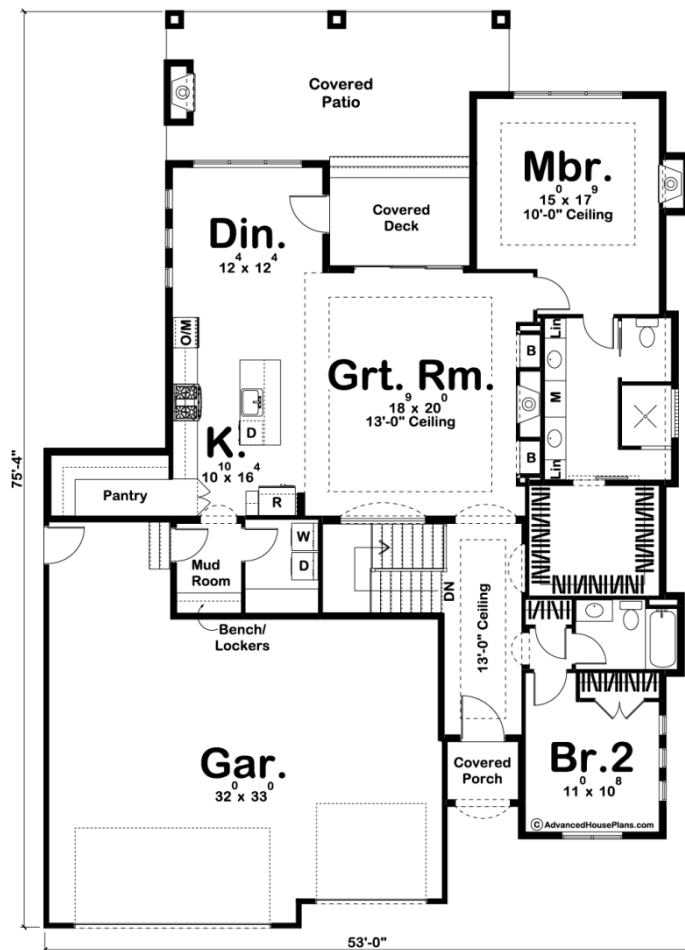

**29526 - Pacific Dunes Data Sheet**

1899 SQ FT	2 BEDS	2 BATHS	3 BAYS	53' 0" WIDE	76' 0" DEEP
---------------	-----------	------------	-----------	----------------	----------------



**Construction Specs**

**Layout**

Bedrooms

Bathrooms	2
-----------	---

Garage Bays	3
-------------	---

### Square Footage

Main Level	1899 Sq. Ft.
------------	--------------

Garage	888 Sq. Ft.
--------	-------------

Total Finished Area	1899 Sq. Ft.
---------------------	--------------

### Exterior Dimensions

Width	53' 0"
-------	--------

Depth	76' 0"
-------	--------

Ridge Height	22' 0"
--------------	--------

*Calculated from main floor line*

### Default Construction Stats

*Stats are unique to the individual plan.*

Foundation Type	Basement
-----------------	----------

Exterior Wall Construction	2x4
----------------------------	-----

Roof Pitches	6/12 Primary 8/12 Secondary
--------------	-----------------------------

Foundation Wall Height	9'
------------------------	----

Main Wall Height	9'
------------------	----

## Plan Description

Classic Mediterranean styling is accented by a tasteful blend of textures on this 1-story house plan. Inside, guests are treated to open views throughout much of the home's living space. Tall ceiling details and elegant arches define the outer boundary of the great room area with its fireplace and built-in entertainment center and bookcases. The kitchen and breakfast area lie open to the great room and feature an island workspace and a walk-in pantry. From this area, a rear covered patio with built-in fireplace is accessed. A few steps from the kitchen can also lead to a generously sized laundry room with counters. Just outside the laundry room, a mud area with built-in bench and coat closet offers access to the home's 3-car garage. The master is situated for privacy and designed for comfort. The bath area features dual sinks, compartmented toilet, a walk-in shower, and an oversized walk-in closet. Bedroom #2 is located at the front of the home just off of the entry.