

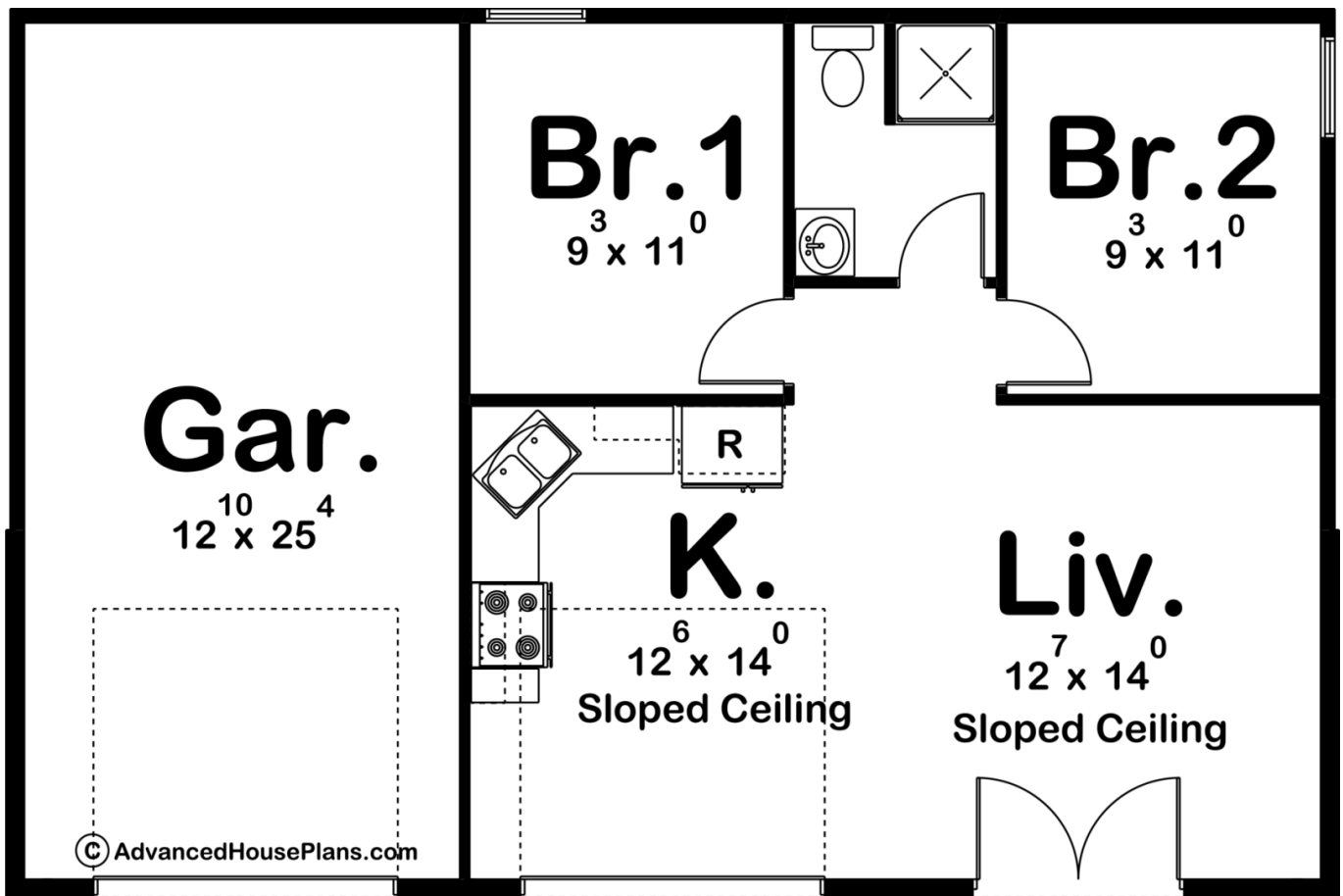

**29553 - Ourey Data Sheet**

672 SQ FT	2 BEDS	1 BATHS	1 BAYS	39' 0" WIDE	26' 0" DEEP
--------------	-----------	------------	-----------	----------------	----------------



**Construction Specs**

Layout

Bedrooms

Bathrooms	1
Garage Bays	1
<b>Square Footage</b>	
Main Level	672 Sq. Ft.
Garage	342 Sq. Ft.
Total Finished Area	672 Sq. Ft.
<b>Exterior Dimensions</b>	
Width	39' 0"
Depth	26' 0"
<b>Default Construction Stats</b>	
<i>Stats are unique to the individual plan.</i>	
Foundation Type	Slab
Exterior Wall Construction	2x6

## Plan Description

The Ourey, with its modern style and open floorplan, makes a perfect lake house or beach getaway. The exterior is inviting with stone accents and numerous windows to provide plenty of natural light. Inside you'll find a large Living room that opens up to a full kitchen. Both bedrooms share a bathroom.