

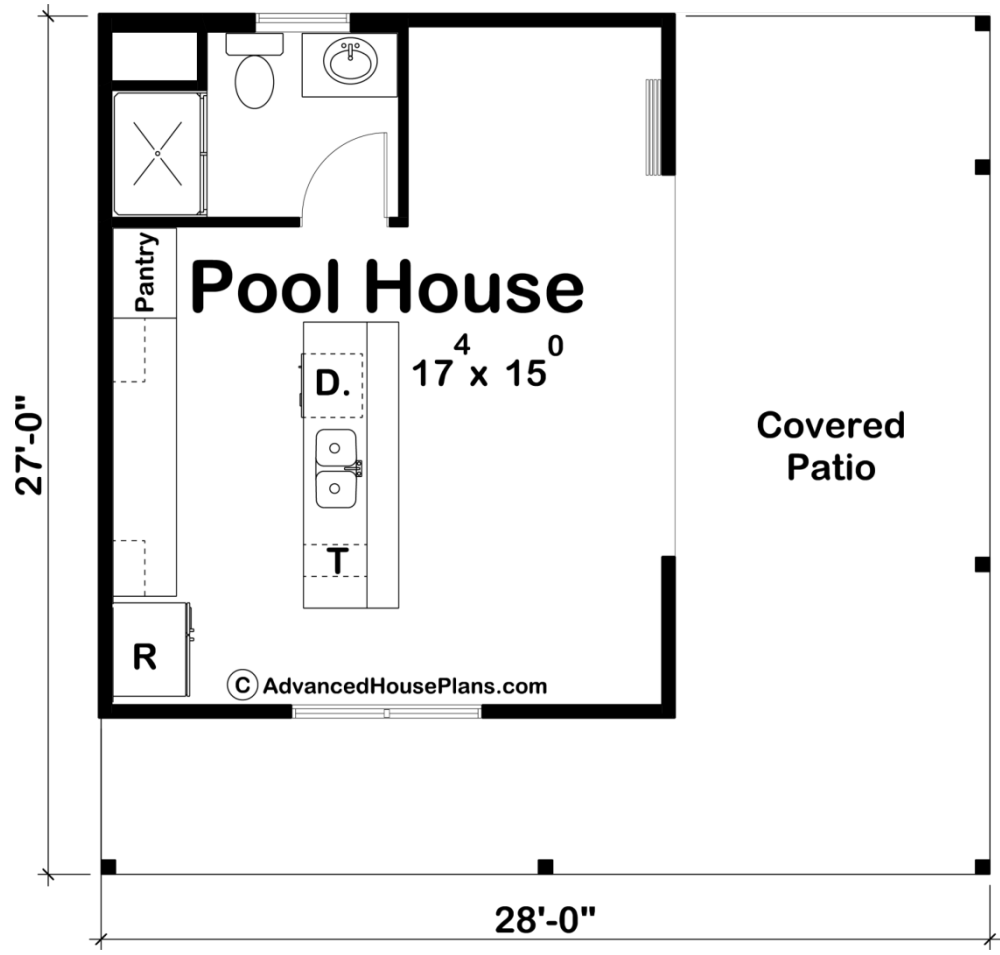

29561 - Meyers Data Sheet

| | | | | | |
|--------------|-----------|------------|-----------|----------------|----------------|
| 396 SQ FT | 0 BEDS | 1 BATHS | 0 BAYS | 28' 0" WIDE | 27' 0" DEEP |
|--------------|-----------|------------|-----------|----------------|----------------|



Construction Specs

Layout

Bathrooms

Square Footage

| | |
|---------------------|-------------|
| Main Level | 396 Sq. Ft. |
| Covered Area | 360 Sq. Ft. |
| Total Finished Area | 396 Sq. Ft. |

Exterior Dimensions

| | |
|-------|--------|
| Width | 28' 0" |
| Depth | 27' 0" |

Default Construction Stats

Stats are unique to the individual plan.

| | |
|----------------------------|------|
| Foundation Type | Slab |
| Exterior Wall Construction | 2x4 |

Plan Description

This simple pool house design has great indoor and outdoor spaces. The Meyers plan has a covered patio that wraps around two sides of the pool house. The wood posts and stone give this pool house plan some charm of its own. The large glass doors allows you to bring the outdoors inside while escaping the sun on a hot summer day. Inside lies a large kitchen equipped with everything you would ever want in your pool house. Ample amount of counter space makes this a great area to prepare and entertain. A 3/4 bath is conveniently located in the rear corner of this pool house. Although a simple design, this pool house plan will have you relaxing in luxury. Be sure to check out our other pool houses. As always any of our plans at Advanced House Plans can be customized to fit your needs with our alteration department. Whether you need to change the front elevation style, add a window, stretch it larger or just make the plan more affordable for your budget we can do that and more for you at Ahp.