

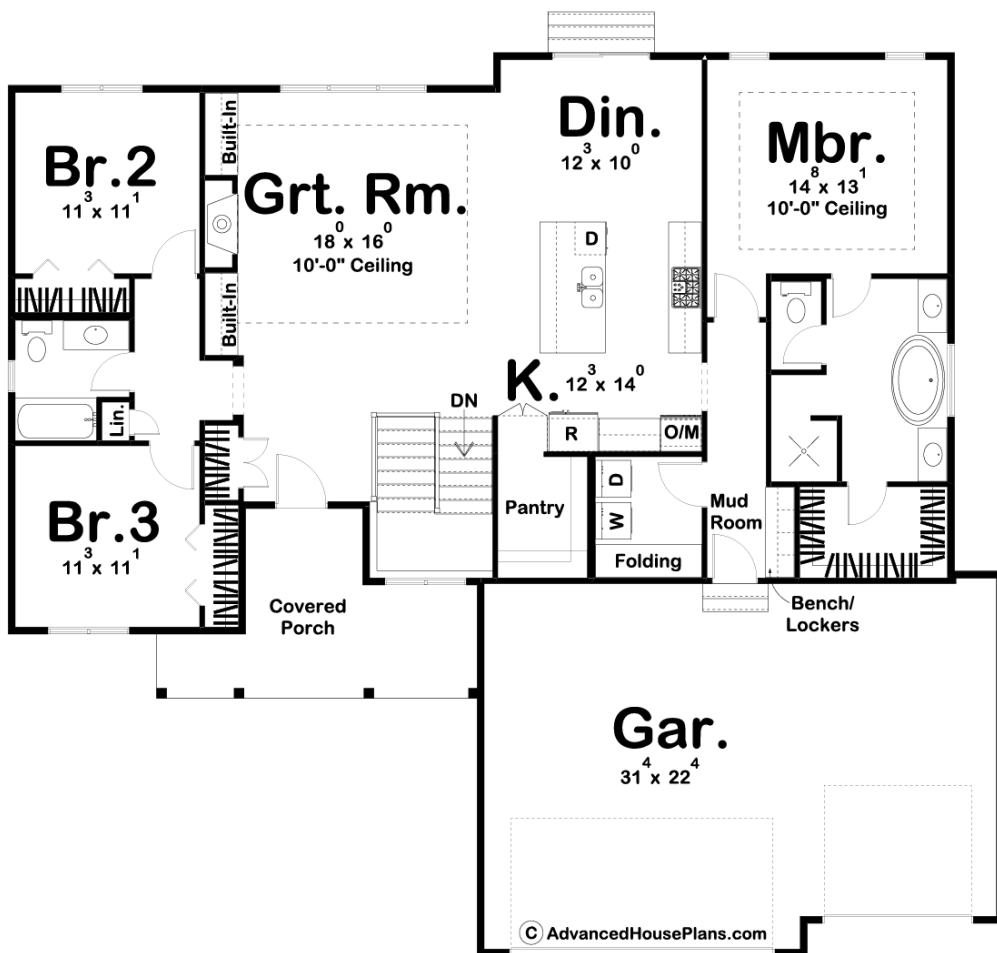

29767 - Meadow View Data Sheet

1824 SQ FT	3 BEDS	2 BATHS	3 BAYS	60' 8" WIDE	55' 0" DEEP
---------------	-----------	------------	-----------	----------------	----------------



Construction Specs

Layout

Bedrooms

Bathrooms	2
Garage Bays	3

Square Footage

Main Level	1824 Sq. Ft.
Total Finished Area	1824 Sq. Ft.

Exterior Dimensions

Width	60' 8"
Depth	55' 0"

Default Construction Stats

Stats are unique to the individual plan.

Foundation Type	Basement
Exterior Wall Construction	2x4
Roof Pitches	8/12 Primary, 4/12 10/12 Secondary
Foundation Wall Height	9'
Main Wall Height	9'

Plan Description

Featuring a beautiful modern farmhouse exterior facade, the Meadow View is a charming 1 story house plan with a great floor plan to match! The Meadow View features an open floor plan that feels huge! It's got a deep walk-in pantry, hidden by cabinet-faced doors, and tons of space in the mudroom to keep your life, and this beautiful home, organized. The great room is warmed by a fireplace that is flanked by built-in bookshelves. On the right side of the home, the master suite is generously sized with a shower and spa tub and a spacious walk-in closet. On the opposite side of the home, bedrooms 2 and 3 share a centrally located hall bathroom.