

ADVANCED
HOUSE PLANS

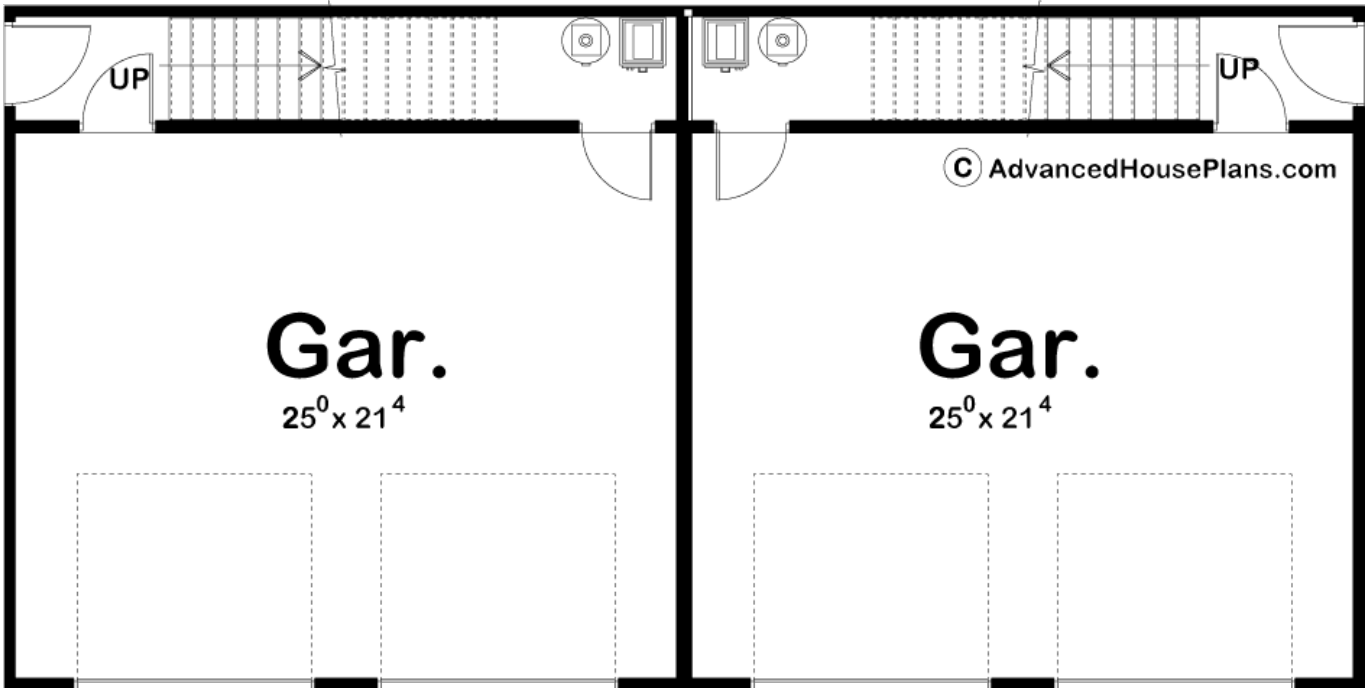

29316 - McCollum Data Sheet

689 SQ FT	1 BEDS	1 BATHS	2 BAYS	52' 0" WIDE	26' 0" DEEP
--------------	-----------	------------	-----------	----------------	----------------



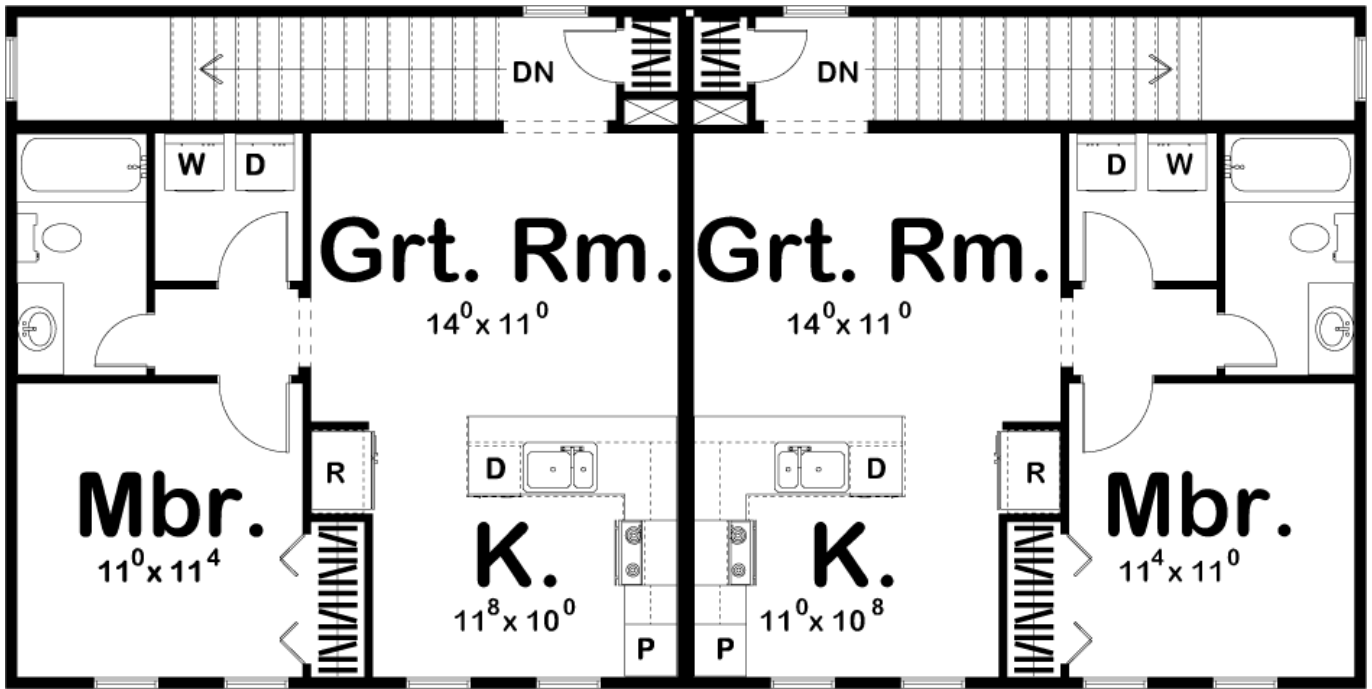

© AdvancedHousePlans.com

Construction Specs

Layout

Bedrooms	1
Bathrooms	1
Garage Bays	2

Square Footage

Second Level	689 Sq. Ft.
Garage	573 Sq. Ft.
Total Finished Area	689 Sq. Ft.

Exterior Dimensions

Width	52' 0"
Depth	26' 0"
Ridge Height <i>Calculated from main floor line</i>	29' 0"

Default Construction Stats

Stats are unique to the individual plan.

Foundation Type	Slab
Exterior Wall Construction	2x4
Roof Pitches	8/12 Primary, 10/12 Secondary
Main Wall Height	9'
Second Wall Height	9'

Plan Description

This loft apartment, multi-family house plan has a decidedly French Country appeal, created by sloping roof lines and an array of windows perched above a quartet of garage doors. Inside, guests are greeted by views of the great room and kitchen, which lie open to one another. The kitchen is smartly designed for efficiency and includes a practical breakfast bar. An alcove off the great room leads to the master bedroom, laundry room, and full bath.