

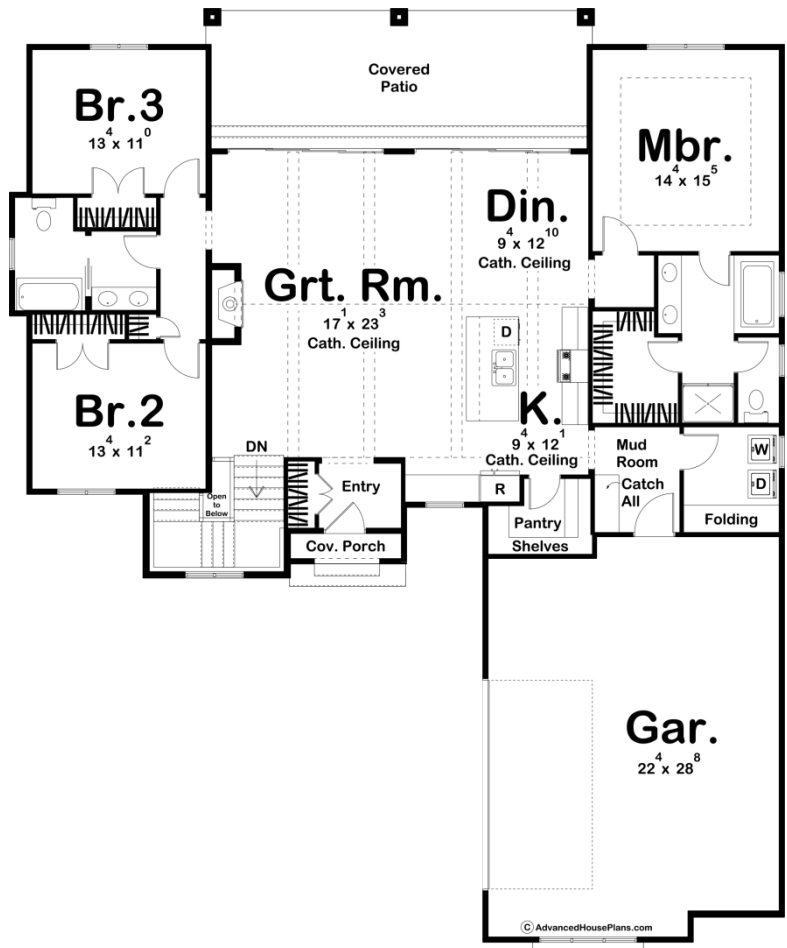

**29879 - Martinson Data Sheet**

1958 SQ FT	3 BEDS	2 BATHS	2 BAYS	59' 4" WIDE	68' 6" DEEP
---------------	-----------	------------	-----------	----------------	----------------



**Construction Specs**

Layout

Bedrooms

Bathrooms	2
-----------	---

Garage Bays	2
-------------	---

### Square Footage

Main Level	1958 Sq. Ft.
------------	--------------

Garage	685 Sq. Ft.
--------	-------------

Total Finished Area	1958 Sq. Ft.
---------------------	--------------

### Exterior Dimensions

Width	59' 4"
-------	--------

Depth	68' 6"
-------	--------

### Default Construction Stats

*Stats are unique to the individual plan.*

Foundation Type	Basement
-----------------	----------

Exterior Wall Construction	2x4
----------------------------	-----

Roof Pitches	12/12 Primary, 16/12 Secondary
--------------	--------------------------------

Foundation Wall Height	9'
------------------------	----

Main Wall Height	9'
------------------	----

## Plan Description

The Martinson plan merges the classic cottage styling with modern elements to create the new Modern Cottage style. Contrasting colors on the stucco and roof make this plan a unique masterpiece. On the inside, you'll walk into the great room that is warmed by a fireplace. The great room, kitchen, and dining room lie under a soaring cathedral ceiling with exposed beams. The great room opens up to the covered patio through 2 sets of sliding glass doors. The home's kitchen includes a large island and a walk-in pantry. The master includes a soaking tub, his/her vanities, an enclosed toilet area, and a walk-in closet. On the opposite side of the home, 2 bedrooms share a centrally located hall bathroom.