

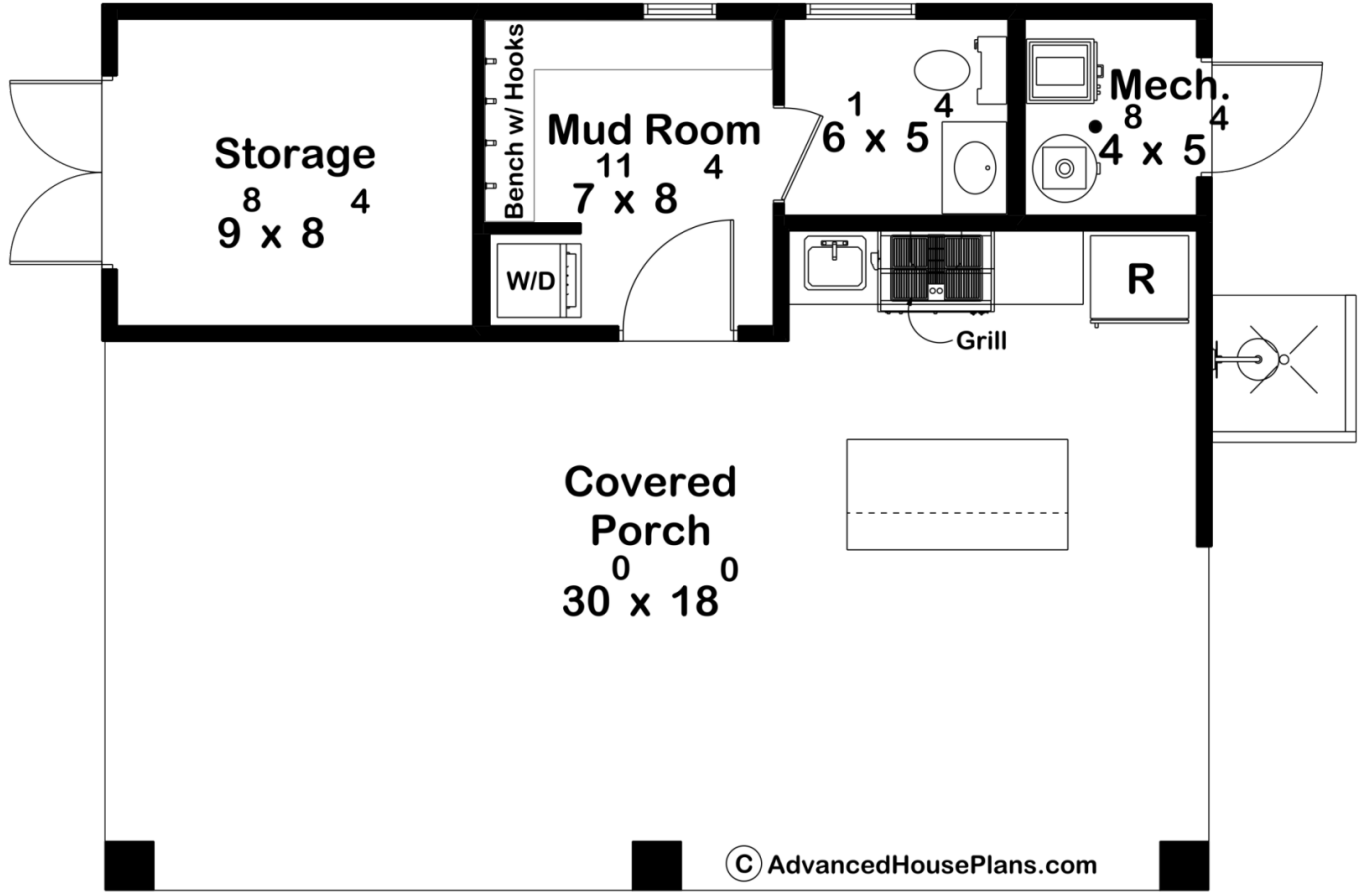

30504 - Livermore Data Sheet

| | | | | | |
|--------------|-----------|------------|-----------|----------------|----------------|
| 116 SQ FT | 0 BEDS | 1 BATHS | 0 BAYS | 30' 0" WIDE | 24' 0" DEEP |
|--------------|-----------|------------|-----------|----------------|----------------|



Construction Specs

Layout

Bathrooms

| Square Footage | |
|--|--------------|
| Main Level | 116 Sq. Ft. |
| Covered Area | 484 Sq. Ft. |
| Total Finished Area | 116 Sq. Ft. |
| Exterior Dimensions | |
| Width | 30' 0" |
| Depth | 24' 0" |
| Default Construction Stats | |
| Stats are unique to the individual plan. | |
| Foundation Type | Slab |
| Exterior Wall Construction | 2x4 |
| Roof Pitches | Primary 6/12 |
| Main Wall Height | 9' |

Plan Description

Imagine owning a stylish modern farmhouse pool house that embodies the perfect blend of sophistication and relaxation. Step onto the large covered porch, where you can unwind and entertain while enjoying views of the pool and surrounding landscape. The outdoor kitchen invites you to host gatherings and prepare meals al fresco, creating unforgettable moments with family and friends. After a swim, rinse off in the outdoor shower, a refreshing experience that connects you with nature. Inside, a thoughtfully designed storage room provides ample space for pool toys, equipment, and supplies, keeping everything organized and easily accessible. The mudroom, complete with a stacked washer and dryer, offers convenience and functionality, allowing you to clean up after outdoor activities without hassle. This modern farmhouse pool house is more than just a retreat—it's a sanctuary where luxury meets practicality, enhancing your lifestyle with every detail. This plan also has 120 sq ft of unfished storage & mechanical space.