

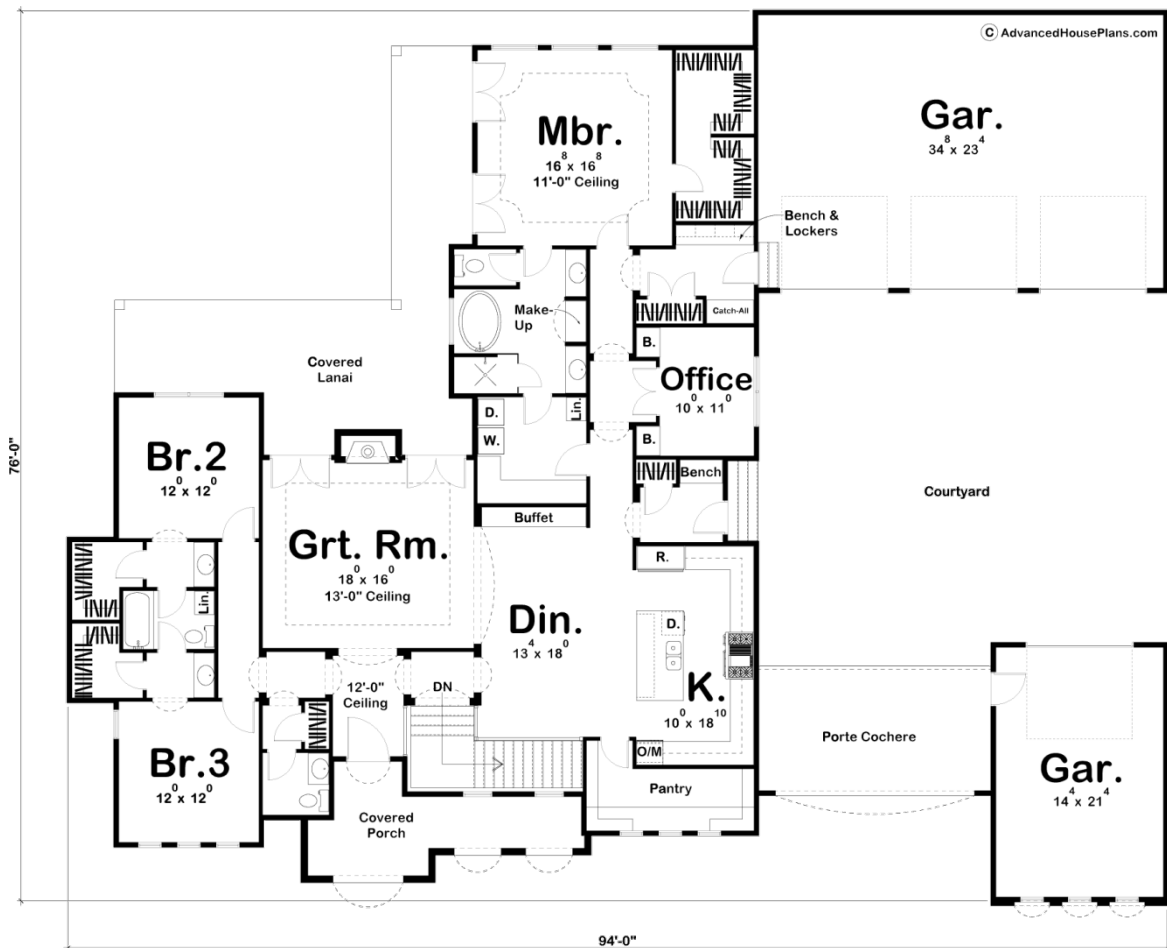

29365 - Lamplighter Data Sheet

2676 SQ FT	3 BEDS	3 BATHS	4 BAYS	94' 0" WIDE	76' 0" DEEP
---------------	-----------	------------	-----------	----------------	----------------



Construction Specs

Layout

Bedrooms

Bathrooms	3
Garage Bays	4
Square Footage	
Main Level	2676 Sq. Ft.
Garage	1172 Sq. Ft.
Total Finished Area	2676 Sq. Ft.
Exterior Dimensions	
Width	94' 0"
Depth	76' 0"
Ridge Height <i>Calculated from main floor line</i>	24'
Default Construction Stats <i>Stats are unique to the individual plan.</i>	
Foundation Type	Basement
Exterior Wall Construction	2x4
Roof Pitches	6/12
Foundation Wall Height	9'
Main Wall Height	10'

Plan Description

Spacious, stylish, and sophisticated describes this 1 story house plan - the Lamplighter has it all! With an attractive Mediterranean/Southwestern style exterior, a luxurious interior, and a great floor plan, you'll want to take a look at this beautifully designed home. The plan features a courtyard-style driveway with arched porte cochere offering privacy and security. The covered porch is a grand entry into a gorgeous home. Inside, the Lamplighter home plan has even more to offer. The oversized great room has a 13' high coffered ceiling, fireplace, and dual French doors that open up to a spacious covered lanai that wraps around 2 sides of the rear of the house - lots of room to entertain outside in the shade! The master suite has a large divided walk-in closet, direct laundry access, and is tucked away from the living spaces of the home for privacy. It has lots of windows and dual French doors to let in plenty of light and breeze.