

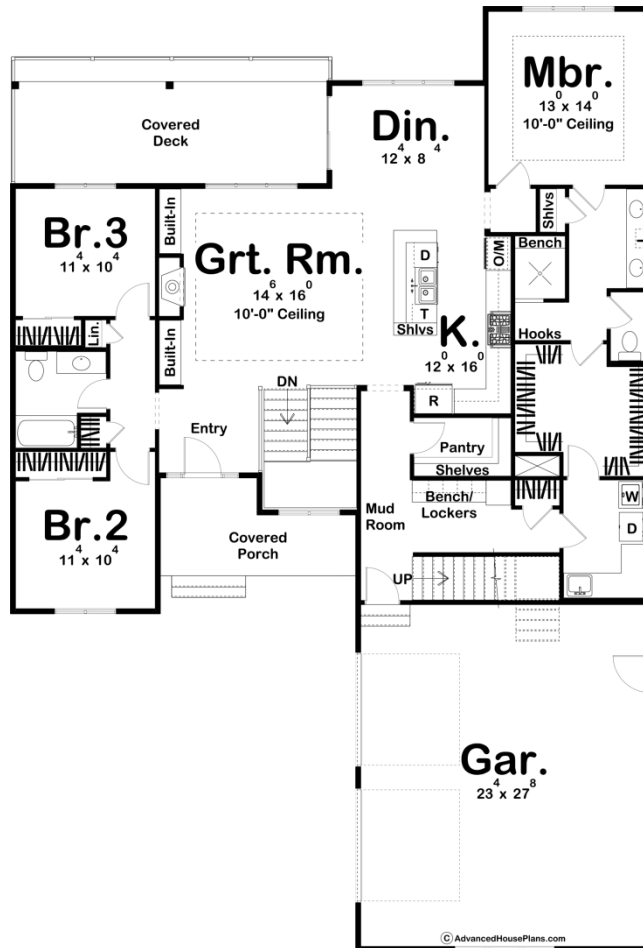

29885 - Lakeland Data Sheet

1936 SQ FT	3 BEDS	2 BATHS	2 BAYS	52' 0" WIDE	76' 4" DEEP
---------------	-----------	------------	-----------	----------------	----------------

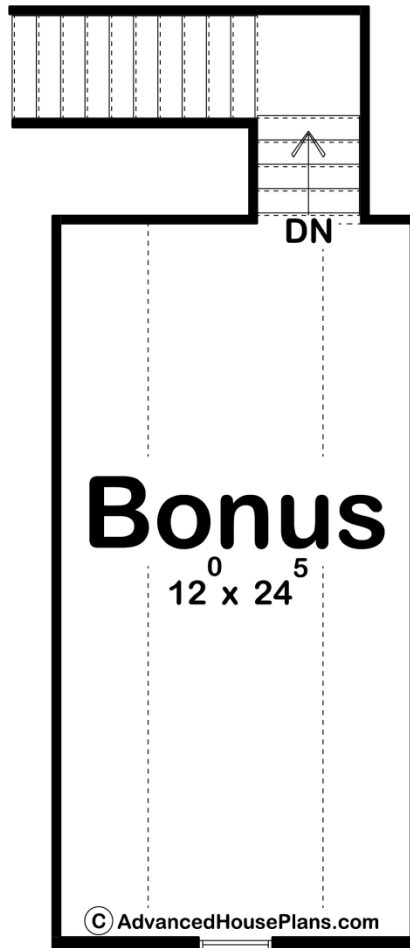



Construction Specs

Layout

Bedrooms	3
Bathrooms	2
Garage Bays	2

Square Footage

Main Level	1936 Sq. Ft.
Garage	672 Sq. Ft.
Total Finished Area	1936 Sq. Ft.

Exterior Dimensions

Width	52' 0"
Depth	76' 4"

Default Construction Stats

Stats are unique to the individual plan.

Foundation Type	Basement
Exterior Wall Construction	2x4

Roof Pitches	8/12 Primary, 12/12 Secondary
Foundation Wall Height	9'
Main Wall Height	9'

Plan Description

The Lakeland plan is a beautiful modern farmhouse plan. The exterior features board and batten siding with a courtyard garage. At just over 1900 square feet, this plan is a great size for any family. Just inside the home, you'll walk into a large great room that is warmed by a fireplace with built-in bookshelves. The kitchen flows seamlessly with the great room and dining room in an open layout. The kitchen includes a walk-in pantry and a large island with built-in shelves. The master suite includes his/her vanities, a walk-in shower and a large walk-in closet that accesses the laundry room. Bedrooms 2 and 3 share a centrally located hall bathroom. An optional bonus room above the garage adds 315 sq ft.