

ADVANCED
HOUSE PLANS

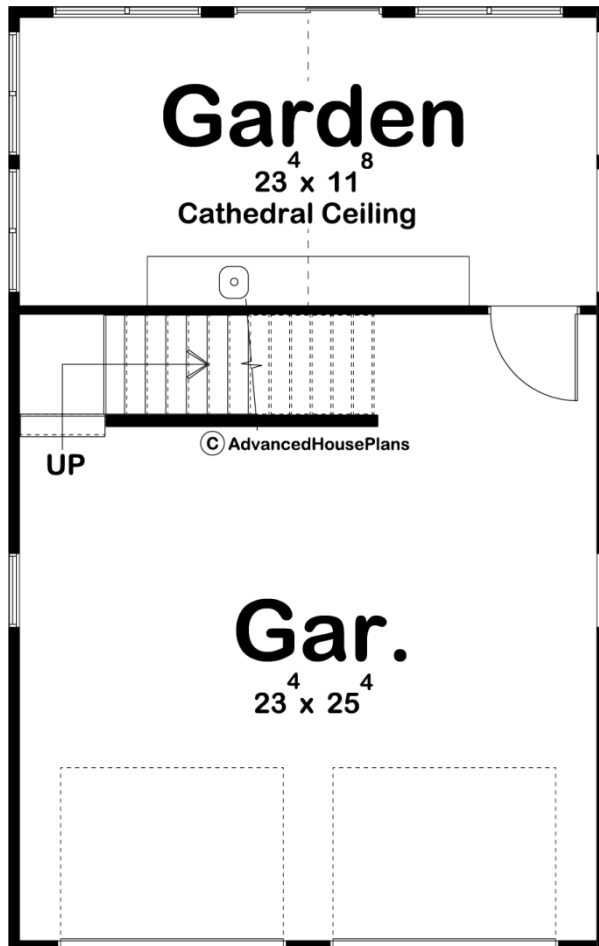

29376 - Kistler Data Sheet

730 SQ FT	0 BEDS	0 BATHS	2 BAYS	24' 0" WIDE	38' 0" DEEP
--------------	-----------	------------	-----------	----------------	----------------



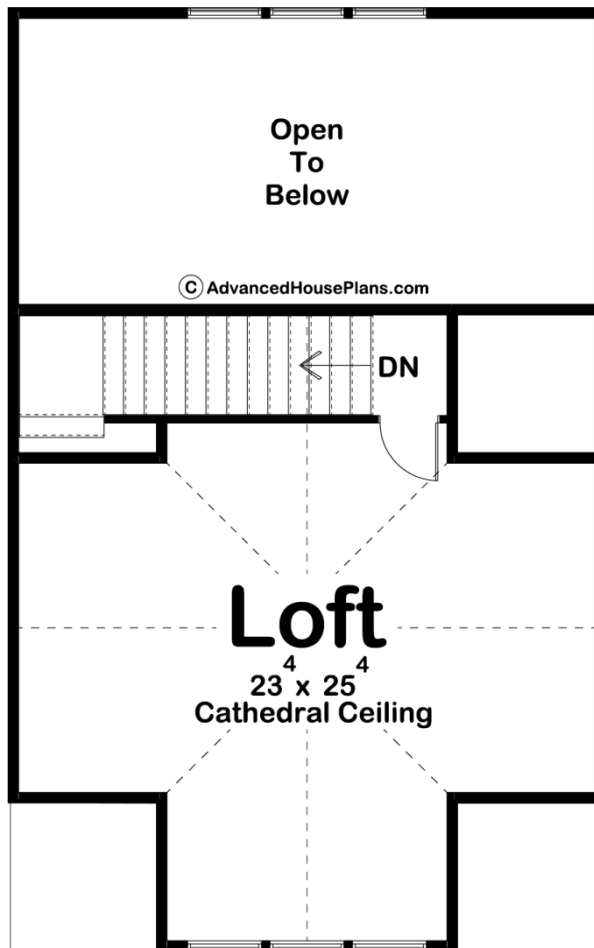

Construction Specs

Layout

Garage Bays 2

Square Footage

Main Level 288 Sq. Ft.

Second Level 442 Sq. Ft.

Garage 624 Sq. Ft.

Total Finished Area 730 Sq. Ft.

Exterior Dimensions

Width 24' 0"

Depth 38' 0"

Default Construction Stats

Stats are unique to the individual plan.

Foundation Type Slab

Exterior Wall Construction 2x4

Roof Pitches 12/12 Primary

Main Wall Height	9'
Second Wall Height	6'

Plan Description

Kistler is a 2-story traditional garage built on a slab foundation. There is an attic space above the garage and a 2-story garden room in the rear. The second story walls are built at 6' and the ceiling slopes up to approximately 10'. The garden room has windows on 3 sides and a large sliding patio door on the rear.