

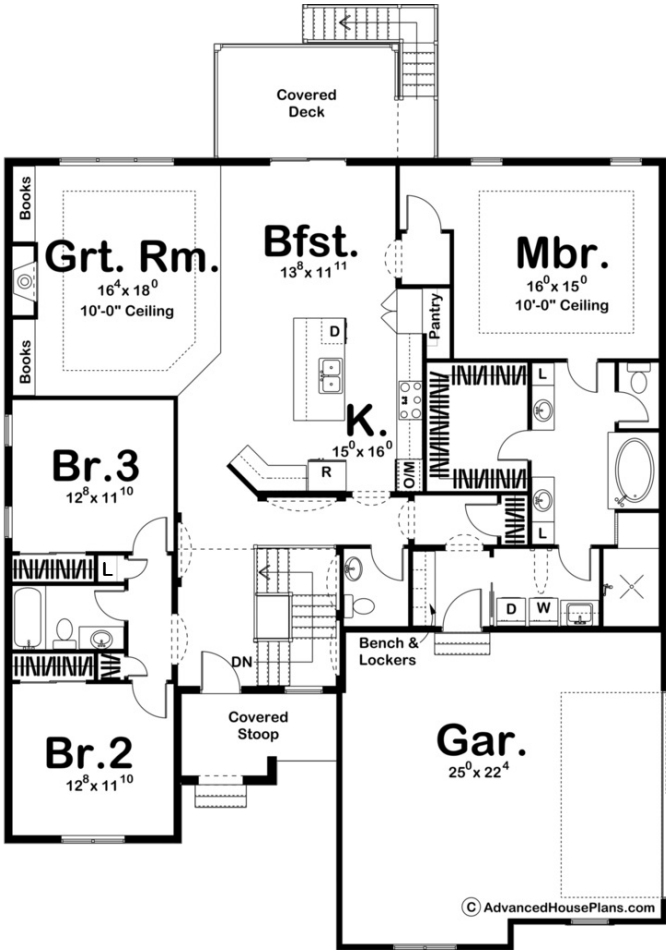

29318 - Katzberg Data Sheet

2195 SQ FT	3 BEDS	3 BATHS	2 BAYS	52' 0" WIDE	62' 0" DEEP
---------------	-----------	------------	-----------	----------------	----------------



Construction Specs

Layout
--------

Bedrooms

Bathrooms	3
Garage Bays	2
<b>Square Footage</b>	
Main Level	2195 Sq. Ft.
Garage	607 Sq. Ft.
Total Finished Area	2195 Sq. Ft.
<b>Exterior Dimensions</b>	
Width	52' 0"
Depth	62' 0"
Ridge Height	24'
<i>Calculated from main floor line</i>	
<b>Default Construction Stats</b>	
<i>Stats are unique to the individual plan.</i>	
Foundation Type	Basement
Exterior Wall Construction	2x4
Foundation Wall Height	9'
Main Wall Height	10'

## Plan Description

The beautiful Mediterranean style of this 1 story house plan makes this house fit in any neighborhood type. A mixture of stucco and stone on the exterior gives this plan great curb appeal. On the inside of this beautiful home, you'll find a fantastic floor plan. The kitchen includes a large kitchen island with a snack bar and a walk-in pantry. The great room lies under a 10' high tray ceiling and is warmed by a fireplace that is flanked by built-in bookshelves. The master suite lies on the opposite side of the home to give privacy from the other bedrooms and includes a bath with his/her vanities and a large walk-in closet. The master bedroom also has convenient access to the laundry room. The 2 car garage enters the home through a mudroom that includes a bench and lockers.