

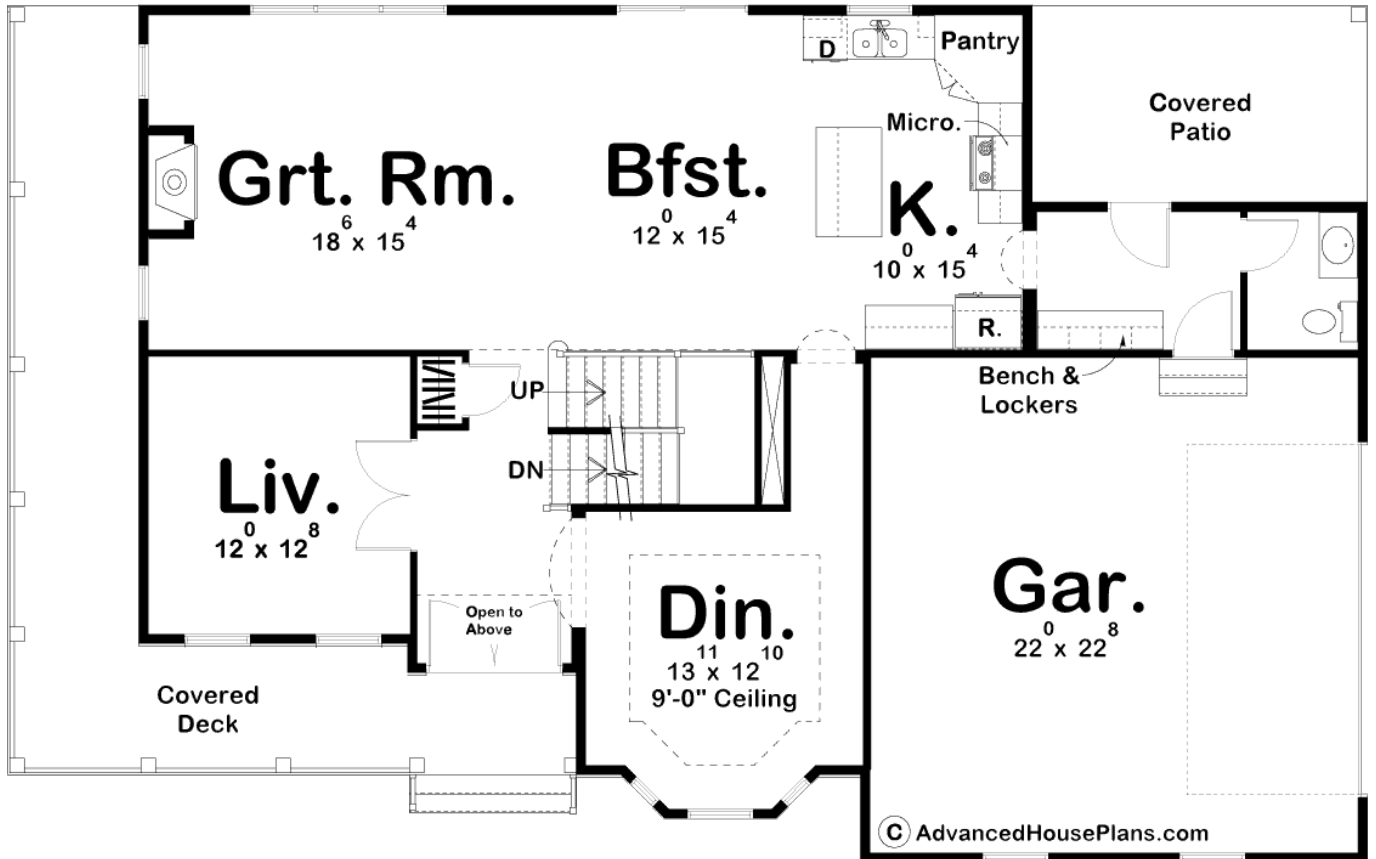

29363 - Johnson Farm Data Sheet

2727 SQ FT	4 BEDS	3 BATHS	2 BAYS	62' 0" WIDE	39' 0" DEEP
---------------	-----------	------------	-----------	----------------	----------------

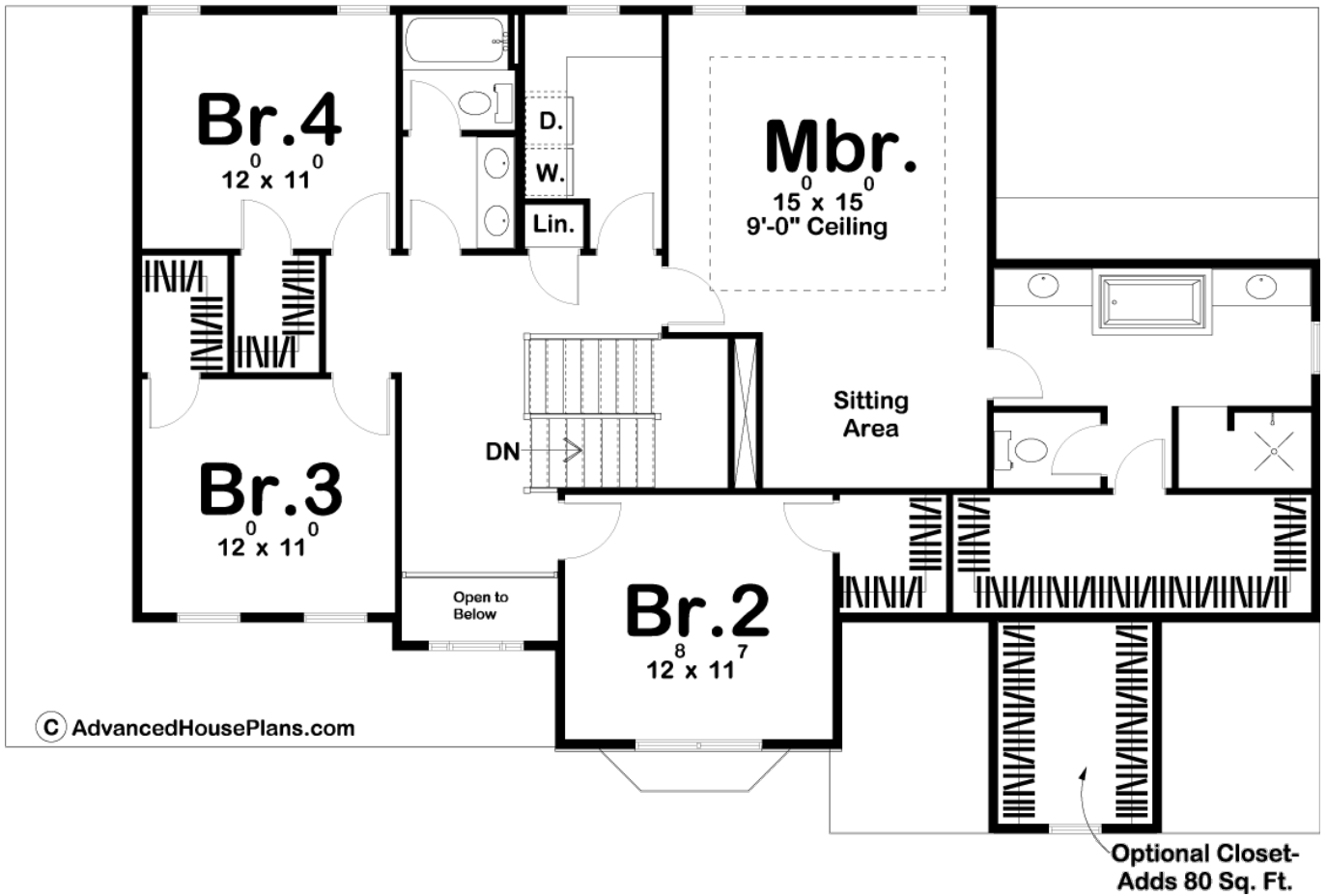



Construction Specs

Layout	
Bedrooms	4
Bathrooms	3
Garage Bays	2
Square Footage	
Main Level	1296 Sq. Ft.
Second Level	1431 Sq. Ft.
Garage	522 Sq. Ft.
Total Finished Area	2727 Sq. Ft.
Exterior Dimensions	
Width	62' 0"
Depth	39' 0"
Ridge Height	33'
<i>Calculated from main floor line</i>	

Default Construction Stats

Stats are unique to the individual plan.

Foundation Type	Basement
Exterior Wall Construction	2x4
Roof Pitches	12/12 Primary, 10/12, 4/12 Secondary
Foundation Wall Height	9'
Main Wall Height	9'
Second Wall Height	8'

Plan Description

A wrapping covered porch and classic country-style details give this family-oriented house plan a sense of warmth and welcome. Just inside, a dining room with bayed windows lies opposite the formal living room. A few additional steps provide views to the open arrangement of the great room, breakfast area and kitchen, complete with island and pantry. A mud room with bench and lockers intercepts potential messes from the side-load garage and rear covered patio. Upstairs, the sprawling master suite includes a sitting area in the bedroom. The adjacent master bath area features his and her vanities, soaking tub, compartmented toilet and a walk-in closet with optional expansion. All secondary bedrooms have walk-in closets as well, and share a centrally located bath. An upstairs laundry with counter space is also situated for easy access for all.