

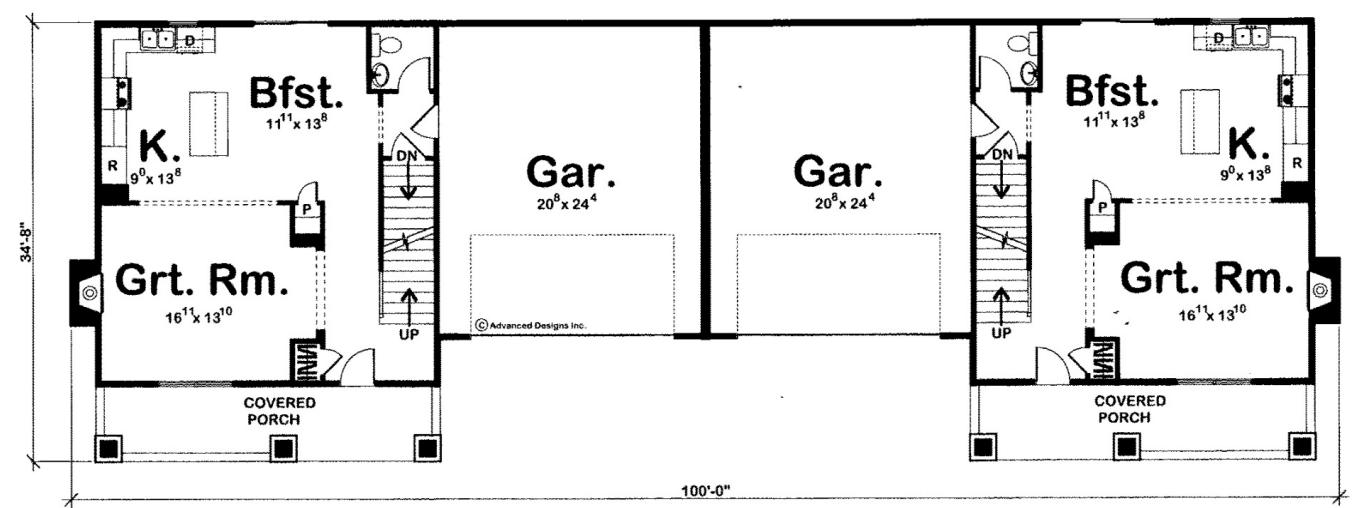

29204 - Ida Data Sheet

1827 SQ FT	4 BEDS	3 BATHS	2 BAYS	100' 0" WIDE	35' 0" DEEP
---------------	-----------	------------	-----------	-----------------	----------------

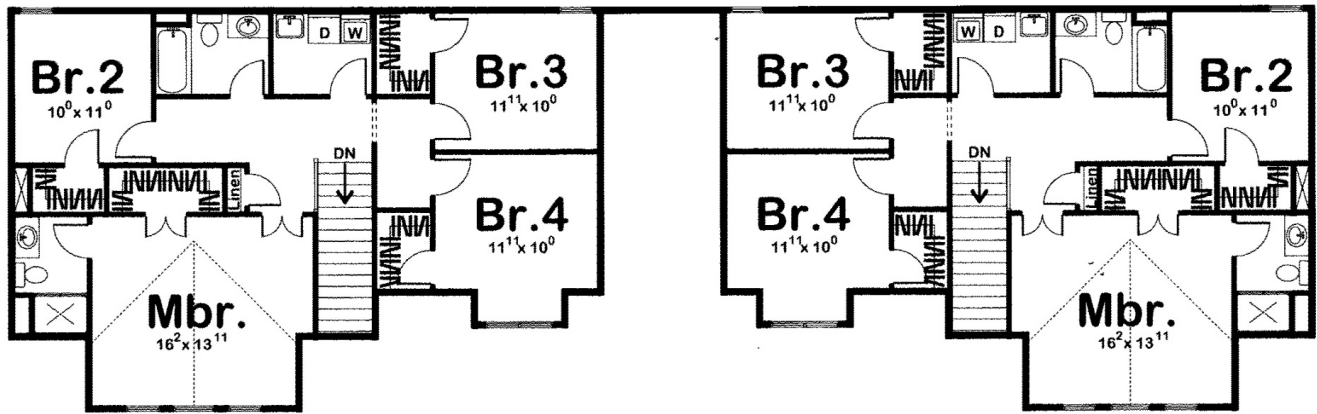



Construction Specs

Layout

Bedrooms	4
Bathrooms	3
Garage Bays	2

Square Footage

Main Level	774 Sq. Ft.
Second Level	1053 Sq. Ft.
Garage	531 Sq. Ft.
Total Finished Area	1827 Sq. Ft.

Exterior Dimensions

Width	100' 0"
Depth	35' 0"
Ridge Height	31'
<i>Calculated from main floor line</i>	

Default Construction Stats
Stats are unique to the individual plan.

Foundation Type	Basement
Exterior Wall Construction	2x4
Roof Pitches	10/12 Primary, 12/12, 8/12, 4/12 Secondary
Foundation Wall Height	9'
Main Wall Height	9'
Second Wall Height	8'

Plan Description

A romantic blend of solid columns, decorative brackets, and half-timbered detailing, flavors this 2-story, multi-family house plan with classic Craftsman styling. An inviting front porch spans the front of each residence, where upon entering, guests are welcomed into the great room. The island kitchen and breakfast area lie open to the great room and provide ample work space for meal preparation. The 2-car garage is accessed just steps away, for short trips from the car to the kitchen with groceries. On the second level, the master bedroom is brightened by three windows to the front and features a walk-in closet and private bath. Bedrooms 2, 3 and 4 each have their own walk-in closet and share a hall bath. A centrally located laundry with soaking sink conveniently serves all bedrooms. As always any Advanced House Plans home plan can be customized to fit your needs with our alteration department. Whether you need to add another garage stall, change the front elevation, stretch the home larger or just make the home plan more affordable for your budget we can do that and more for you at Ahp.