

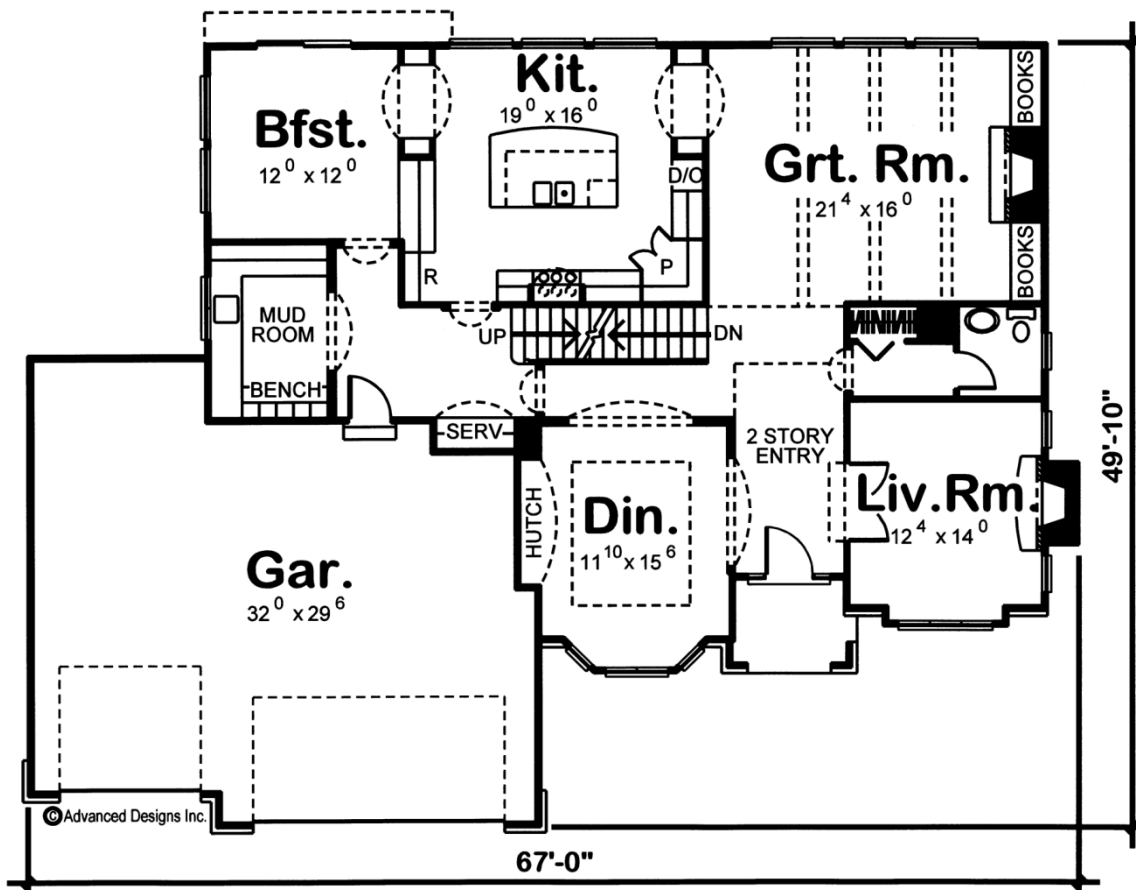

29173 - Hillsborough Data Sheet

4096 SQ FT	5 BEDS	4 BATHS	3 BAYS	65' 0" WIDE	50' 0" DEEP
---------------	-----------	------------	-----------	----------------	----------------

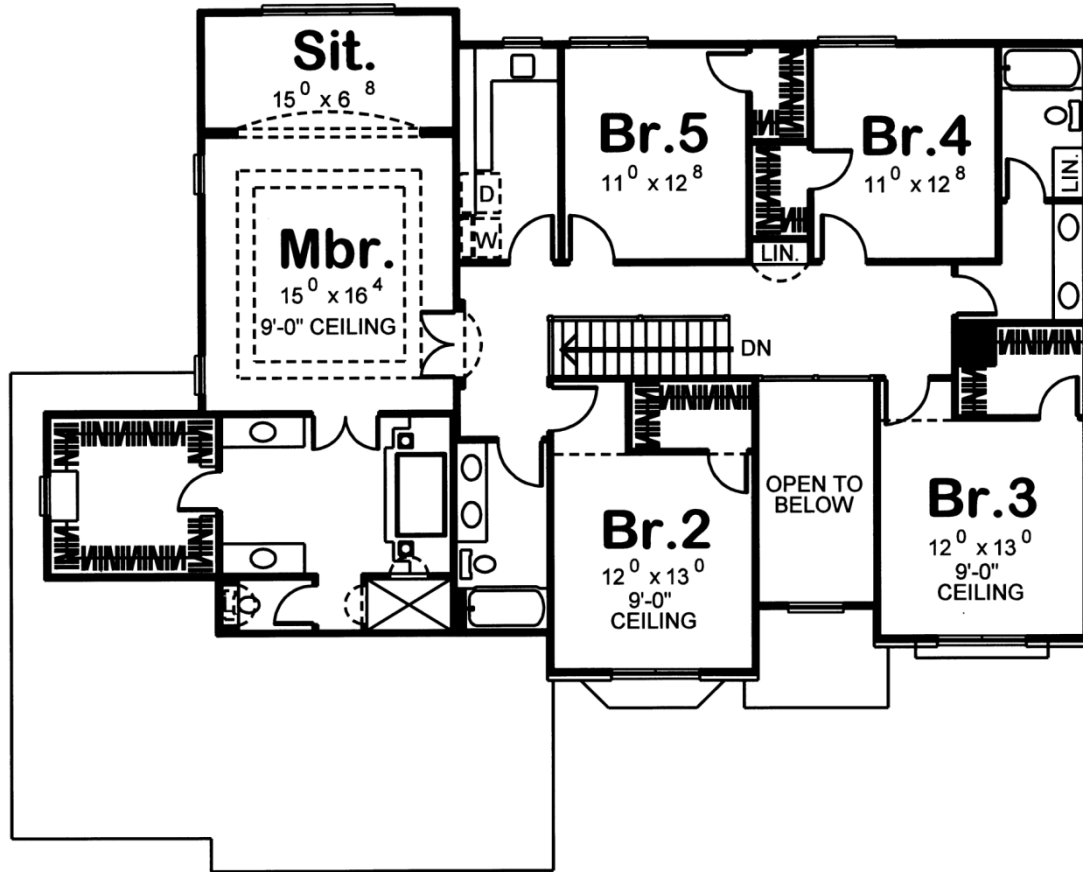



Construction Specs

Layout

Bedrooms	5
Bathrooms	4
Garage Bays	3

Square Footage

Main Level	2042 Sq. Ft.
Second Level	2054 Sq. Ft.
Garage	834 Sq. Ft.
Total Finished Area	4096 Sq. Ft.

Exterior Dimensions

Width	65' 0"
Depth	50' 0"
Ridge Height	31'
<i>Calculated from main floor line</i>	

Default Construction Stats

Stats are unique to the individual plan.

Foundation Type	Basement
Exterior Wall Construction	2x4
Roof Pitches	Primary 5/12, Secondary 12/12
Foundation Wall Height	9'
Main Wall Height	9'
Second Wall Height	8'

Plan Description

Corner quoins and stone accents impart a European flair to this French Country-style, 2-story house plan. A covered stoop leads guests inside, where a 2-story-high entry hall is flanked by living and dining rooms. An arched opening reveals immediate views of the formal dining room with built-in hutch, bayed windows and repeating arch accents. On the other side of the entry, double doors open into the living room with its cozy fireplace. Farther inside, the great room features a fireplace flanked by built-in bookshelves and easily accommodates friendly gatherings. An arched opening connects the great room to the sunny kitchen, which boasts ample counter space, a breakfast island workstation and walk-in corner pantry. Another arched opening leads to the breakfast room that is flooded with natural light and accesses the outdoors. Just off the breakfast area, a foyer, with built-in server for the dining room, accommodates access to the second level as well as to the 3-car garage. A mud room with bench, counter and soaking sink, lies adjacent to this practical area. All sleeping quarters reside upstairs, where the master suite occupies a significant portion of the second level. Double doors lead into the master bedroom, which includes an adjacent sunlit sitting room. The master bath features his-and-her vanities, a soaking tub framed by elegant columns, shower, compartmented toilet and spacious walk-in closet. Two hall baths serve the four secondary bedrooms, which all have walk-in closets. A centrally located laundry room with counter space and soaking sink conveniently serves all bedrooms.