

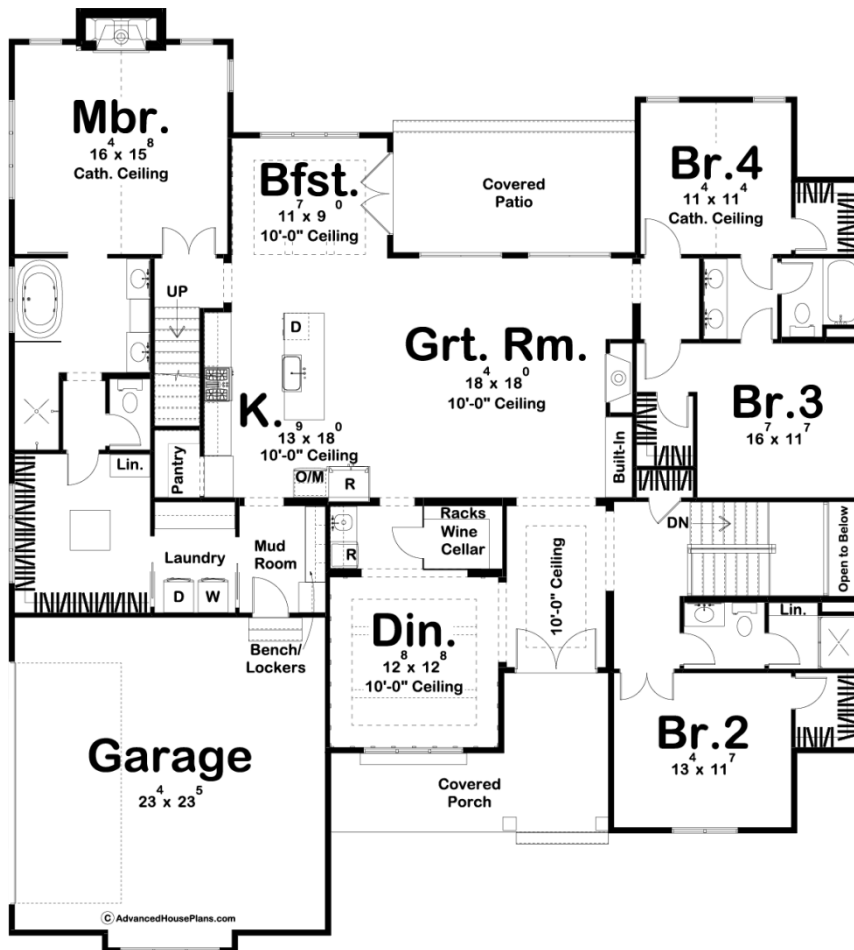

**29734 - Hidden Valley Data Sheet**

2707 SQ FT	4 BEDS	3 BATHS	2 BAYS	67' 0" WIDE	71' 0" DEEP
---------------	-----------	------------	-----------	----------------	----------------

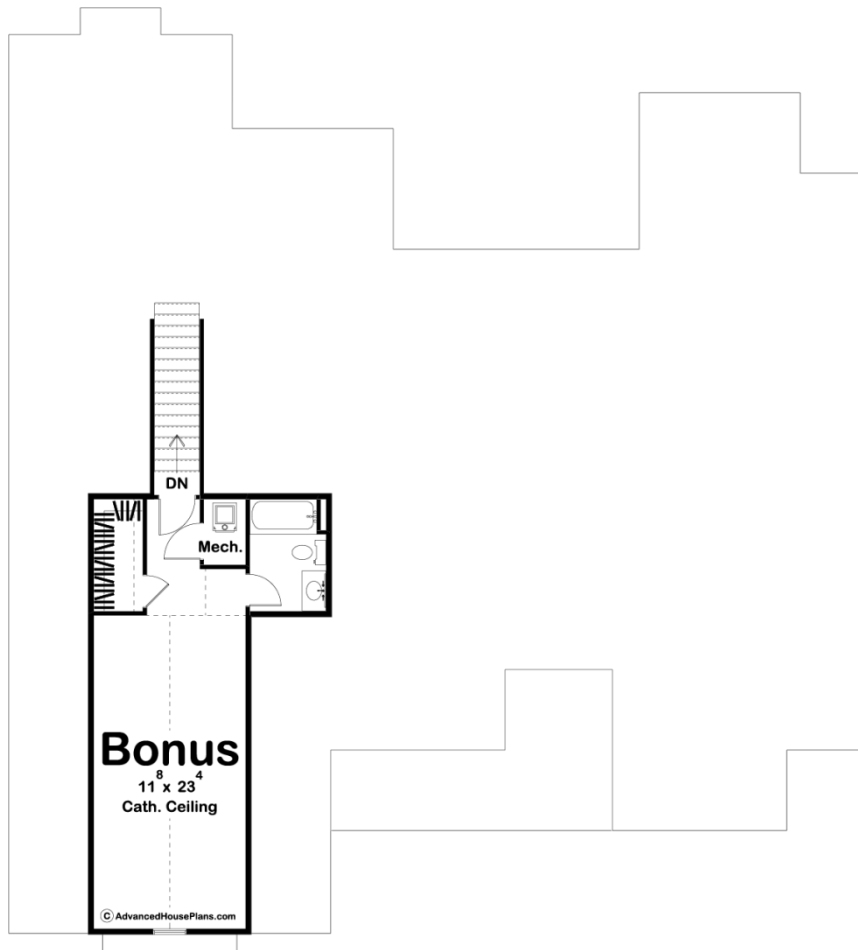



## Construction Specs

### Layout

Bedrooms	4
Bathrooms	3
Garage Bays	2

### Square Footage

Main Level	2707 Sq. Ft.
Total Finished Area	2707 Sq. Ft.

### Exterior Dimensions

Width	67' 0"
Depth	71' 0"

### Default Construction Stats

*Stats are unique to the individual plan.*

Foundation Type	Basement
Exterior Wall Construction	2x4
Roof Pitches	10/12 Primary, 12/12 6/12 Secondary

Foundation Wall Height	9'
Main Wall Height	9'
Second Wall Height	8'

## Plan Description

This beautiful ranch plan exudes the Modern Farmhouse style with a mixture of board and batten siding, metal roof, and a large front covered porch. Immediately on the inside of the house, you'll see the formal dining room that has exposed wood beams. The dining room accesses the great room through a magnificent glass wine cellar. The great room is warmed by a fireplace and includes a built-in bookshelf. The kitchen is well fitted with a large kitchen island and a walk-in pantry. The master suite is separated from the other bedrooms by the main living area. The master suite featured a fireplace, his/her vanities and a large walk-in closet with an island. On the other side of the house, you will find 3 bedrooms. Bedrooms 3 and 4 share a Jack and Jill bathroom while bedroom 2 enjoys its own bathroom. Each bedroom includes a walk-in closet. Upstairs you will find a large bonus room with a bathroom. Optional Bonus room adds 447 sq.ft.