

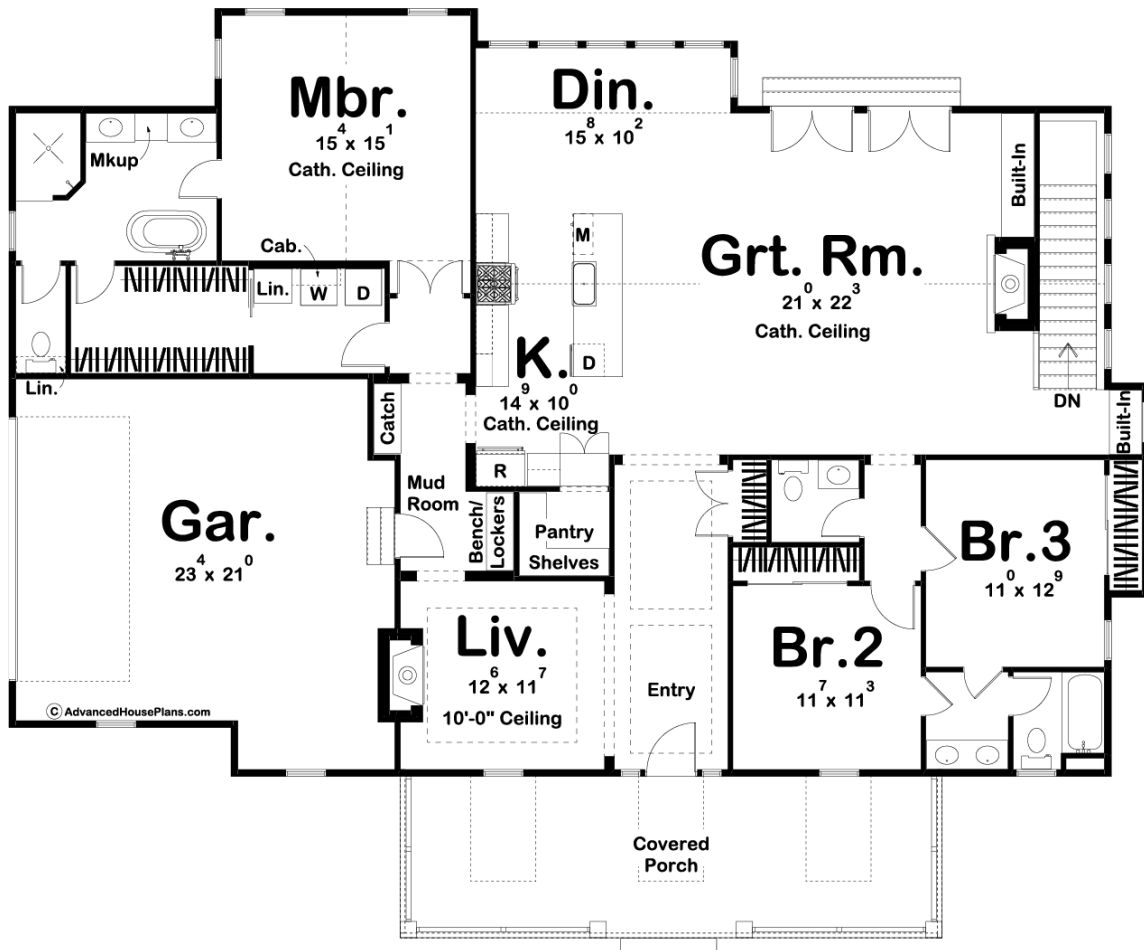

29806 - Hattiesburg Data Sheet

2390 SQ FT	3 BEDS	3 BATHS	2 BAYS	70' 0" WIDE	57' 0" DEEP
---------------	-----------	------------	-----------	----------------	----------------



Construction Specs

Layout

Bedrooms

Bathrooms	3
Garage Bays	2
Square Footage	
Main Level	2390 Sq. Ft.
Garage	532 Sq. Ft.
Total Finished Area	2390 Sq. Ft.
Exterior Dimensions	
Width	70' 0"
Depth	57' 0"
Default Construction Stats	
<i>Stats are unique to the individual plan.</i>	
Foundation Type	Basement
Exterior Wall Construction	2x4
Roof Pitches	6/12 Primary
Foundation Wall Height	9'
Main Wall Height	9'

Plan Description

The Hattiesburg plan is a beautiful Southern-style ranch masterpiece. The exterior exudes southern charm with its 3 dormers and large covered front porch. Once you step inside the home, you'll see just what makes this plan so special. You'll find yourself standing in a beautiful large entryway, greeted by a wonderful living room that is warmed by a fireplace. As you continue walking through the entry, you will walk into a great open layout of the main living areas. The great room and kitchen lie under a soaring cathedral ceiling. The great room is also warmed by a fireplace that is next to a convenient built-in bookshelf. Double french doors lead from the Great Room out to the home's back yard. The stunning kitchen includes a large work island and a walk-in pantry. The large dining room lies next to the kitchen to complete the living areas. The master suite in the Hattiesburg is sure to amaze. The massive master bedroom has its own soaring cathedral ceiling. The master bathroom includes his/her vanities, a wonderful makeup counter, a soaking tub, an enclosed toilet, and a walk-in shower. The home's large master closet has convenient access to the laundry room. On the opposite side of the home, bedrooms 2 and 3 share a jack and jill bathroom. The home's side load 2 car garage accesses the home through a convenient mudroom that includes a bench, locker, and a catch-all.