

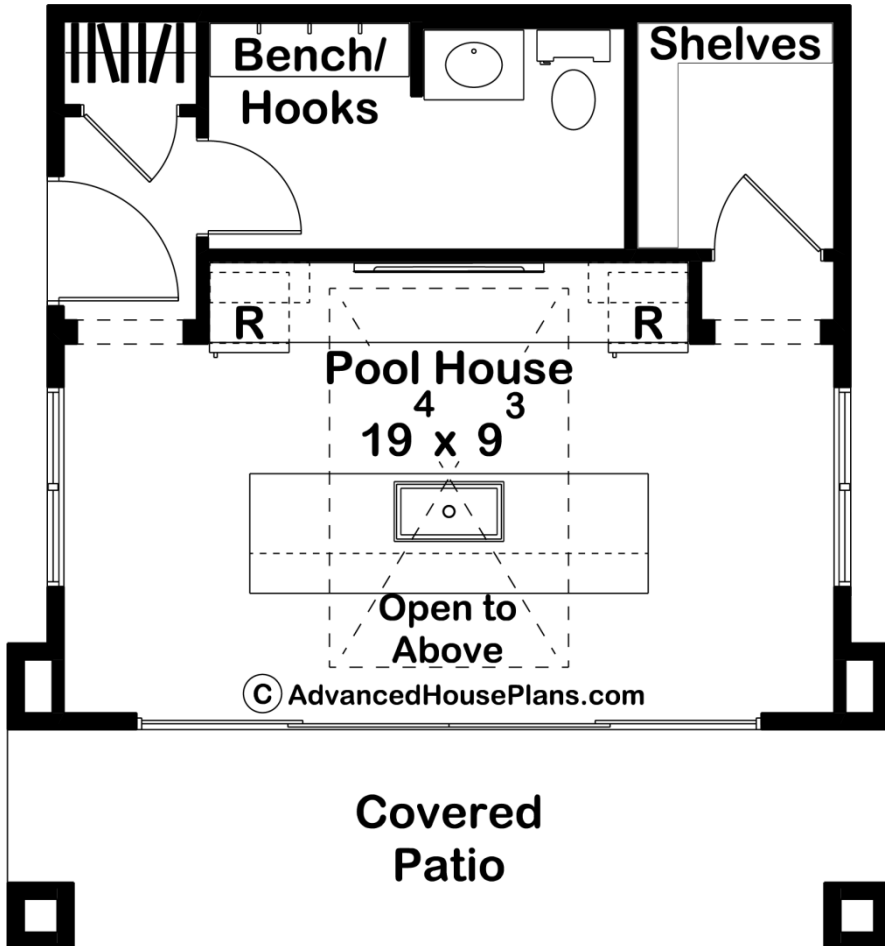

29929 - Harmon Data Sheet

| | | | | | |
|--------------|-----------|------------|-----------|----------------|----------------|
| 364 SQ FT | 0 BEDS | 1 BATHS | 0 BAYS | 22' 0" WIDE | 23' 6" DEEP |
|--------------|-----------|------------|-----------|----------------|----------------|



Construction Specs

Layout

Bathrooms

Square Footage

| | |
|---------------------|-------------|
| Main Level | 364 Sq. Ft. |
| Covered Area | 123 Sq. Ft. |
| Total Finished Area | 364 Sq. Ft. |

Exterior Dimensions

| | |
|-------|--------|
| Width | 22' 0" |
| Depth | 23' 6" |

Default Construction Stats

Stats are unique to the individual plan.

| | |
|----------------------------|--------------|
| Foundation Type | Slab |
| Exterior Wall Construction | 2x4 |
| Roof Pitches | 6/12 Primary |
| Main Wall Height | 9' |

Plan Description

This pool house design is great for any pool owner. The Harmon welcomes all with a large patio door and a covered area. The covered patio is great for entertaining when the sun reaches its peak. Inside lies a kitchen equipped with a sink for all your prepping needs and multiple refrigerators to keep your drinks cool. The tower above gives a spacious feel with tall ceiling heights. Across the snack bar island is a 4 wide patio door great for bringing the outdoors inside! This simple pool house design provides everything you need including a storage space for all pool equipment, including floaties!