

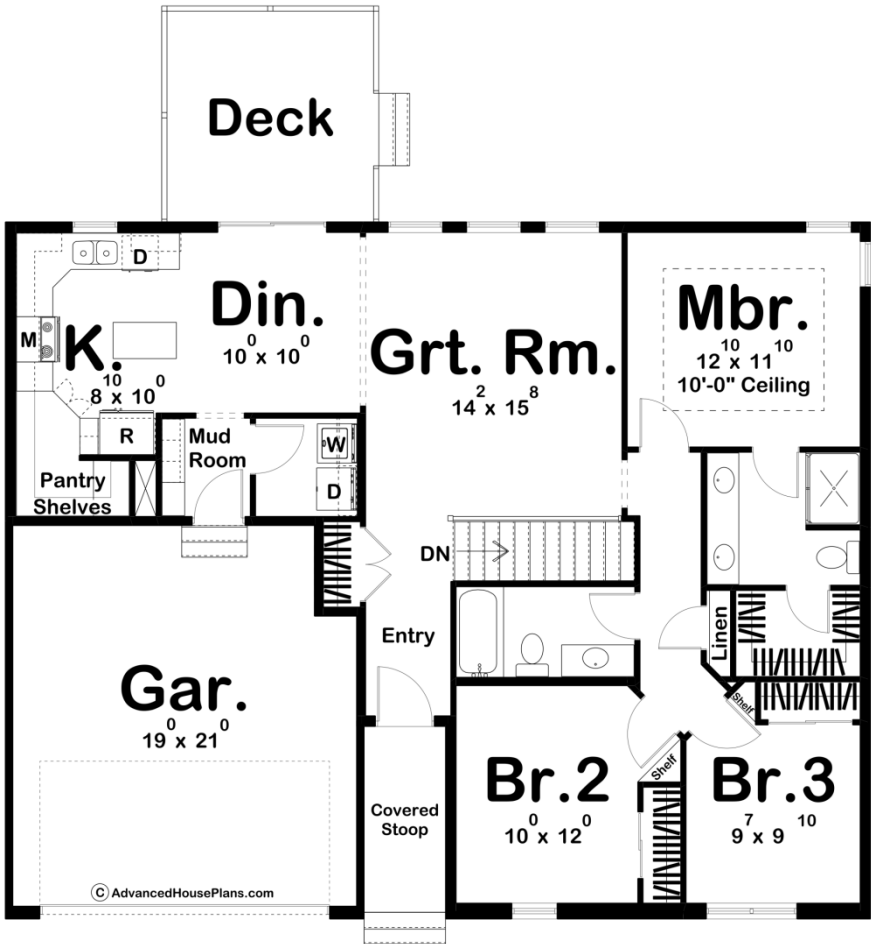

30106 - Crofton Data Sheet

|               |           |            |           |                |                |
|---------------|-----------|------------|-----------|----------------|----------------|
| 1353<br>SQ FT | 3<br>BEDS | 2<br>BATHS | 2<br>BAYS | 47' 8"<br>WIDE | 50' 0"<br>DEEP |
|---------------|-----------|------------|-----------|----------------|----------------|



Construction Specs

|        |
|--------|
| Layout |
|--------|

Bedrooms

|   |              |
|---|--------------|
| Bathrooms                                       | 2            |
| Garage Bays                                     | 2            |
| <b>Square Footage</b>                           |              |
| Main Level                                      | 1353 Sq. Ft. |
| Garage  | 405 Sq. Ft.  |
| Total Finished Area                             | 1353 Sq. Ft. |
| <b>Exterior Dimensions</b>                      |              |
| Width   | 47' 8"       |
| Depth   | 50' 0"       |
| <b>Default Construction Stats</b>               |              |
| <i>Stats are unique to the individual plan.</i> |              |
| Foundation Type                                 | Basement     |
| Exterior Wall Construction                      | 2x4          |
| Roof Pitches                                    | 8/12 Primary |
| Foundation Wall Height                          | 9'           |
| Main Wall Height                                | 9'           |

## Plan Description

The Crofton plan makes great use of it's small space to create a fantastic simple house. As you walk through the entryway you will see a large great room with a windows to the rear of the home. The dining room flows into a beautiful kitchen with an island and a walk in pantry. On the right side of the home you will find a wonderful master suite complete with his/her vanities, a walk in shower and a walk in closet. Bedrooms 2 and 3 share a centrally located hall bathroom. The house is also accessible from the 2 car garage through a simple and practical mudroom with lockers. This house is sure to impress at it's small 1353 sq. ft. footprint.