

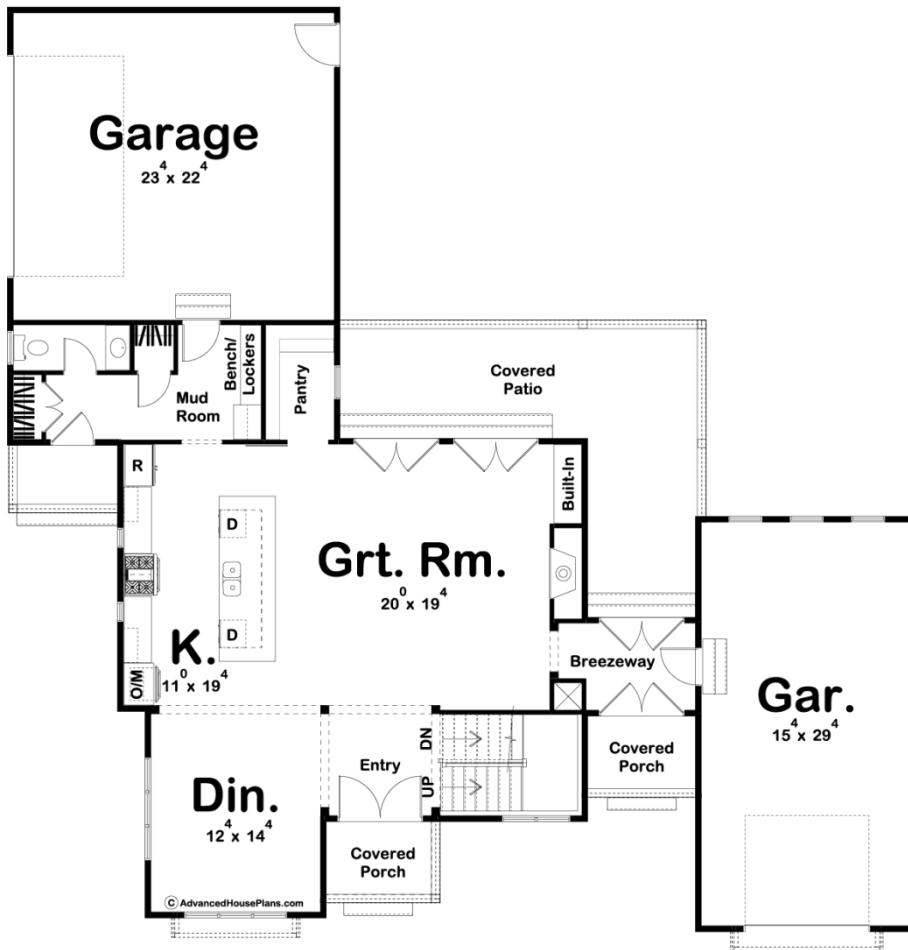

29777 - Crawford Farm Data Sheet

2771 SQ FT	4 BEDS	4 BATHS	3 BAYS	66' 0" WIDE	68' 6" DEEP
---------------	-----------	------------	-----------	----------------	----------------

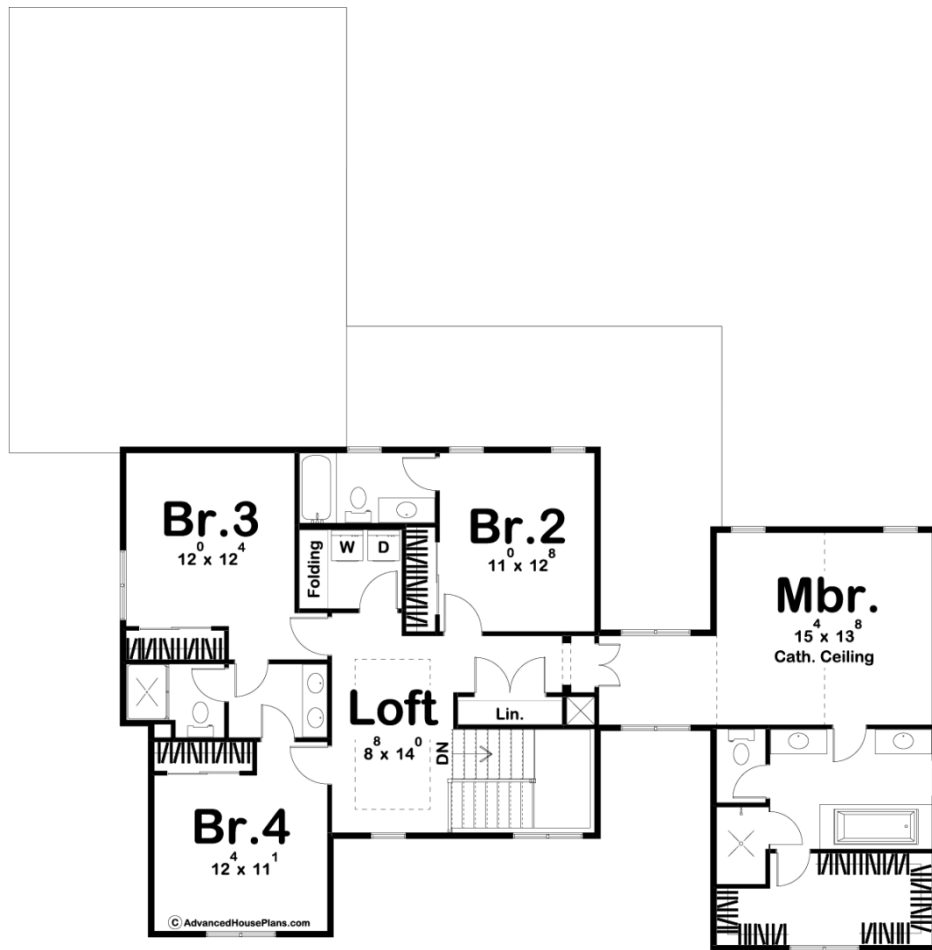



Construction Specs

Layout

Bedrooms	4
Bathrooms	4
Garage Bays	3

Square Footage

Main Level	1298 Sq. Ft.
Second Level	1473 Sq. Ft.
Garage	1024 Sq. Ft.
Total Finished Area	2771 Sq. Ft.

Exterior Dimensions

Width	66' 0"
Depth	68' 6"

Default Construction Stats

Stats are unique to the individual plan.

Foundation Type	Basement
-----------------	----------

Exterior Wall Construction	2x4
Roof Pitches	8/12 Primary, 4/12 6/12 Secondary
Foundation Wall Height	9'
Main Wall Height	9'
Second Wall Height	8'

Plan Description

Our Crawford Farm plan is a dream for Modern Farmhouse lovers. The exterior board and batten siding combined with wood accents give this home excellent curb appeal. As you walk through the entryway's french doors, an immediate impression will be made by this home's wide-open floor plan. An amazing formal dining room, which is perfect for large family dinners, lies on the left side of the entry. Your family will enjoy relaxing in the massive great room that is warmed by a fireplace that has a wonderful built-in bookshelf. The home's kitchen is a dream for anyone who loves to cook. The island has a wrap-around snack bar and includes 2 dishwashers. The kitchen also includes a large walk-in pantry. Upstairs you will find the home's bedrooms. The master suite is separated from the other 3 bedrooms for privacy. The master bedroom lies under a soaring cathedral ceiling. The master bathroom includes his/her vanities and a soaking tub that's perfect for relaxing after long days. There is also a large walk-in closet in the master suite. Bedroom 2 has its own bathroom while bedrooms 3 and 4 share a Hollywood bathroom. An amazing loft area upstairs makes a great place for the kids to play. Back on the home's main floor, the 2 car garage accesses the home through a convenient mudroom that has a bench and lockers. The homes split 1 car garage accesses the home through a breezeway.