

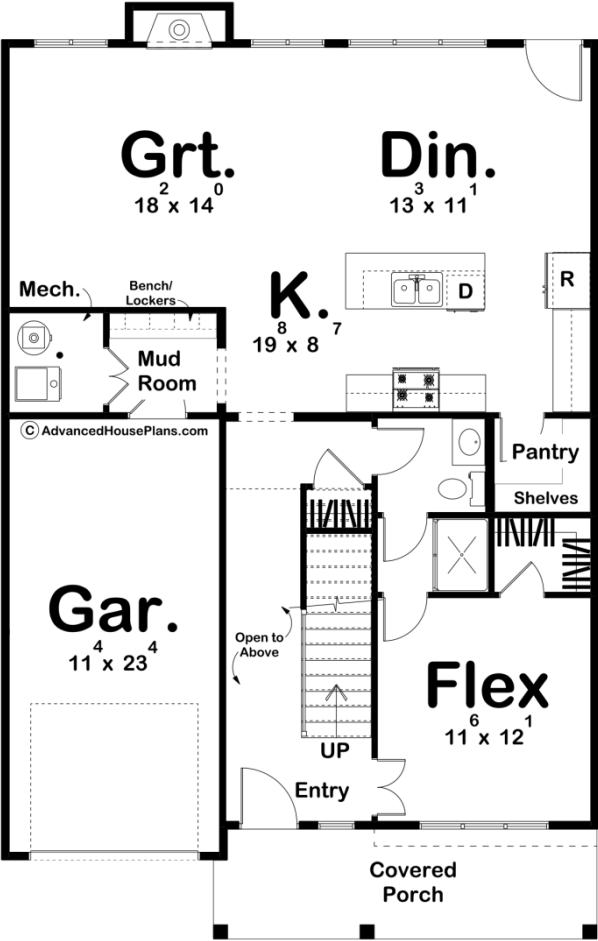

30246 - Crandall Data Sheet

2177 SQ FT	3 BEDS	3 BATHS	1 BAYS	32' 0" WIDE	50' 4" DEEP
---------------	-----------	------------	-----------	----------------	----------------

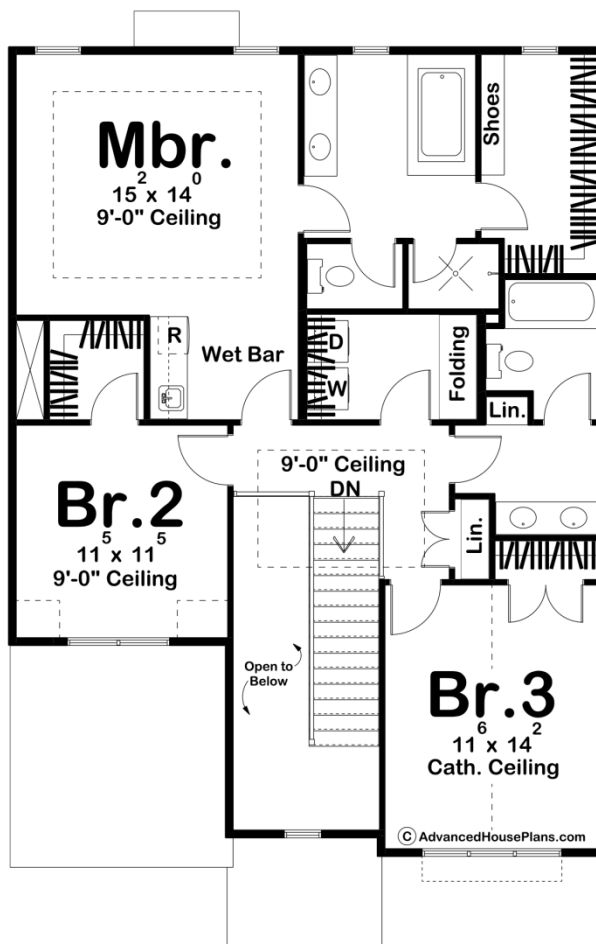



Construction Specs

Layout

Bedrooms	3
Bathrooms	3
Garage Bays	1

Square Footage

Main Level	1071 Sq. Ft.
Second Level	1106 Sq. Ft.
Covered Area	123 Sq. Ft.
Garage	277 Sq. Ft.
Total Finished Area	2177 Sq. Ft.

Exterior Dimensions

Width	32' 0"
Depth	50' 4"

Default Construction Stats

Stats are unique to the individual plan.

Foundation Type	Slab
Exterior Wall Construction	2x4
Roof Pitches	Primary 10/12, Secondary 6/12, 4/12
Main Wall Height	9'
Second Wall Height	8'

Plan Description

To see this plan in duplex form, head over to our Abilene plan. The Crandall plan is a modern farmhouse style house plan that is a perfect fit for those who want the traditional farmhouse look. The board and batten siding, gorgeous covered porch, and the mix of dark and wood accents makes this a textbook farmhouse, yet still different from all the others. This house plan is complete with a one-car garage that leads directly into a mudroom. The covered porch goes into an entryway hallway that leads the eyes straight down to the kitchen. The kitchen provides a walk-in pantry, plenty of counter space, and a kitchen island. Being open concept allows for a great space for entertaining, as the kitchen is open to the dining and great room. Head back down the hall to find a full bath, flex space, and stairs to take you upstairs. Upstairs are the additional bedrooms, laundry room, and bathrooms. Bedrooms two and three share a hallway Hollywood bath. The master suite is also found here, with an entrance that provides a wet bar and 9' ceiling. Head through the bedroom to find the bathroom, complete with double vanities, a soaking tub, separate toilet and shower areas, and a spacious walk-in closet with a built-in shelf for shoes.