

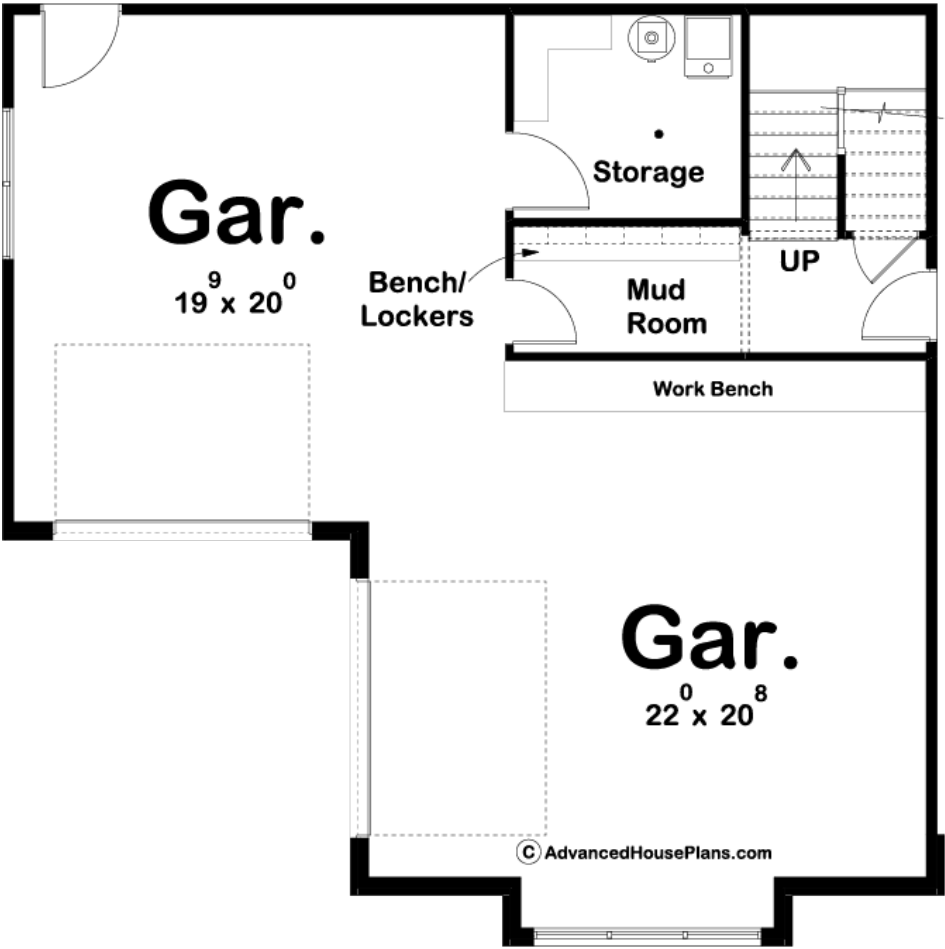

29737 - Copper Creek Data Sheet

1077 SQ FT	1 BEDS	1 BATHS	2 BAYS	37' 0" WIDE	37' 0" DEEP
---------------	-----------	------------	-----------	----------------	----------------

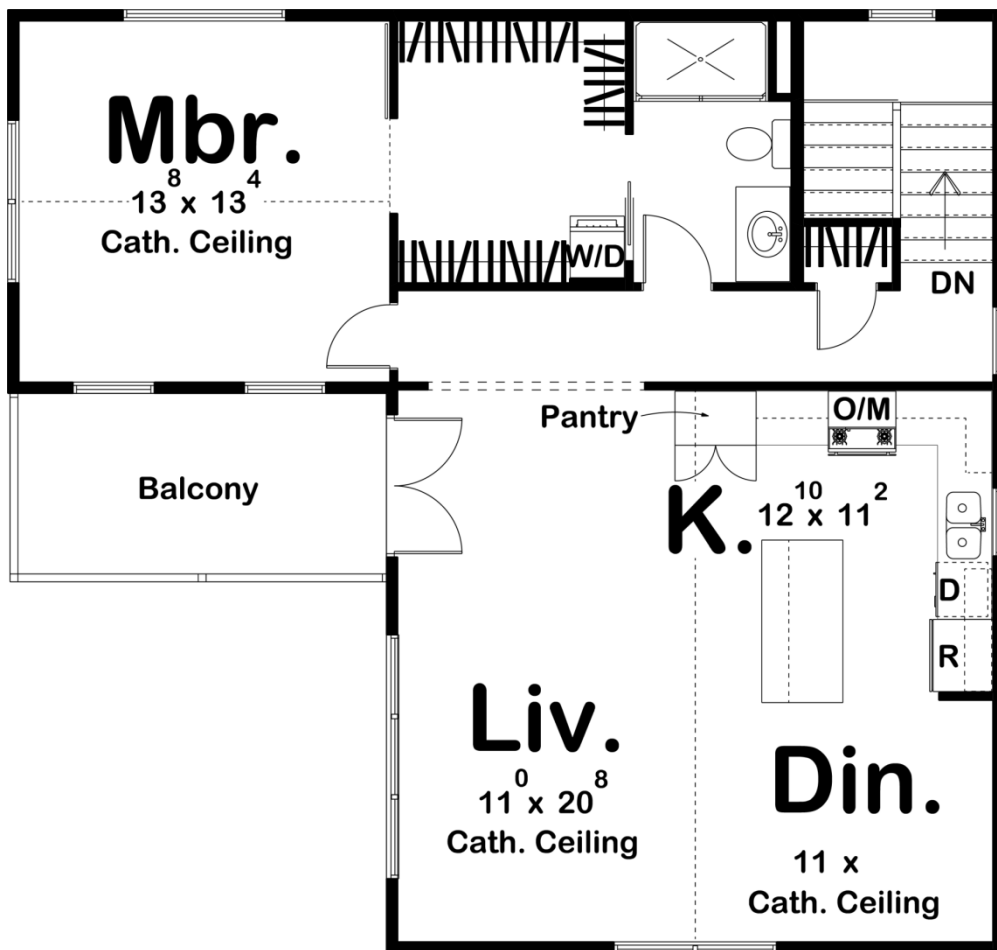



## Construction Specs

### Layout

Bedrooms	1
Bathrooms	1
Garage Bays	2

### Square Footage

Main Level	153 Sq. Ft.
Second Level	924 Sq. Ft.
Garage	852 Sq. Ft.
Total Finished Area	1077 Sq. Ft.

### Exterior Dimensions

Width	37' 0"
Depth	37' 0"

### Default Construction Stats

*Stats are unique to the individual plan.*

Foundation Type	Slab
-----------------	------

Exterior Wall Construction	2x4
Roof Pitches	8/12 Primary, 6/12 Secondary
Main Wall Height	9'
Second Wall Height	9'

## Plan Description

The courtyard split garage gives the Copper Creek the appearance of a home but the functionality of an apartment garage. On the outside, a beautiful blend of siding, brick, wood, and metal roofing gives this plan great curb appeal. On the main level, there is ample work space with a built-in workbench. There is also a useful storage closet with built-in shelves and a mudroom that includes a bench/lockers. Upstairs, you will find a functional 1 bedroom apartment. The family room, kitchen, and dining room lie under a soaring cathedral ceiling to make the living area feel open. The kitchen includes a large kitchen island with a snack bar and a pantry. Just off the family room is a beautiful balcony that is accessed through french doors. The master suite includes a large walk-through closet that has its own access to the apartment's bathroom.