

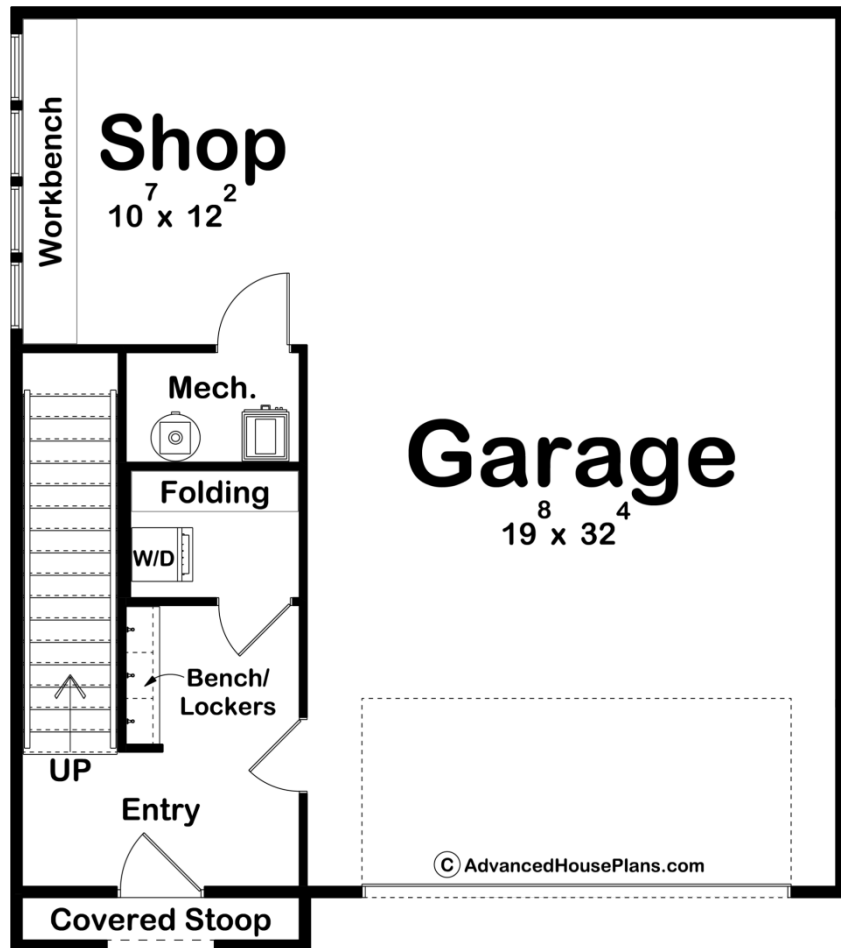

### 30154 - Colter Bay Data Sheet

802 SQ FT	1 BEDS	1 BATHS	2 BAYS	31' 0" WIDE	35' 0" DEEP
--------------	-----------	------------	-----------	----------------	----------------

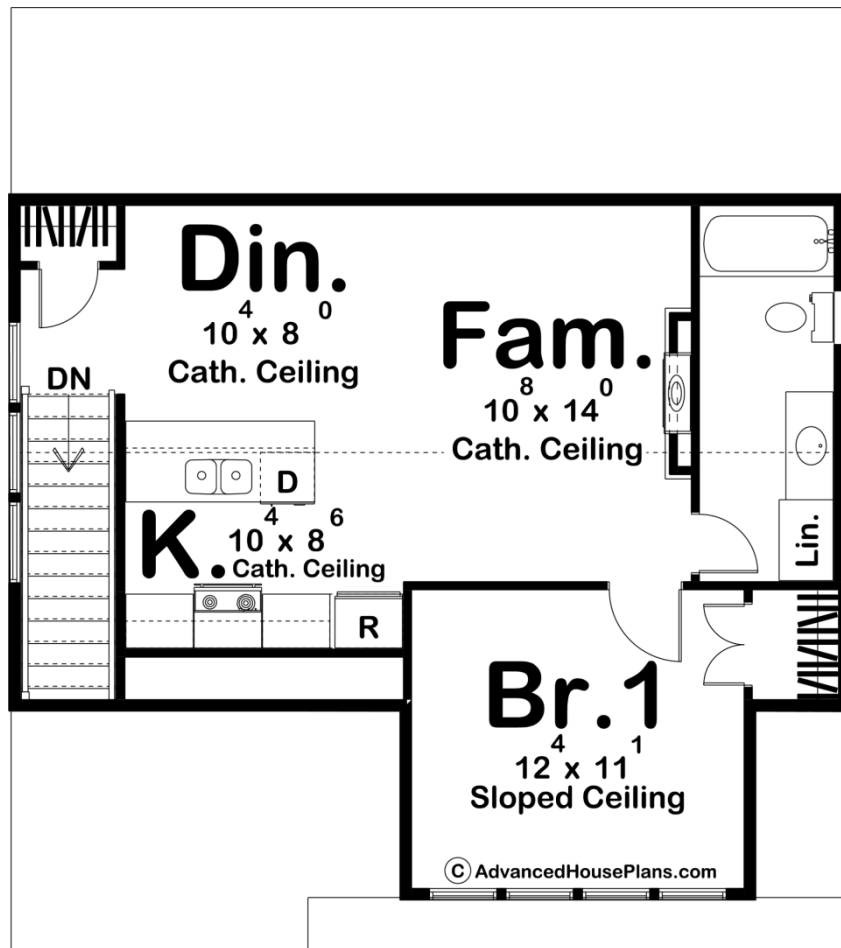



## Construction Specs

### Layout

Bedrooms	1
Bathrooms	1
Garage Bays	2

### Square Footage

Main Level	188 Sq. Ft.
Second Level	614 Sq. Ft.
Garage	807 Sq. Ft.
Total Finished Area	802 Sq. Ft.

### Exterior Dimensions

Width	31' 0"
Depth	35' 0"

### Default Construction Stats

*Stats are unique to the individual plan.*

Foundation Type	Slab
-----------------	------

Exterior Wall Construction	2x4
Roof Pitches	12/12 Primary, 5/12 14/12 Secondary
Main Wall Height	9'
Second Wall Height	6'

## Plan Description

The Colter Bay plan is a wonderful Modern Cottage style carriage house plan. The outside of this charming home is highlighted by steep rooflines, dark painted brick, wood garage doors, and stucco siding. The bottom level includes an oversized garage with a workshop and a built-in workbench. The mudroom/entry features a bench, lockers, and access to the laundry room. Above the garage, you'll find an amazing 1 bedroom apartment. The main living area is laid out in an open floor plan. The full kitchen includes a large island with a snack bar. The bedroom shares a centrally located bathroom with the main living area.