

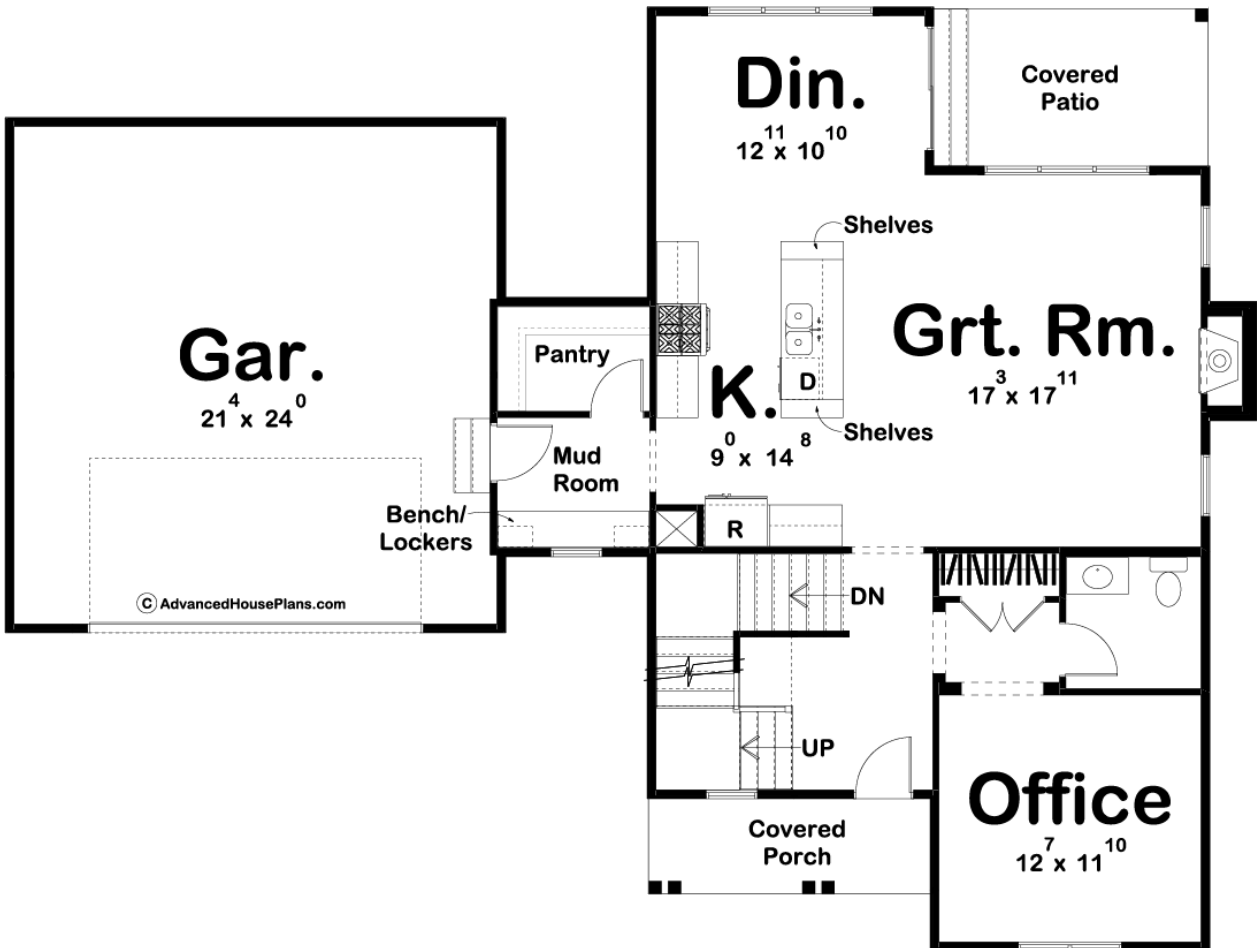

**29642 - Collins Data Sheet**

1994 SQ FT	3 BEDS	3 BATHS	2 BAYS	60' 0" WIDE	45' 4" DEEP
---------------	-----------	------------	-----------	----------------	----------------

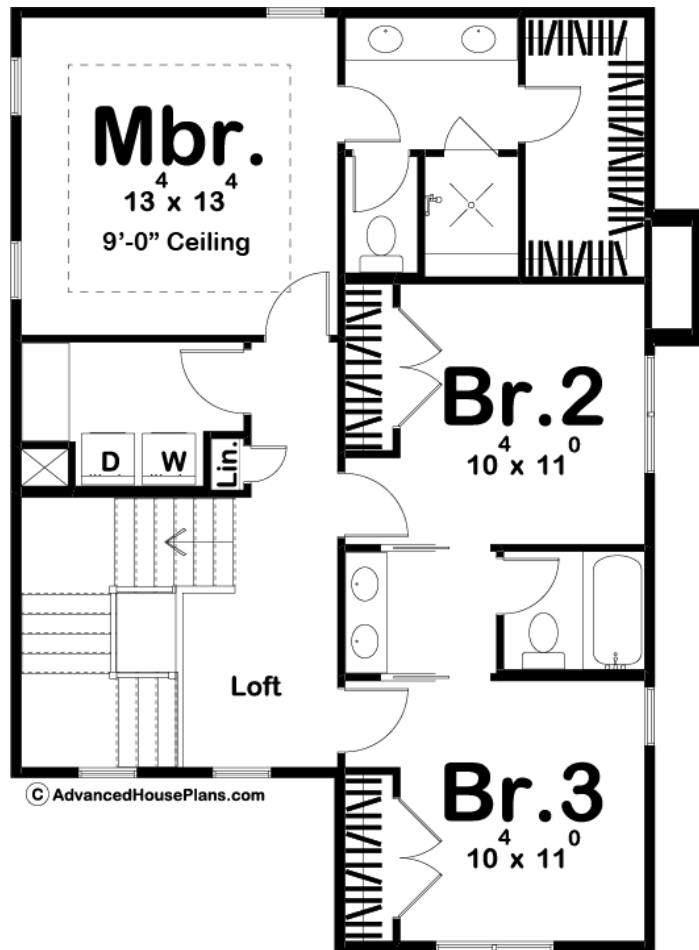



## Construction Specs

### Layout

Bedrooms	3
Bathrooms	3
Garage Bays	2

### Square Footage

Main Level	1112 Sq. Ft.
Second Level	882 Sq. Ft.
Total Finished Area	1994 Sq. Ft.

### Exterior Dimensions

Width	60' 0"
Depth	45' 4"
Ridge Height <i>Calculated from main floor line</i>	32'

### Default Construction Stats

*Stats are unique to the individual plan.*

Foundation Type	Basement
Exterior Wall Construction	2x4
Roof Pitches	8/12 Primary, 12/12 4/12 Secondary
Foundation Wall Height	9'
Main Wall Height	9'
Second Wall Height	8'

## Plan Description

This beautifully configured Modern Farmhouse plan offers an open efficient floor plan. On the outside, board and batten siding and a covered porch put on a striking display of curb appeal. Just inside, you'll be amazed at the open floor plan including a magnificent great room, which is warmed by a fireplace and flows into the open kitchen and dining room. The kitchen boasts a spacious island with a breakfast bar. Just beyond the dining room, a covered patio extends entertaining options. Upstairs, the master suite enjoys an efficient bath, complete with a compartmented toilet, walk-in shower, dual vanities, and a large walk-in closet. Bedrooms 2 and 3 share a convenient Jack and Jill bathroom. Back on the main floor, the large 2 car garage accesses the home through a convenient mudroom complete with a bench and lockers.