

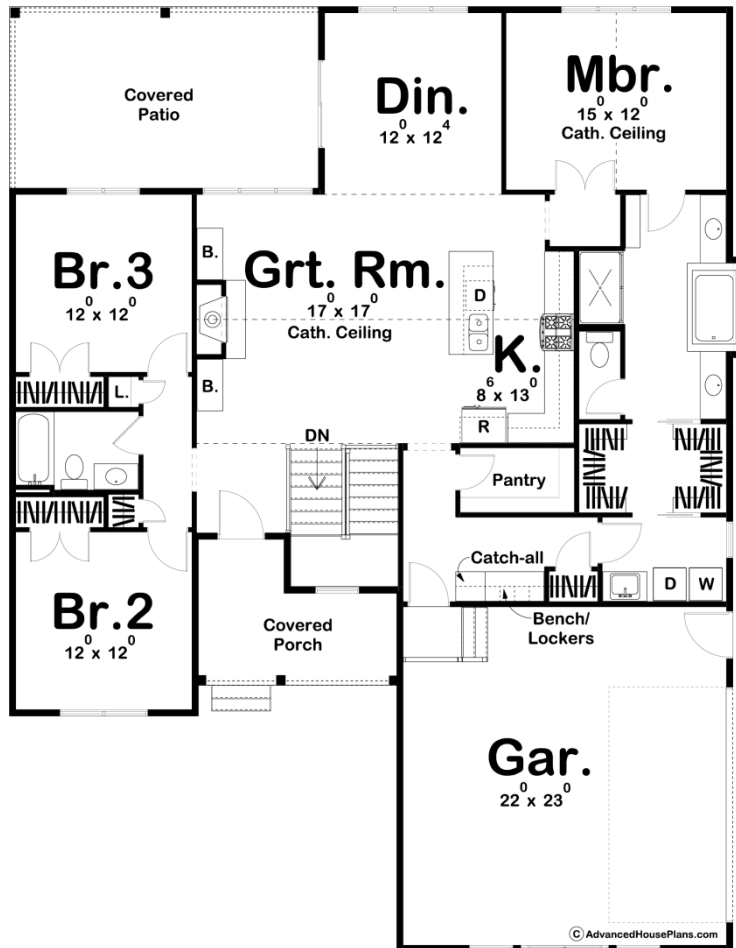

29678 - Cherry Creek Data Sheet

1797 SQ FT	3 BEDS	2 BATHS	2 BAYS	49' 0" WIDE	64' 0" DEEP
---------------	-----------	------------	-----------	----------------	----------------



Construction Specs

Layout

Bedrooms

Bathrooms	2
-----------	---

Garage Bays	2
-------------	---

Square Footage

Main Level	1797 Sq. Ft.
------------	--------------

Garage	529 Sq. Ft.
--------	-------------

Total Finished Area	1797 Sq. Ft.
---------------------	--------------

Exterior Dimensions

Width	49' 0"
-------	--------

Depth	64' 0"
-------	--------

Default Construction Stats

Stats are unique to the individual plan.

Foundation Type	Basement
-----------------	----------

Exterior Wall Construction	2x4
----------------------------	-----

Roof Pitches	12/12 Primary, 8/12 4/12 Secondary
--------------	------------------------------------

Foundation Wall Height	9'
------------------------	----

Main Wall Height	9'
------------------	----

Plan Description

An appealing front porch and board and batten siding gives this 1 story Modern Farmhouse plan unique charm. Inside, guests are welcomed by a cathedral ceiling and a fireplace in the open great room/kitchen concept. The L-shaped kitchen and island adjoin the dining area, which opens onto a rear covered patio, where guests can mingle before dinner is served. A generously sized master suite is tucked away for privacy behind the kitchen and includes a cathedral ceiling. The well-appointed master bath includes a large whirlpool tub, shower, compartmented toilet and walk-in closet with access to the laundry room. Two additional bedrooms occupy this 1 story house plan, Bedroom 3 offers a birds-eye view of the covered porch outside. This 1 story house plan also features a 2 car side load garage.