

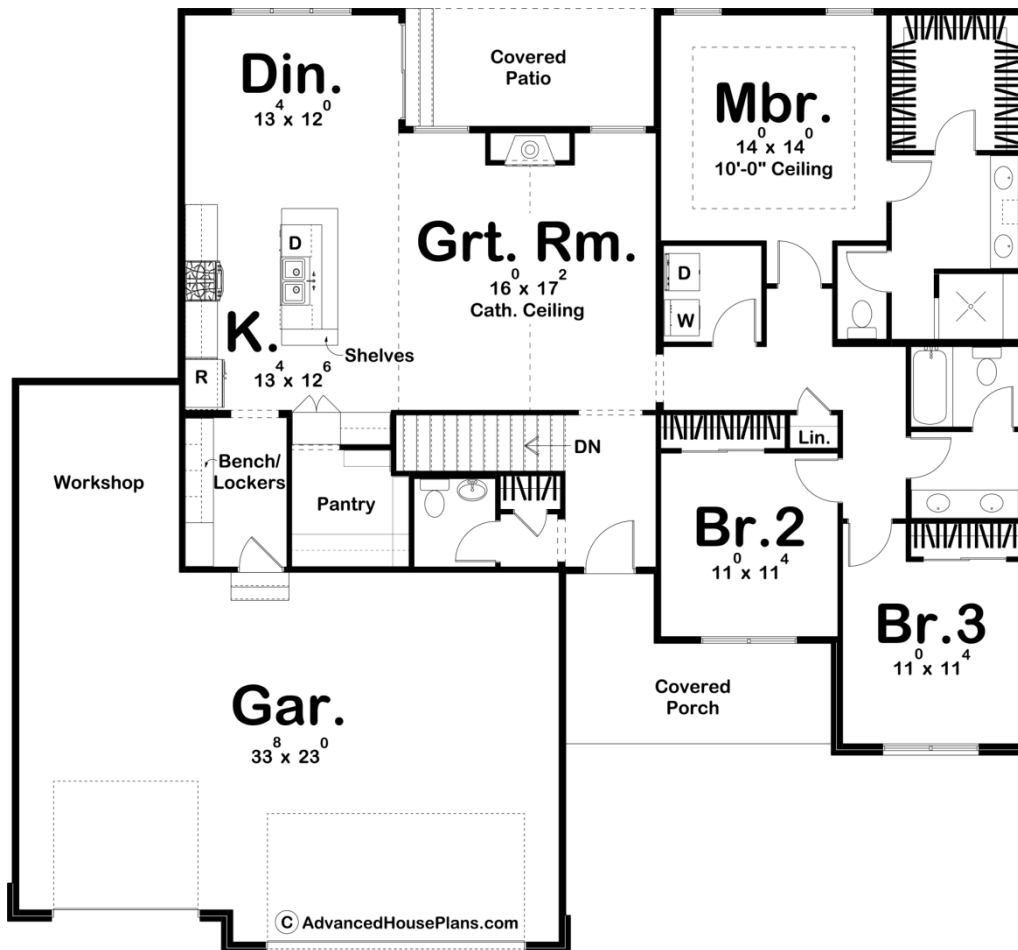

29639 - Caroline Data Sheet

1906 SQ FT	3 BEDS	3 BATHS	3 BAYS	63' 0" WIDE	59' 0" DEEP
---------------	-----------	------------	-----------	----------------	----------------



Construction Specs

Layout

Bedrooms

Bathrooms	3
-----------	---

Garage Bays	3
-------------	---

Square Footage

Main Level	1906 Sq. Ft.
------------	--------------

Garage	899 Sq. Ft.
--------	-------------

Total Finished Area	1906 Sq. Ft.
---------------------	--------------

Exterior Dimensions

Width	63' 0"
-------	--------

Depth	59' 0"
-------	--------

Ridge Height	24'
--------------	-----

Calculated from main floor line

Default Construction Stats

Stats are unique to the individual plan.

Foundation Type	Basement
-----------------	----------

Exterior Wall Construction	2x4
----------------------------	-----

Roof Pitches	8/12 Primary, 6/12 Secondary
--------------	------------------------------

Foundation Wall Height	9'
------------------------	----

Main Wall Height	9'
------------------	----

Plan Description

A covered front porch and a pair of gables establish a sense of comfort on this 1,906 sq. ft., 1-story house plan. Inside, a few steps bring guests into the great room, with its fireplace, views to the rear and boundary-defining cathedral ceiling. The kitchen and dining area lie open to the great room for comfortable entertaining. The kitchen itself is well-appointed, with an island work station, generous counter space, and a walk-in pantry. The dining area accesses the covered patio through sliding doors. Just off the kitchen, a mud room with bench and lockers accesses the home's 3-car, front-load garage. All sleeping quarters reside on the other side of the home, where the master suite is tucked away for privacy. Its bath area features his-and-her vanities, a compartmented toilet and a sizeable walk-in closet.

Bedrooms 2 and 3 are separated from the master suite for privacy. Both secondary bedrooms share a central hall bath that features a double sink vanity that lies outside the bath area.