

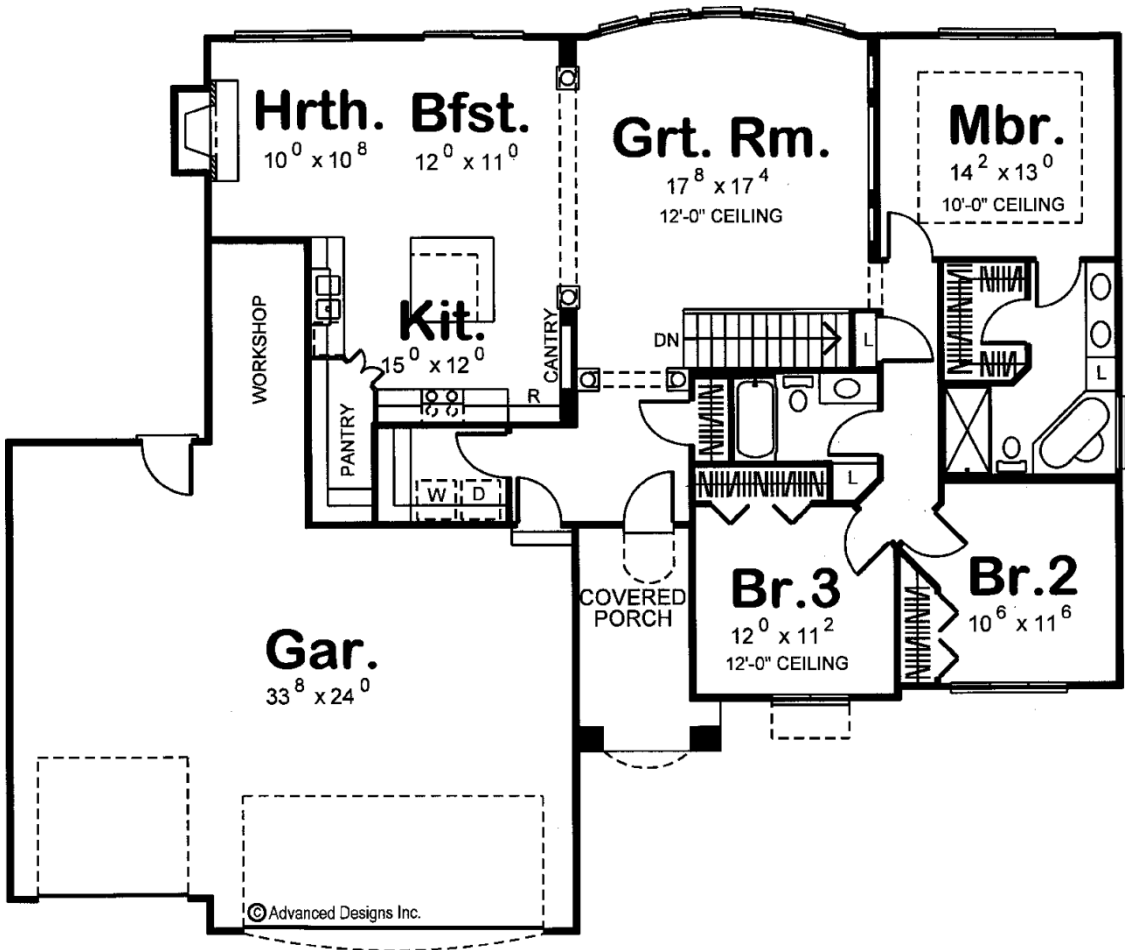

29124 - Campton Data Sheet

1780 SQ FT	3 BEDS	2 BATHS	3 BAYS	67' 0" WIDE	55' 0" DEEP
---------------	-----------	------------	-----------	----------------	----------------



Construction Specs

Layout

Bedrooms

Bathrooms	2
Garage Bays	3
<b>Square Footage</b>	
Main Level	1780 Sq. Ft.
Garage	948 Sq. Ft.
Total Finished Area	1780 Sq. Ft.
<b>Exterior Dimensions</b>	
Width	67' 0"
Depth	55' 0"
Ridge Height	21'
<i>Calculated from main floor line</i>	
<b>Default Construction Stats</b>	
<i>Stats are unique to the individual plan.</i>	
Foundation Type	Basement
Exterior Wall Construction	2x4
Roof Pitches	6/12 F-B, 10/12 S-S
Foundation Wall Height	9'
Main Wall Height	9'

## Plan Description

Classic detailing and a tasteful blend of exterior materials enhance the curb appeal of this traditional style, 1-story house plan. Just inside from the deep covered front porch, guests are greeted by views into the great room, with views to the rear through a bow of windows. The kitchen, breakfast area, and hearth room seamlessly extend this open space. The kitchen enjoys plenty of counter space, an island work station with breakfast bar, built-in cantry and walk-in pantry. On the other side of the home, the master suite includes a bath area with dual vanities, corner tub, and a walk-in closet. Bedrooms 2 and 3 are brightened with natural light through generous windows and share a central hall bath. The 3-car garage accesses the home just off the entry area and it includes a workshop area.