

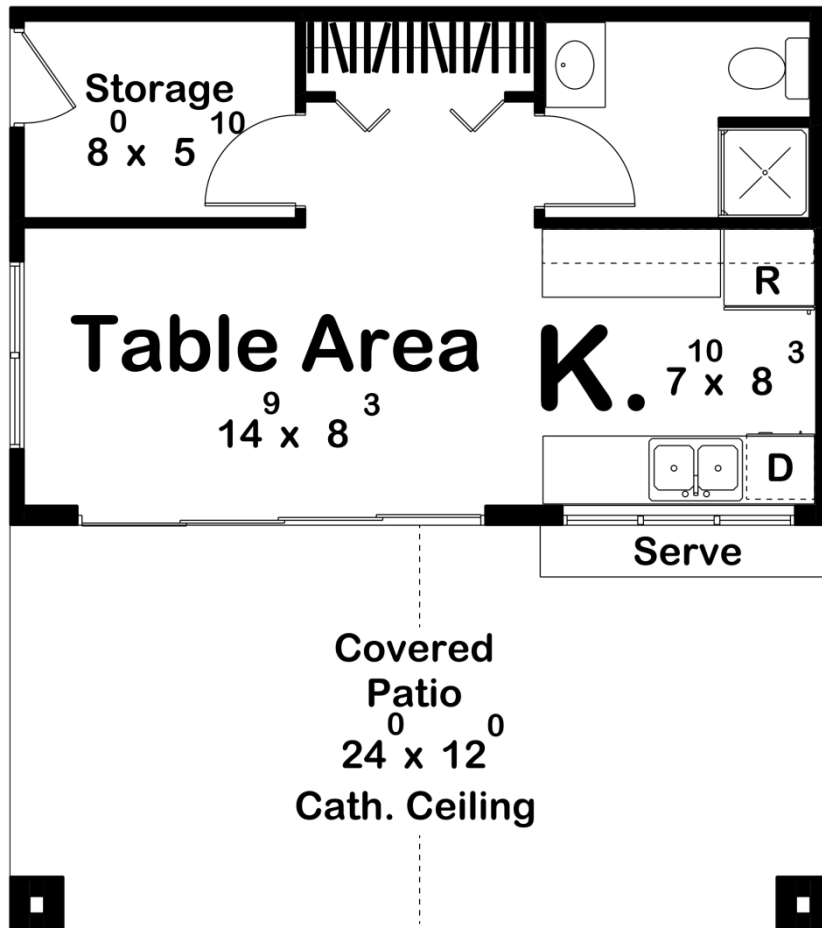

30157 - Bridges Bay Data Sheet

360 SQ FT	0 BEDS	1 BATHS	0 BAYS	24' 0" WIDE	15' 0" DEEP
--------------	-----------	------------	-----------	----------------	----------------



Construction Specs

Layout

Bathrooms

Square Footage

Main Level	360 Sq. Ft.
Covered Area	288 Sq. Ft.
Total Finished Area	360 Sq. Ft.

Exterior Dimensions

Width	24' 0"
Depth	15' 0"

Default Construction Stats

Stats are unique to the individual plan.

Foundation Type	Slab
Exterior Wall Construction	2x4
Roof Pitches	4/12 Primary
Main Wall Height	10'

Plan Description

The Bridges Bay pool house plan is a perfect addition for any pool owner. Decorative wood trusses and stone accents create an appealing look for the exterior. A large, covered patio accesses the interior through a large sliding glass door. Just inside the door is a large table area and kitchen. The kitchen includes a refrigerator and dishwasher. A full bathroom with a walk-in shower can be found inside as well.