

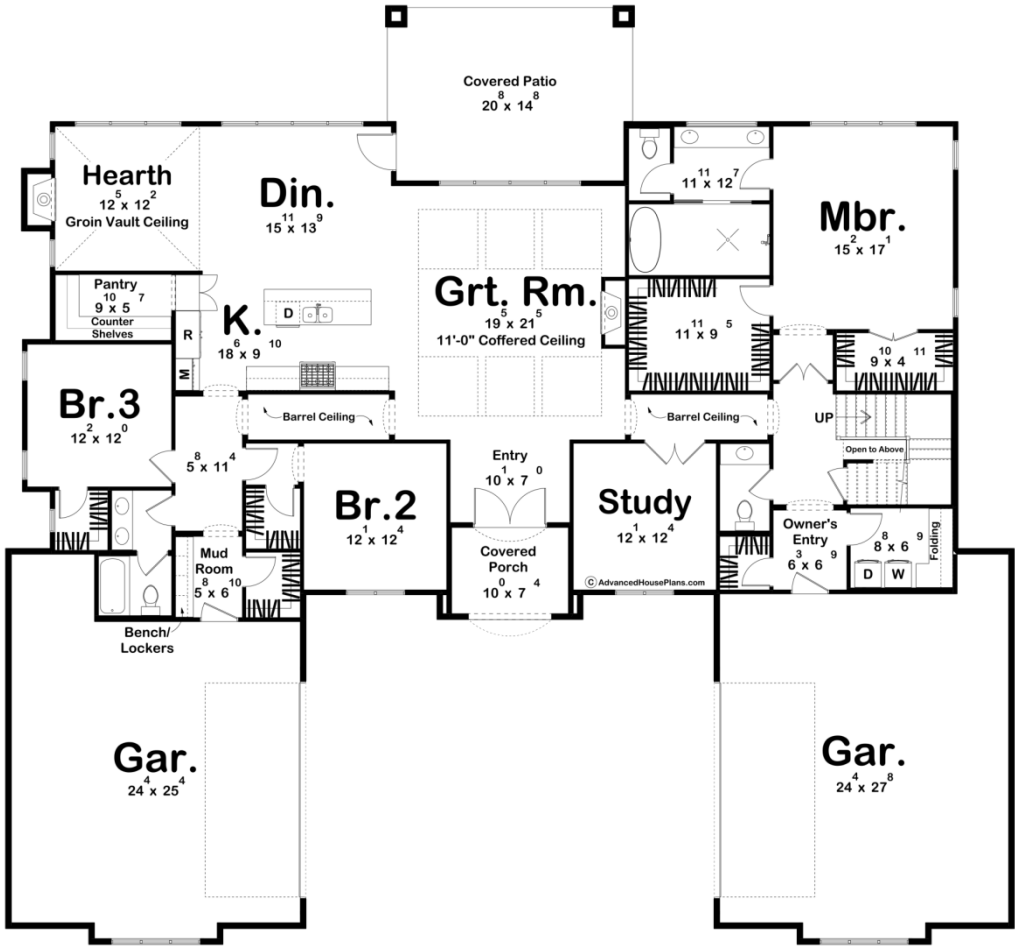

30298 - Blackwood Data Sheet

2938 SQ FT	3 BEDS	3 BATHS	4 BAYS	84' 8" WIDE	78' 8" DEEP
---------------	-----------	------------	-----------	----------------	----------------

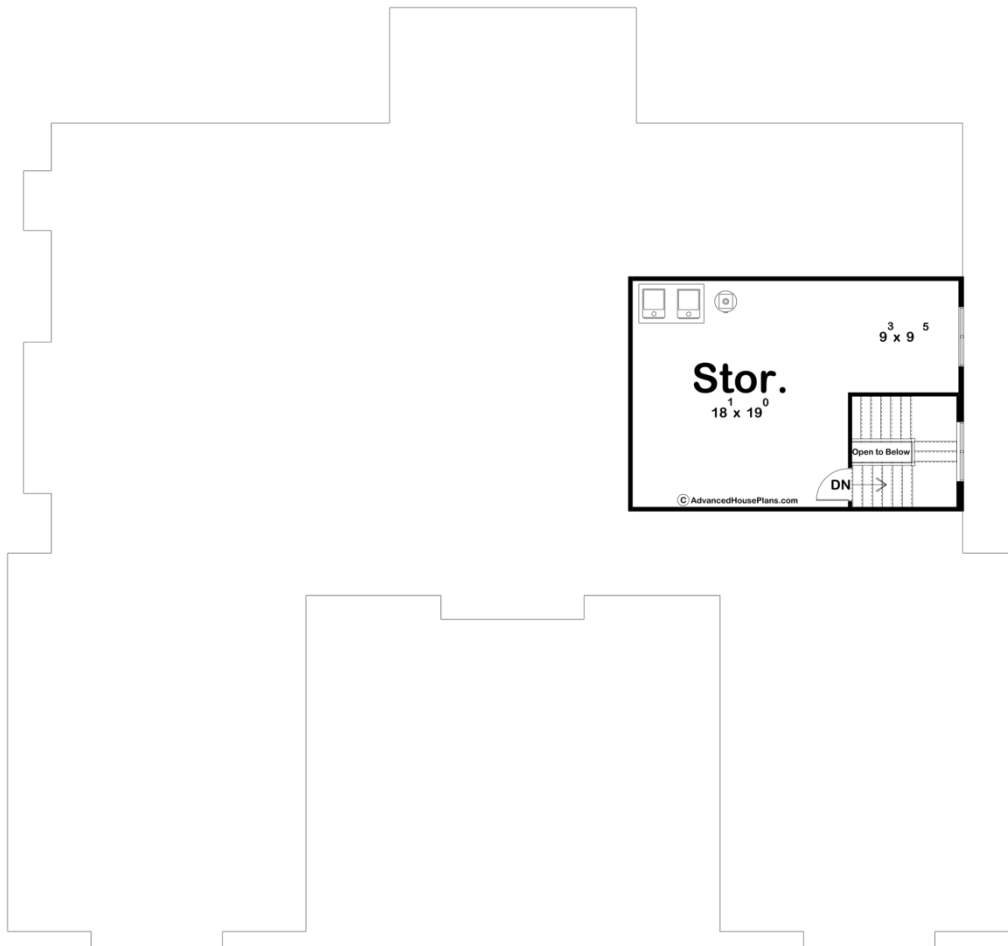



Construction Specs

Layout

Bedrooms	3
Bathrooms	3
Garage Bays	4

Square Footage

Main Level	2938 Sq. Ft.
Covered Area	376 Sq. Ft.
Garage	1429 Sq. Ft.
Total Finished Area	2938 Sq. Ft.

Exterior Dimensions

Width	84' 8"
Depth	78' 8"

Default Construction Stats

Stats are unique to the individual plan.

Foundation Type	Slab
-----------------	------

Exterior Wall Construction	2x4
Roof Pitches	Primary 10/12, Secondary 14/12, 4/12
Main Wall Height	10'

Plan Description

This Modern Cottage-style house plan features a timeless and balanced design, showcasing a brick exterior that exudes warmth and classic charm. The facade is adorned with wood shutters, adding a touch of traditional elegance to the overall aesthetic. On both sides of the house, spacious garages provide ample parking space while helping the home maintain a cohesive and harmonious look. Upon entering through the covered stoop, you are greeted by an open floor plan that seamlessly connects various living spaces. The hearth room serves as a cozy retreat, featuring a fireplace that adds both warmth and a touch of old-world charm to the interior. The layout emphasizes an openness that is great for entertaining. The master suite boasts his and hers closets, offering convenient and well-organized storage space. Ascending to the second level, you'll discover a dedicated storage room, providing additional space for belongings. Overall, this colonial-style house plan combines classic architectural elements with modern functionality, creating a welcoming and comfortable home for residents.