

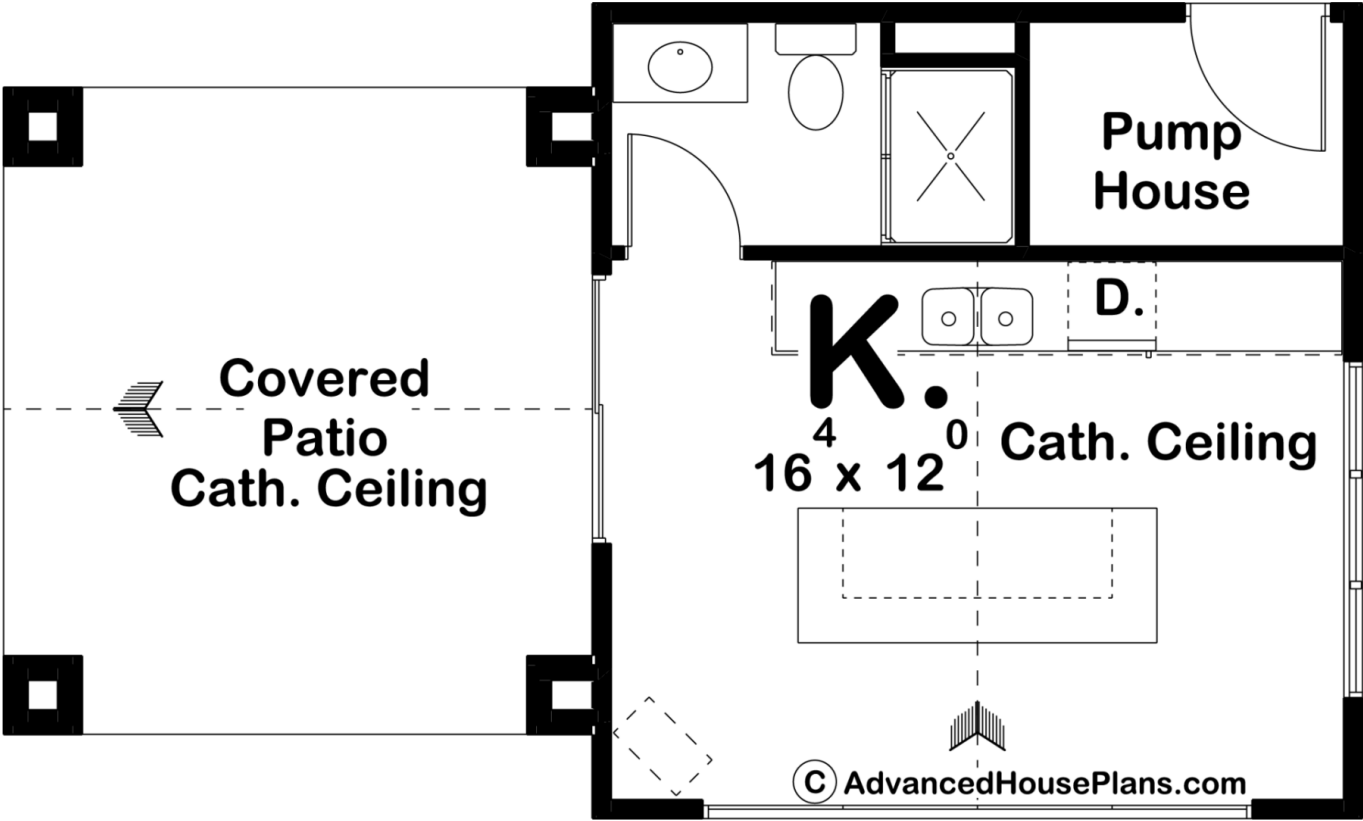

29432 - Birchwood Data Sheet

306 SQ FT	0 BEDS	1 BATHS	0 BAYS	30' 0" WIDE	18' 0" DEEP
--------------	-----------	------------	-----------	----------------	----------------



Construction Specs

Layout

Bathrooms

### Square Footage

Main Level	306 Sq. Ft.
Covered Area	182 Sq. Ft.
Total Finished Area	306 Sq. Ft.

### Exterior Dimensions

Width	30' 0"
Depth	18' 0"

### Default Construction Stats

*Stats are unique to the individual plan.*

Foundation Type	Slab
Exterior Wall Construction	2x4

## Plan Description

This pool house design is great for any pool owner. The Birchwood plan welcomes all with decorative wood trusses and bulky stone columns. Both gable ends make for a spacious feel with cathedral ceilings on the patio and in the kitchen. The covered patio is great for entertaining when the sun reaches its peak. The patio door provides an easy access to the 3/4 bath inside. Also inside lies a kitchen equipped with a sink for all your prepping needs and a dishwasher to make cleanup a breeze. Across the snack bar island is a 4 wide patio door great for bringing the outdoors inside! This simple pool house design provides everything you need including a storage space for all pool equipment, including floaties! Be sure to check out our other pool houses. As always any of our plans at Advanced House Plans can be customized to fit your needs with our alteration department. Whether you need to change the front elevation style, stretch it larger or just make the plan more affordable for your budget we can do that and more for you at Ahp.