

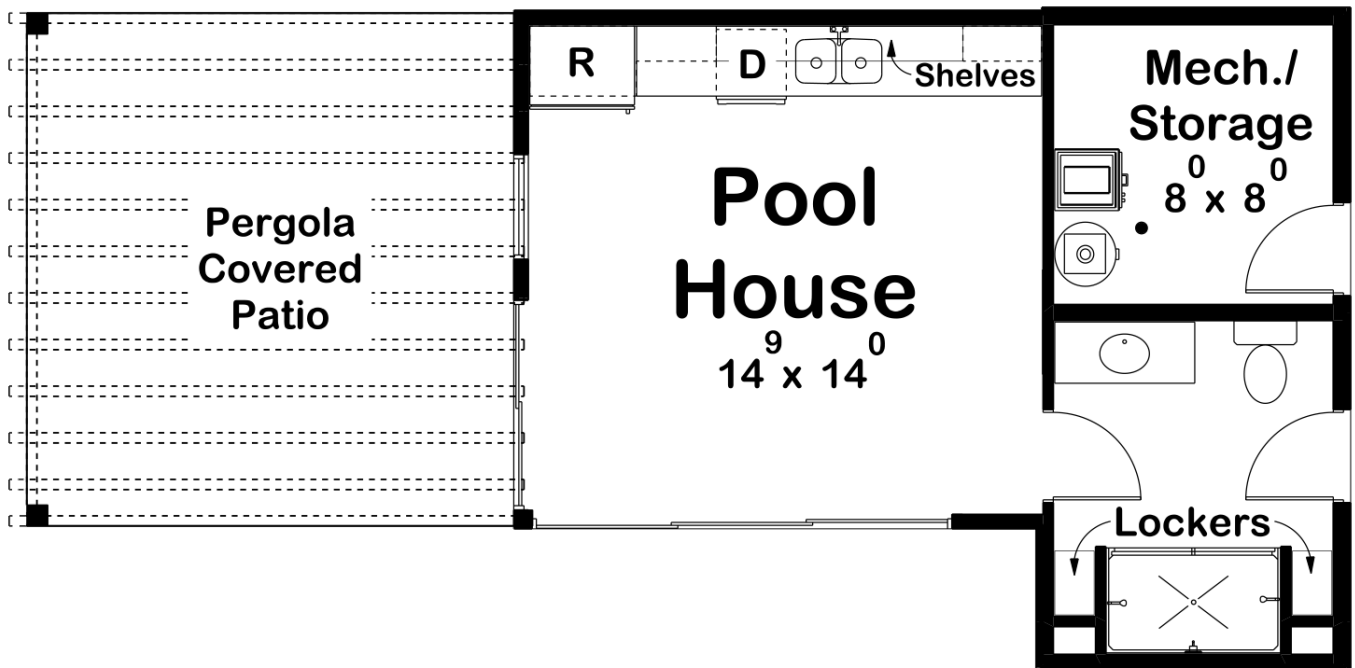

**30256 - Albany Flats Data Sheet**

|              |           |            |           |                |                |
|--------------|-----------|------------|-----------|----------------|----------------|
| 306<br>SQ FT | 0<br>BEDS | 1<br>BATHS | 0<br>BAYS | 37' 8"<br>WIDE | 18' 8"<br>DEEP |
|--------------|-----------|------------|-----------|----------------|----------------|



**Construction Specs**

Layout

Bathrooms

## Square Footage

|                     |             |
|---------------------|-------------|
| Main Level          | 306 Sq. Ft. |
| Covered Area        | 205 Sq. Ft. |
| Total Finished Area | 306 Sq. Ft. |

## Exterior Dimensions

|       |        |
|-------|--------|
| Width | 37' 8" |
| Depth | 18' 8" |

## Default Construction Stats

*Stats are unique to the individual plan.*

|                            |      |
|----------------------------|------|
| Foundation Type            | Slab |
| Exterior Wall Construction | 2x4  |
| Roof Pitches               | Flat |
| Main Wall Height           | 10'  |

## Plan Description

The Albany Flats is not your average pool house. The exterior is so inviting with the clean lines of the glass and pergola joists. The mixture of wood, stone, and stucco makes this bath house pop! You can relax under the connected pergola, or take a step inside to cool off. Inside you will find a large sitting area that is open to a kitchen. Further inside is a bathroom that connects to the outdoors so your pool-goers don't have to come inside the pool house with their wet feet. The bath includes a shower and lockers. This pool house also includes 76 square feet of mechanical and storage space.