

29771



BILLINGS

Post Frame House

MAIN FLOOR: 1392 SQ FT
SECOND FLOOR: 662 SQ FT
TOTAL FINISHED: 2054 SQ FT

EXTERIOR DIMENSIONS
92' - 0" WIDE
34' - 0" DEEP

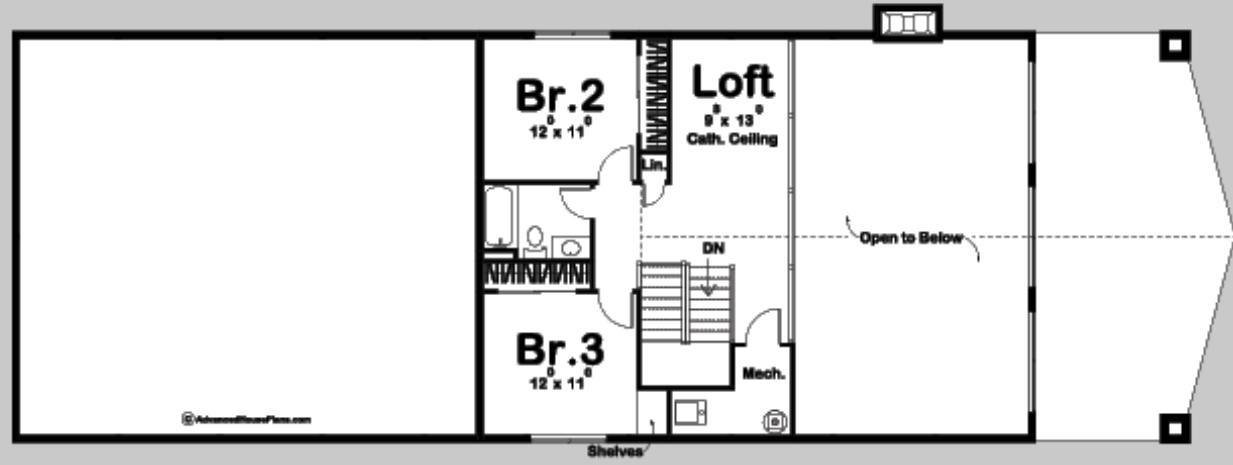
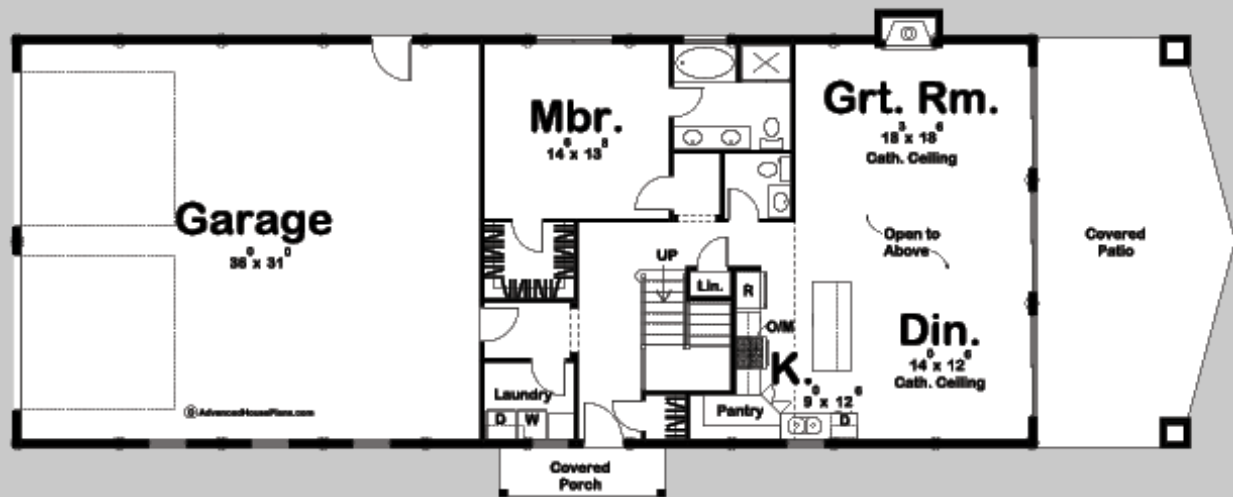

TO ORDER THIS PLAN VISIT WWW.ADVANCEDHOUSEPLANS.COM