

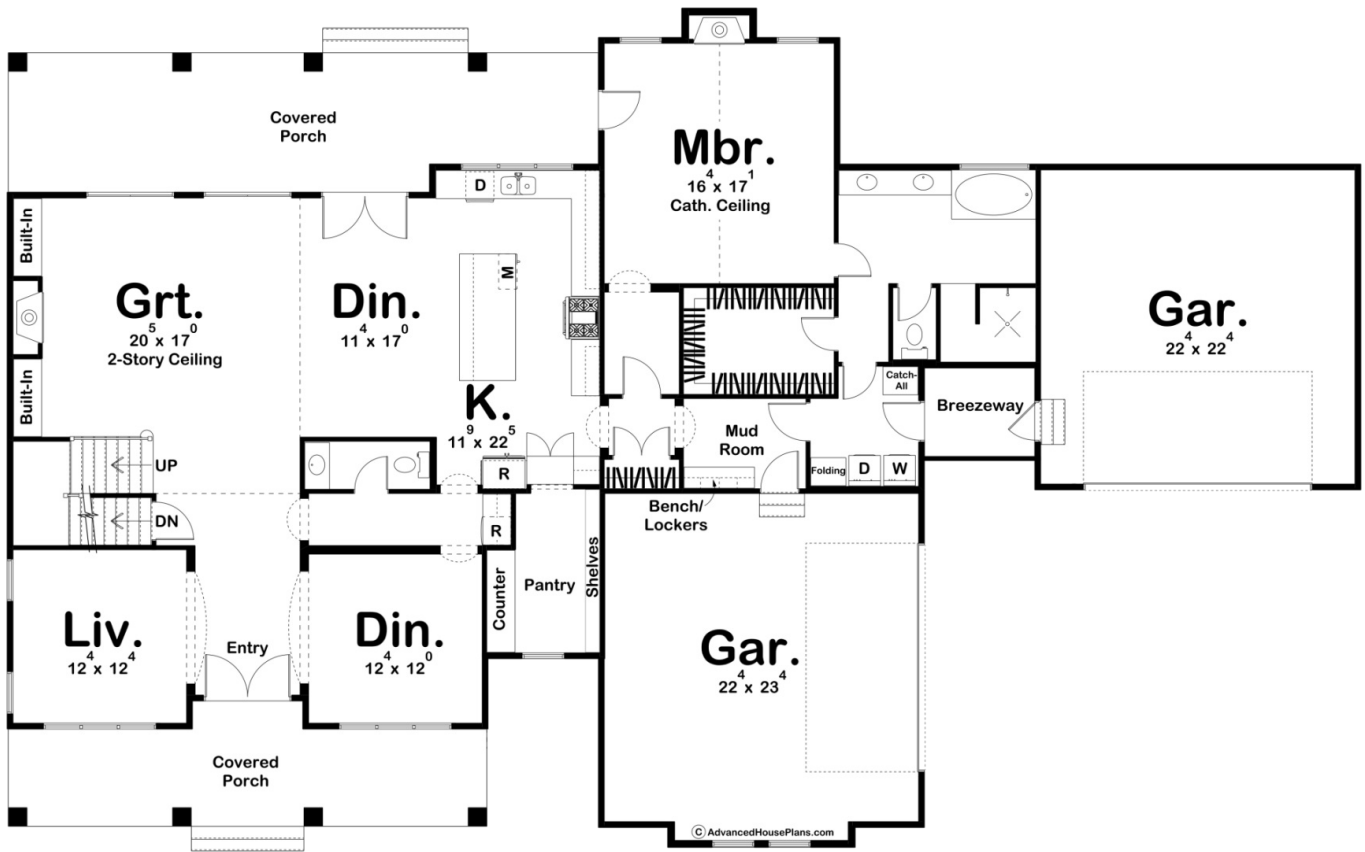

30240 - Wilmington Data Sheet

3243 SQ FT	4 BEDS	4 BATHS	4 BAYS	96' 0" WIDE	59' 4" DEEP
---------------	-----------	------------	-----------	----------------	----------------

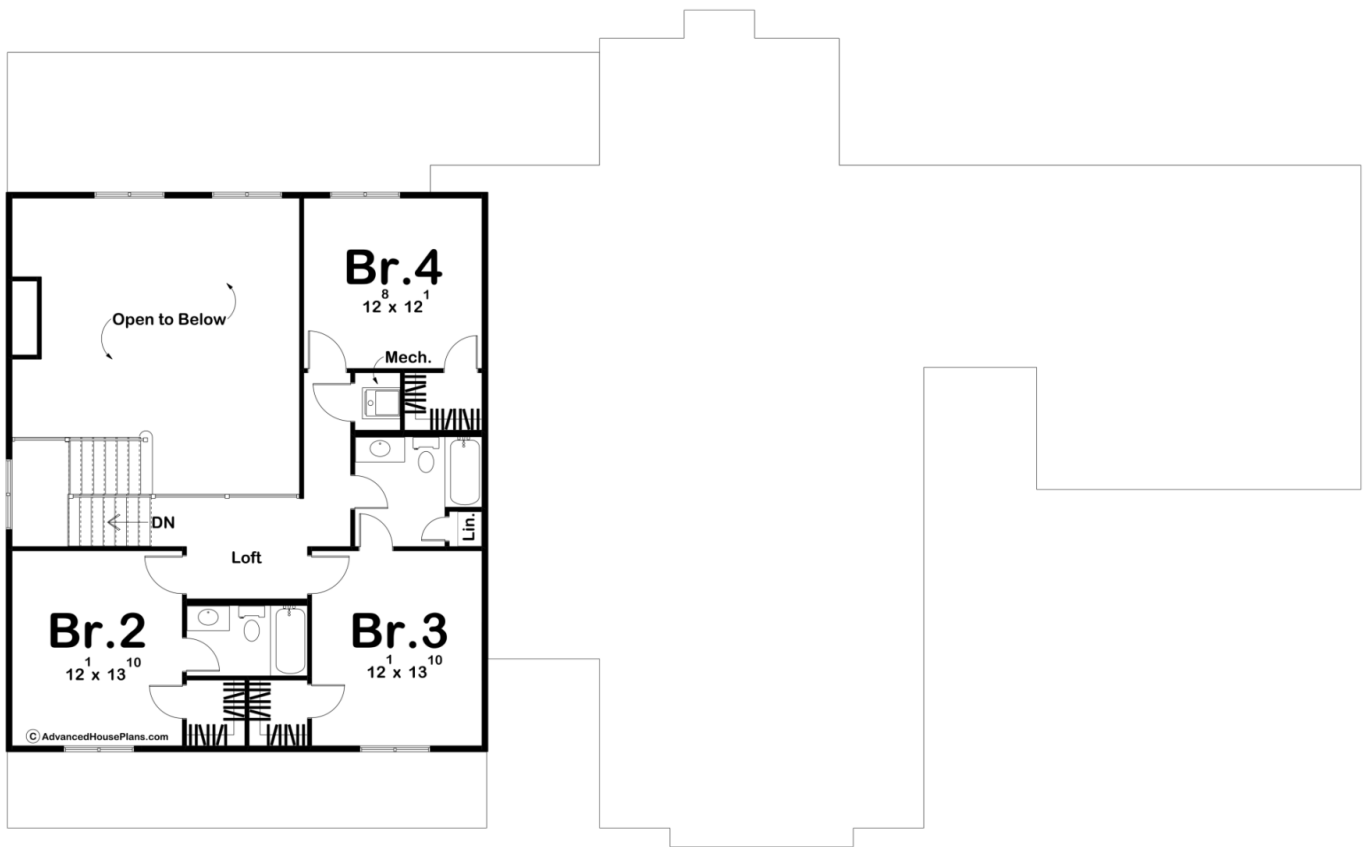



Construction Specs

Layout

Bedrooms	4
Bathrooms	4
Garage Bays	4

Square Footage

Main Level	2377 Sq. Ft.
Second Level	866 Sq. Ft.
Covered Area	703 Sq. Ft.
Garage	1082 Sq. Ft.
Total Finished Area	3243 Sq. Ft.

Exterior Dimensions

Width	96' 0"
Depth	59' 4"

Default Construction Stats

Stats are unique to the individual plan.

Foundation Type	Basement
Exterior Wall Construction	2x4
Roof Pitches	Primary 8/12, Secondary 12/12, 4/12, 3/12, 10/12
Foundation Wall Height	9'
Main Wall Height	9'
Second Wall Height	8'

Plan Description

The Wilmington is a beautiful modern farmhouse with multiple different materials that really make it pop. From wood to brick to board & batten, this house keeps your eyes looking for even more. The wood posts on the large covered porch give this plan a really inviting entry. On the inside you will find an open concept great room, kitchen, and dinette. There is a separate living room and formal dining room at the front of the home. Through the kitchen you will find a mudroom and laundry room that lead to two, two-car garages. One of the garages is accessed by a breezeway with large windows to the ceiling. The master is on the main floor and includes a large walk-in closet and master bath with soaker tub. Upstairs are three additional bedrooms and two baths.