

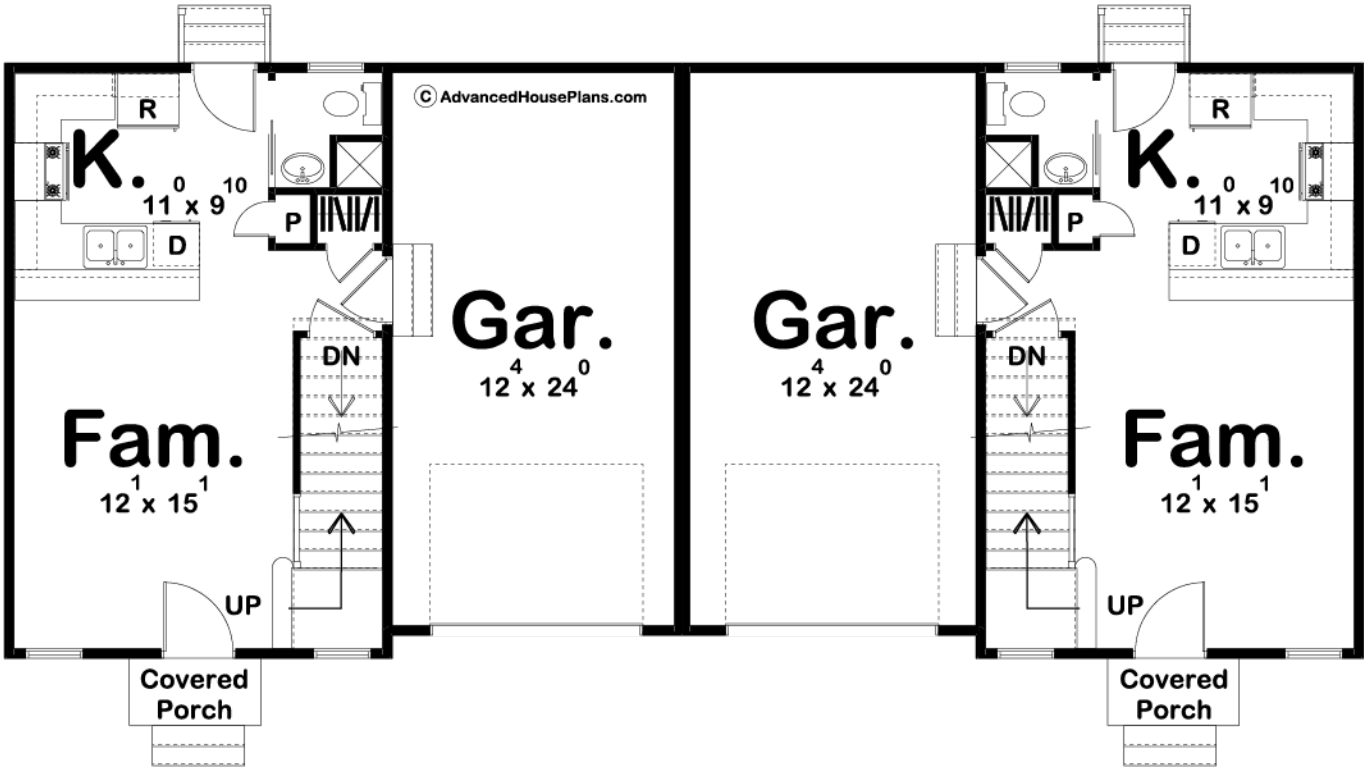

29695 - Whitaker Data Sheet

932 SQ FT	2 BEDS	2 BATHS	1 BAYS	59' 0" WIDE	29' 0" DEEP
--------------	-----------	------------	-----------	----------------	----------------

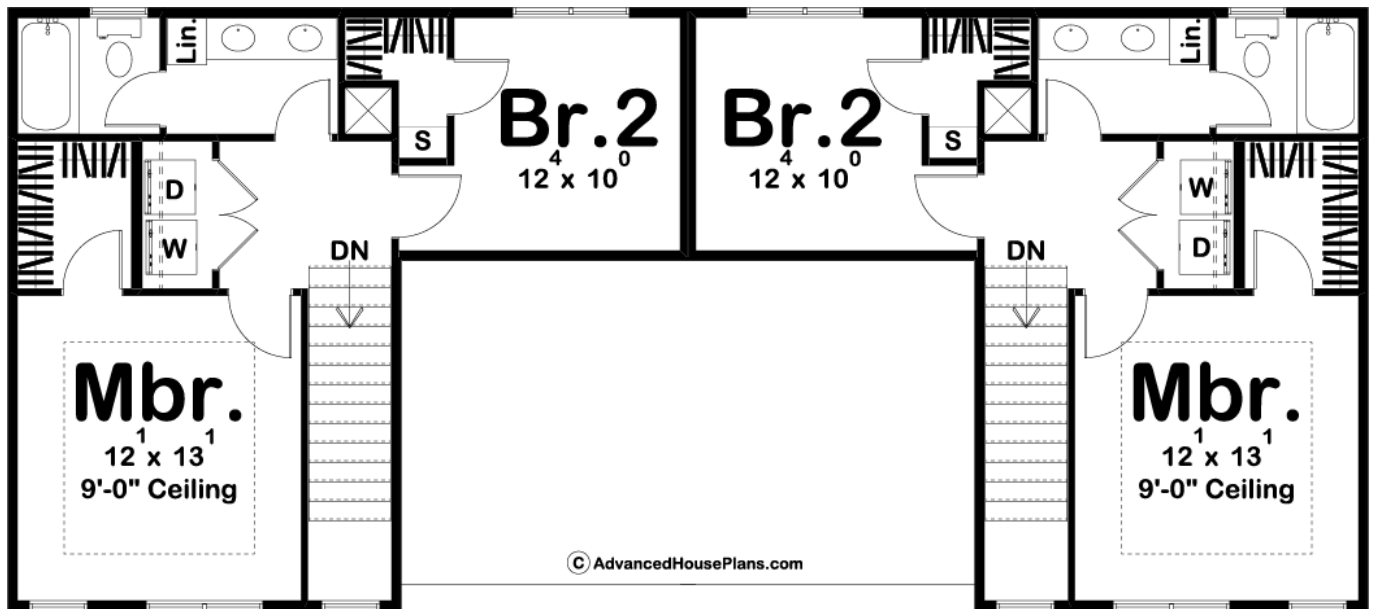



## Construction Specs

### Layout

Bedrooms	2
Bathrooms	2
Garage Bays	1

### Square Footage

Main Level	424 Sq. Ft.
Second Level	508 Sq. Ft.
Garage	312 Sq. Ft.
Total Finished Area	932 Sq. Ft.

### Exterior Dimensions

Width	59' 0"
Depth	29' 0"

### Default Construction Stats

*Stats are unique to the individual plan.*

Foundation Type	Basement
-----------------	----------

Exterior Wall Construction	2x4
Roof Pitches	8/12 Primary, 10/12 Secondary
Foundation Wall Height	9'
Main Wall Height	9'
Second Wall Height	8'

## Plan Description

Perfect for multiple families, the Whitaker plan is super efficient. The exterior of the home showcases the modern farmhouse style with board and batten siding mixed with wood accents. On the Inside, guests are immediately greeted by the family room. The main floor includes a coat closet and a powder bath. The kitchen features a breakfast bar, pantry, and practical counter space. Upstairs, the master bedroom features a sizeable walk-in closet. A wall separates its bath area from the centrally located laundry. Just off the second-floor landing, the bedrooms share a hall bath.