

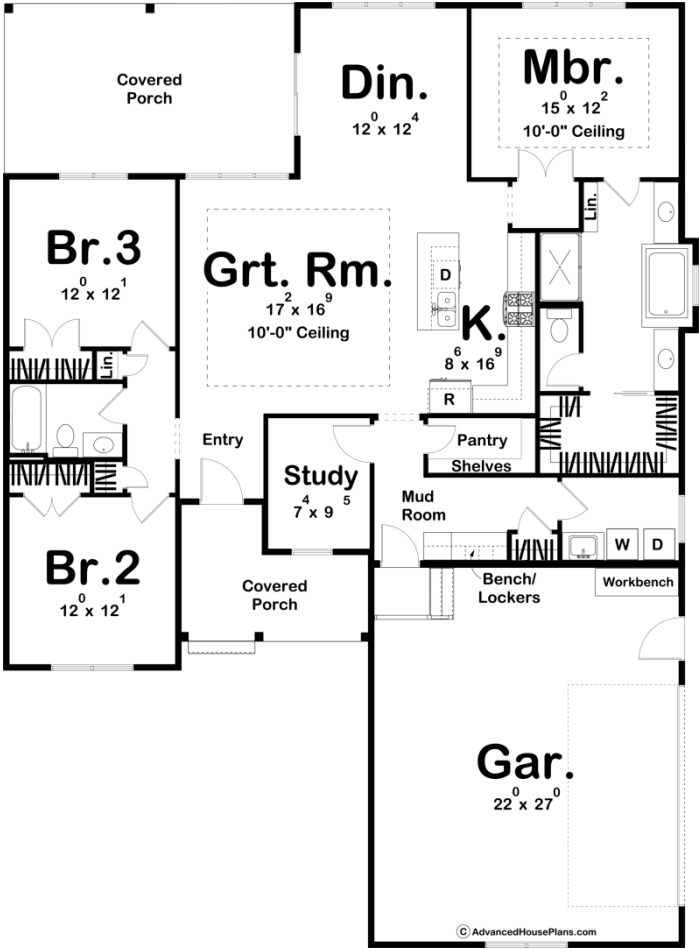

29900 - Trenton Data Sheet

1797 SQ FT	3 BEDS	2 BATHS	2 BAYS	50' 0" WIDE	68' 0" DEEP
---------------	-----------	------------	-----------	----------------	----------------



Construction Specs

Layout
--------

Bedrooms	3
----------	---

Bathrooms	2
Garage Bays	2
<b>Square Footage</b>	
Main Level	1797 Sq. Ft.
Covered Area	364 Sq. Ft.
Garage	616 Sq. Ft.
Total Finished Area	1797 Sq. Ft.
<b>Exterior Dimensions</b>	
Width	50' 0"
Depth	68' 0"
<b>Default Construction Stats</b> <i>Stats are unique to the individual plan.</i>	
Foundation Type	Slab
Exterior Wall Construction	2x4
Roof Pitches	8/12 Primary
Main Wall Height	9'

## Plan Description

An appealing front porch and board and batten siding give this Modern Farmhouse ranch plan unique charm. Inside this affordable house plan, guests are welcomed by a trayed decorative ceiling in the open great room/ kitchen concept. The L-shaped kitchen and island adjoin the dining area, which opens up to a rear covered porch, where guests can mingle before dinner is served. A generously sized master suite is tucked away for privacy behind the kitchen and includes a trayed ceiling. The well-appointed master bath includes a large whirlpool tub, shower, compartmented toilet, and walk-in closet. Two additional bedrooms occupy this 1 story house plan, Bedroom 3 offers a birds-eye view of the covered porch outside. This 1 story house plan also features a 2 car side load garage.