

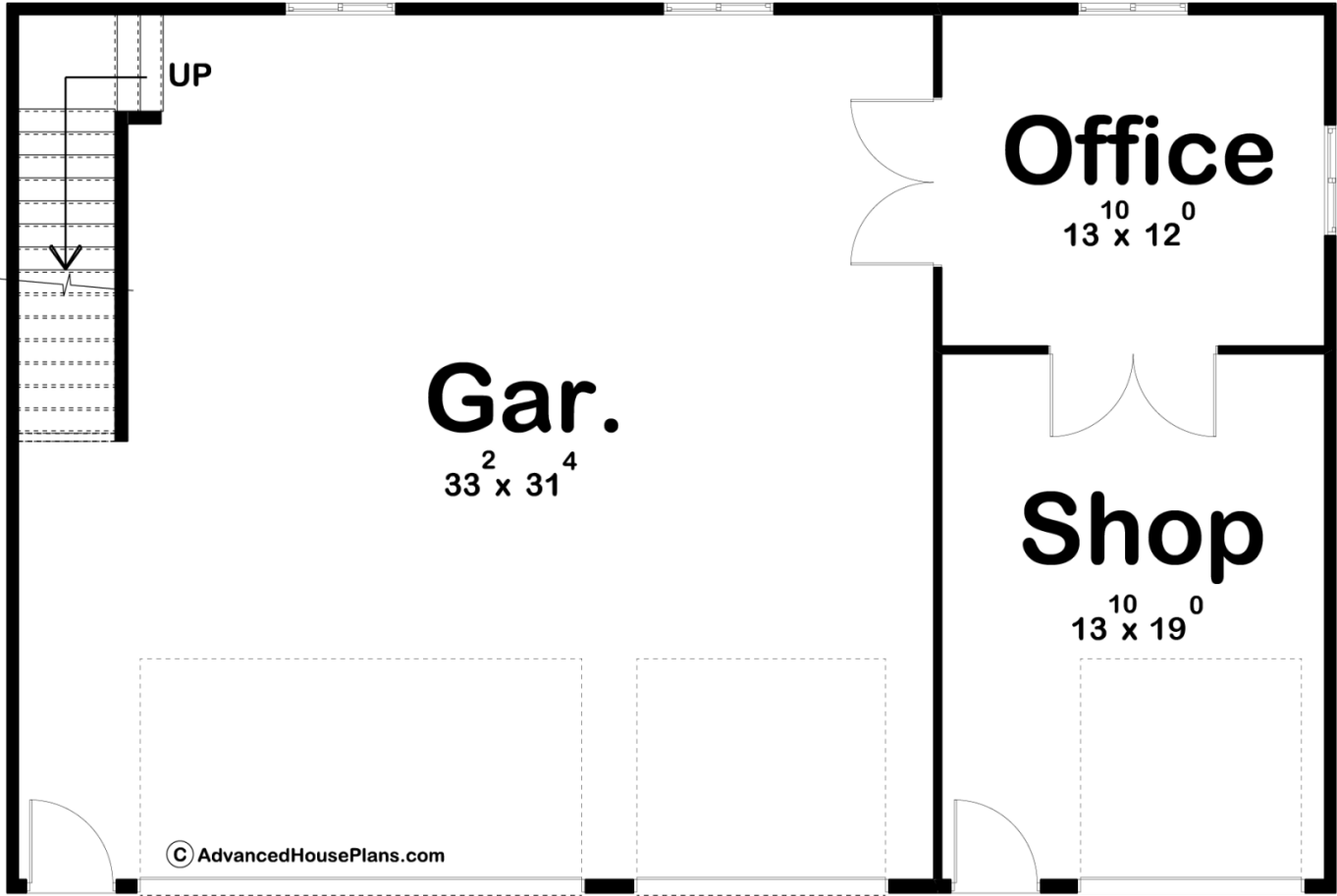

29399 - Stewart Data Sheet

684 SQ FT	0 BEDS	0 BATHS	4 BAYS	48' 0" WIDE	32' 0" DEEP
--------------	-----------	------------	-----------	----------------	----------------

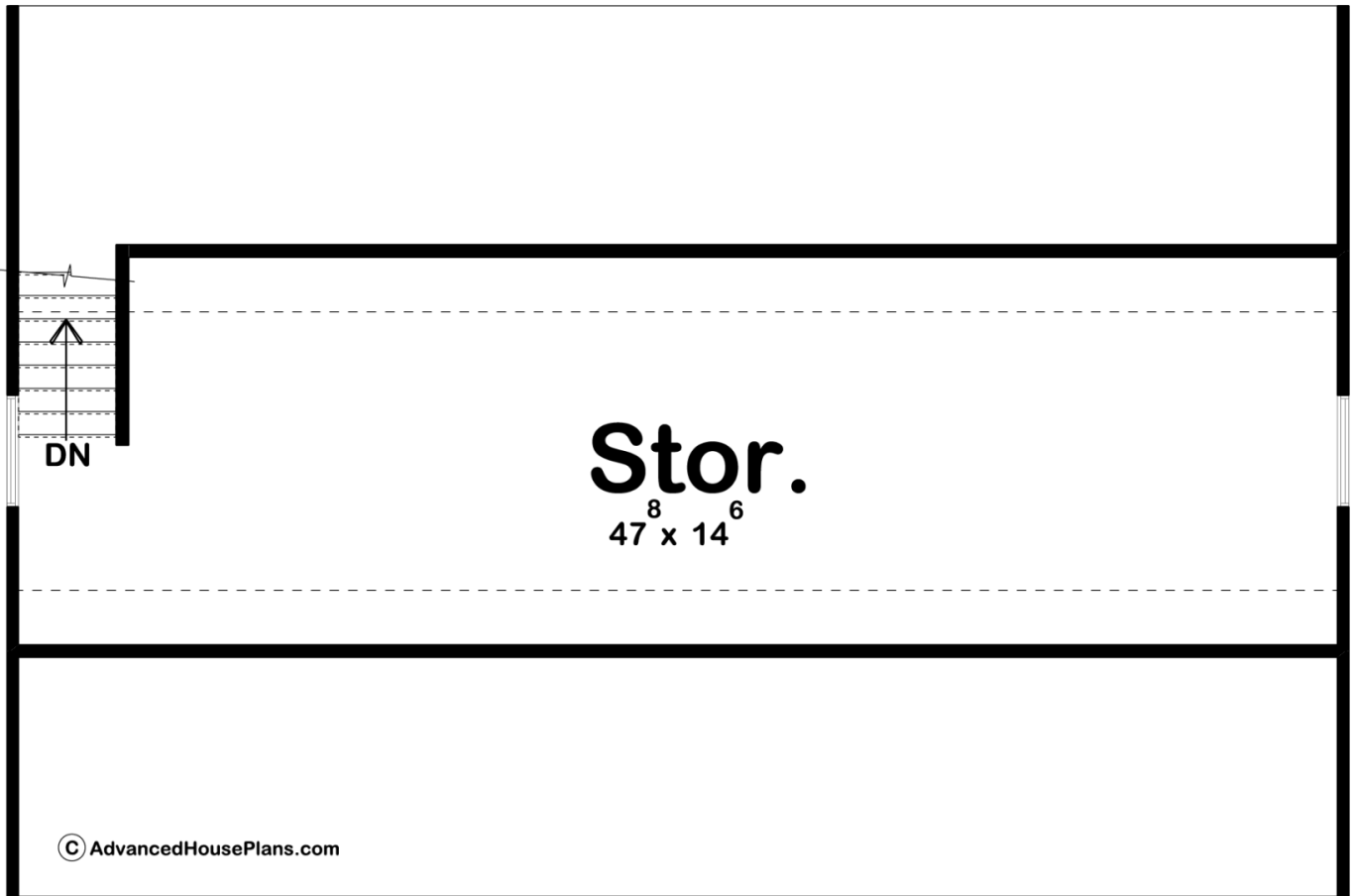



Construction Specs

Layout		
Garage Bays		4
Square Footage		
Second Level		684 Sq. Ft.
Garage		1536 Sq. Ft.
Total Finished Area		684 Sq. Ft.
Exterior Dimensions		
Width		48' 0"
Depth		32' 0"
Default Construction Stats		
Stats are unique to the individual plan.		
Foundation Type		Slab
Exterior Wall Construction		2x4
Roof Pitches		10/12 Primary
Main Wall Height		10'

Plan Description

The Stewart garage is a fantastic Craftsman style garage that includes a few unique features. On the exterior, the wood garage doors and shake siding combine with stone to give this garage a definitive craftsman facade. On the left side, there is a 3 car garage that features a 2 car bay and a 1 car bay. On the right side, there is an amazing shop that leads to an office through a set of french doors. On the second floor, you get a ton of storage space.