

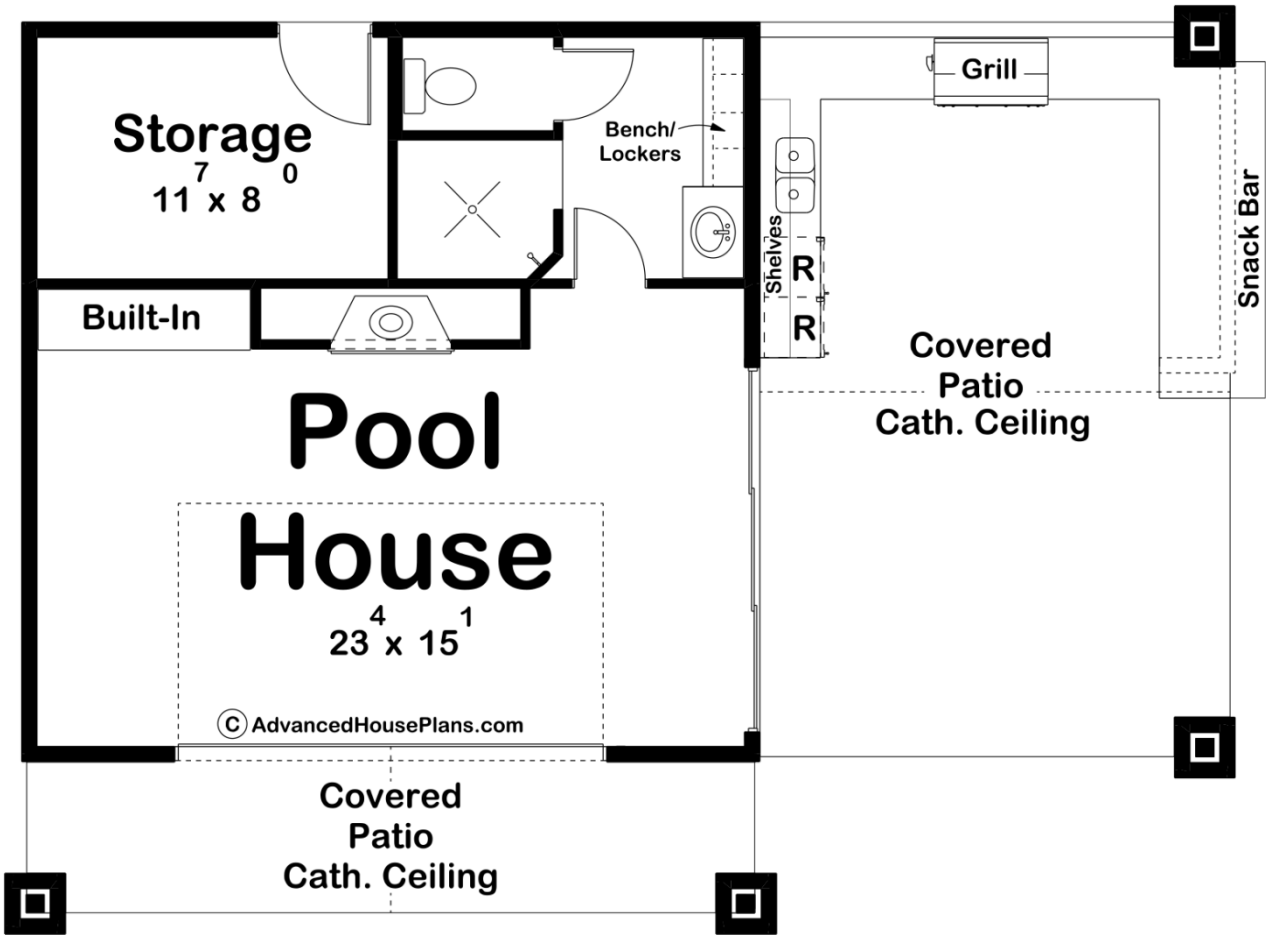

30261 - Steamboat Springs Data Sheet

477 SQ FT	0 BEDS	1 BATHS	0 BAYS	40' 3" WIDE	30' 3" DEEP
--------------	-----------	------------	-----------	----------------	----------------



Construction Specs

Layout

Bathrooms

Square Footage	
Main Level	477 Sq. Ft.
Covered Area	486 Sq. Ft.
Total Finished Area	477 Sq. Ft.
Exterior Dimensions	
Width	40' 3"
Depth	30' 3"
Default Construction Stats	
<i>Stats are unique to the individual plan.</i>	
Foundation Type	Slab
Exterior Wall Construction	2x4
Roof Pitches	6/12 Primary
Main Wall Height	9'

## Plan Description

The Steamboat Springs is a pool house with so much character. The exposed rafters and large decorative gable trusses give this structure amazing curb appeal. Under the large covered porch you will find a kitchen equipped with a built-in grill, a sink, and dual refrigerators. There is a snack bar as well.On the inside you will find a large sitting area with a fireplace and built-ins. There is also a bathroom with a walk-in shower. On the rear side of the pool house is access to a storage room. This is great for pool equipment and toys.