

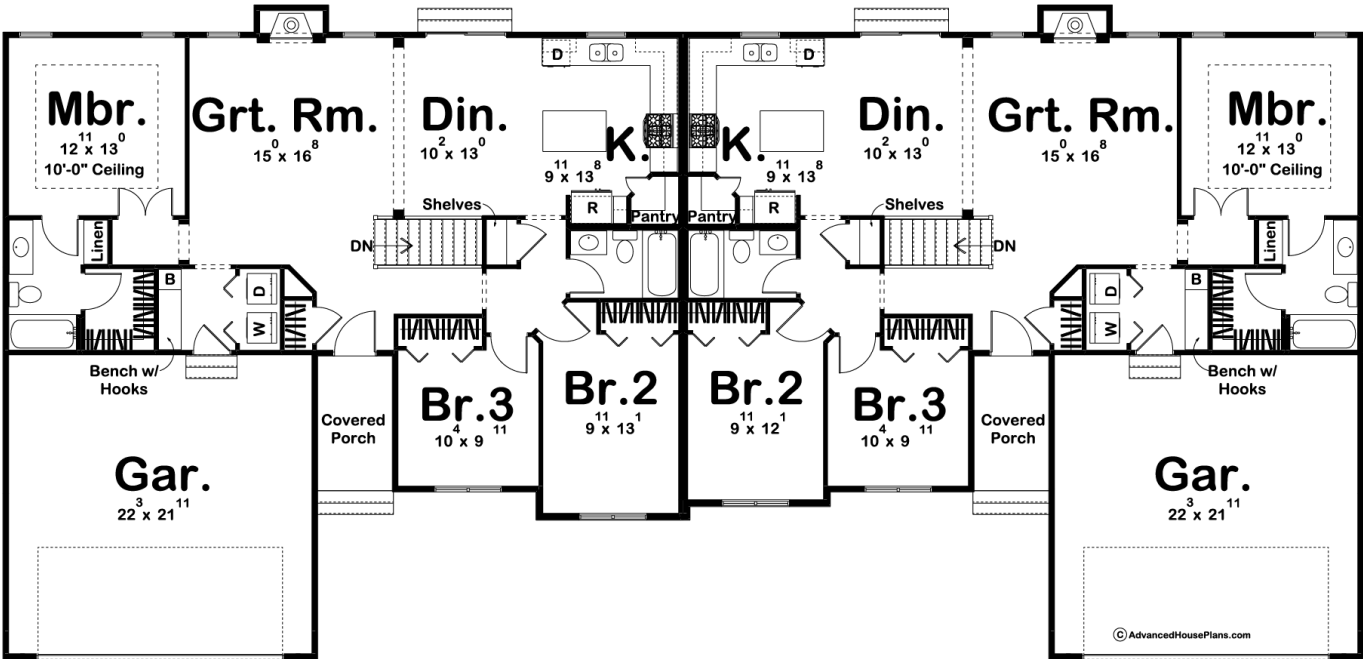

29417 - Springfield Data Sheet

| | | | | | |
|---------------|-----------|------------|-----------|-----------------|----------------|
| 1418 SQ FT | 3 BEDS | 2 BATHS | 2 BAYS | 100' 0" WIDE | 48' 0" DEEP |
|---------------|-----------|------------|-----------|-----------------|----------------|



Construction Specs

| |
|--------|
| Layout |
|--------|

Bedrooms

| | |
|---|--------------|
| Bathrooms | 2 |
| Garage Bays | 2 |
| Square Footage | |
| Main Level | 1418 Sq. Ft. |
| Garage | 514 Sq. Ft. |
| Total Finished Area | 1418 Sq. Ft. |
| Exterior Dimensions | |
| Width | 100' 0" |
| Depth | 48' 0" |
| Default Construction Stats | |
| <i>Stats are unique to the individual plan.</i> | |
| Foundation Type | Basement |
| Exterior Wall Construction | 2x4 |
| Foundation Wall Height | 9' |
| Main Wall Height | 9' |

Plan Description

Springfield is a beautiful multi-family plan with a traditional style. Each 3 bedroom unit has an excellent open floor plan. Once you enter the home you will be greeted by a wonderful great room that is warmed by a fireplace. The kitchen and dining room flow nicely to keep with the open concept. The kitchen includes a large work island and a pantry. The master suite and secondary bedrooms are separated by the homes living space to preserve privacy for the homeowners. The homes 2 car garage accesses the home through a functional mus room complete with a bench.