

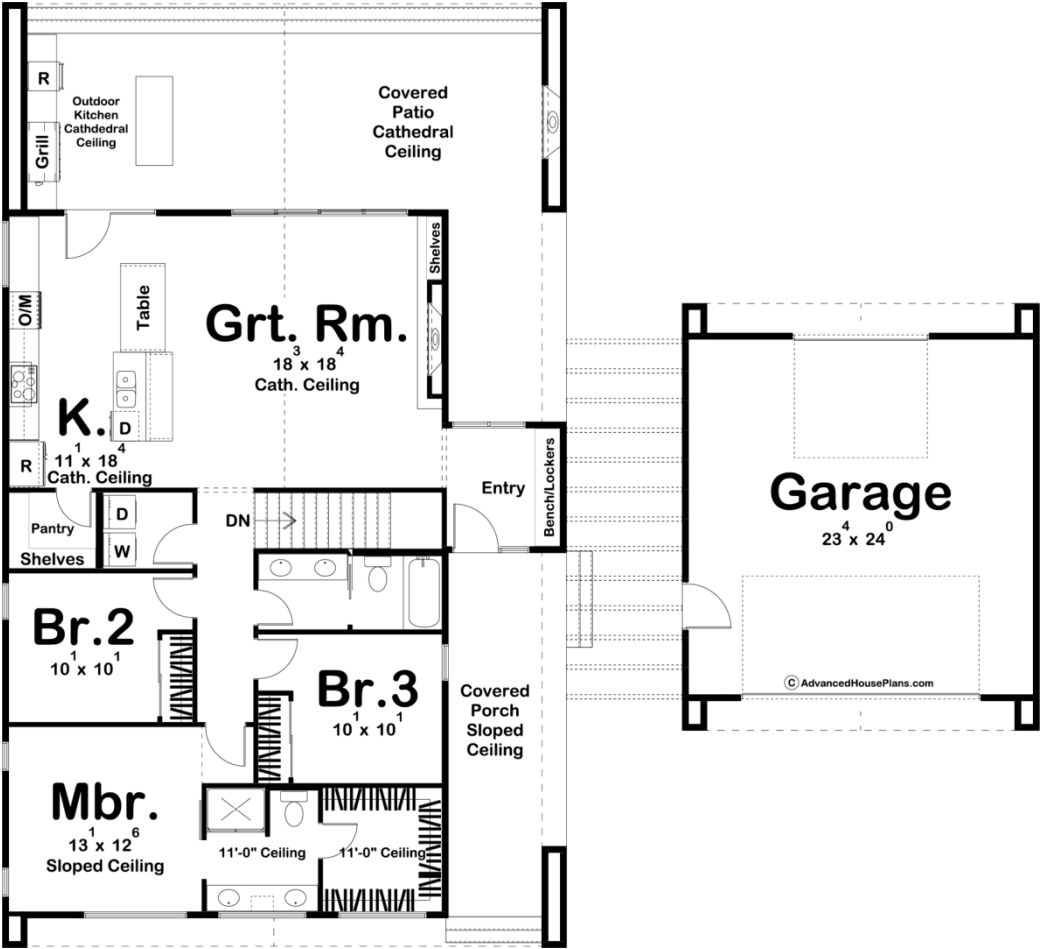

29955 - Santa Cruz Data Sheet

1499 SQ FT	3 BEDS	2 BATHS	2 BAYS	70' 0" WIDE	64' 0" DEEP
---------------	-----------	------------	-----------	----------------	----------------



Construction Specs

Layout

Bedrooms

Bathrooms	2
Garage Bays	2
Square Footage	
Main Level	1499 Sq. Ft.
Covered Area	777 Sq. Ft.
Garage	592 Sq. Ft.
Total Finished Area	1499 Sq. Ft.
Exterior Dimensions	
Width	70' 0"
Depth	64' 0"
Ridge Height <i>Calculated from main floor line</i>	24'
Default Construction Stats <i>Stats are unique to the individual plan.</i>	
Foundation Type	Basement
Exterior Wall Construction	2x4
Roof Pitches	8/12 Primary
Foundation Wall Height	9'
Main Wall Height	9'

Plan Description

The Santa Cruz plan is a beautiful ultra-modern style house plan. The exterior combines white stucco and large overhangs with a modern covered porch. Just inside the covered front porch, you'll notice a wide-open floor plan. The kitchen, and great room flow seamlessly together. The kitchen includes a wonderful island with a built-in dining room table and a walk-in pantry. The great room is warmed by a fireplace that is flanked by built-in bookshelves and lies under a soaring cathedral ceiling. Large sliding glass doors lead to a large covered patio with an amazing outdoor kitchen. On the main floor, you'll find 3 bedrooms including the master suite. The master bathroom includes his/her vanities, a walk-in shower, and a walk-in closet. Bedrooms 2 and 3 share a centrally located hall bathroom with double vanities. The home's pull through 2 car garage accesses the home through a convenient mudroom.